



# MASTER LEDspot LV AR111

## MAS LEDspotLV D 15-75W 927 AR111 24D

Delivering a warm, halogen-like accent beam, MASTER LEDspot LV AR111 is an ideal retrofit solution for spot and general lighting applications in the hospitality and retail industry. It is particularly suitable for general lighting where the light is on all the time, such as creative accent lighting applications in shops, restaurants, hotels, and especially for galleries, exhibitions and museums. The robustly designed MASTER LEDspot LV AR111 offers various beam angles for a clearly defined beam spread. There is no UV or IR in the beam, making it suitable for illuminating heat-sensitive objects (food, organic materials, paintings, etc.). The patented intelligent driver enables broad compatibility with existing electromagnetic and electronic halogen transformers. MASTER LEDspot LV AR111 delivers huge energy savings and minimises maintenance cost without any reduction in brightness.

### Product data

General Information			
Cap base	G53 [ G53]	Luminous efficacy (rated) (nom.)	53.33 lm/W
EU RoHS compliant	Yes	Colour consistency	<3
Nominal lifetime (nom.)	40000 h	Color rendering index (nom.)	90
Switching cycle	50,000X	LLMF at end of nominal lifetime (nom.)	70 %
Technical type	15-75W	Luminous Flux in 90° Cone (Rated)	800 lm
Light Technical		Operating and Electrical	
Colour code	927	Input frequency	- Hz
Beam Angle (Nom)	24 °	Power (Rated) (Nom)	15 W
Luminous flux (nom.)	800 lm	Lamp current (nom.)	1800 mA
Luminous intensity (nom.)	3900 cd	Wattage equivalent	75 W
Colour designation	Warm white (WW)	Starting time (nom.)	0.5 s
Correlated Colour Temperature (Nom)	2700 K	Warm-up time to 60% light (nom.)	0.5 s
		Power factor (nom.)	0.7

# MASTER LEDspot LV AR111

Voltage (Nom)	12 V
<b>Temperature</b>	
T-Case maximum (nom.)	74 °C
<b>Controls and Dimming</b>	
Dimmable	Yes
<b>Approval and Application</b>	
Energy efficiency label (EEL)	A
Suitable for accent lighting	Yes
Energy Consumption kWh/1000 h	17 kWh

## Dimensional drawing

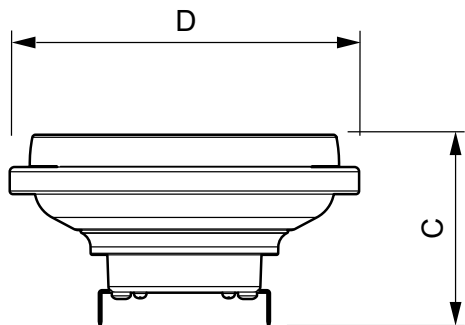

LED D 15-75W 927 AR111 24D

## Photometric data

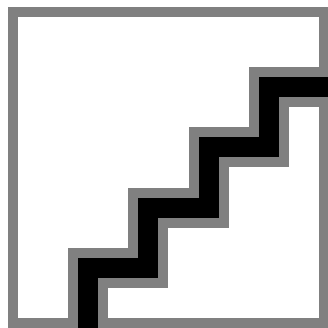

MASTER LEDspot LV AR111 75W G53 927 24D

<b>Product Data</b>	
Full product code	871869651496200
Order product name	MAS LEDspotLV D 15-75W 927 AR111 24D
EAN/UPC – product	8718696514962
Order code	51496200
Local Code	MLED15AR112724N
Numerator – quantity per pack	1
Numerator – packs per outer box	6
Material no. (12NC)	929001170202
Net weight (piece)	0.160 kg

<b>Product</b>
MAS LEDspotLV D 15-75W 927 AR111 24D

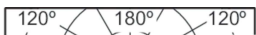

MASTER LEDspot LV AR111

Photometric data

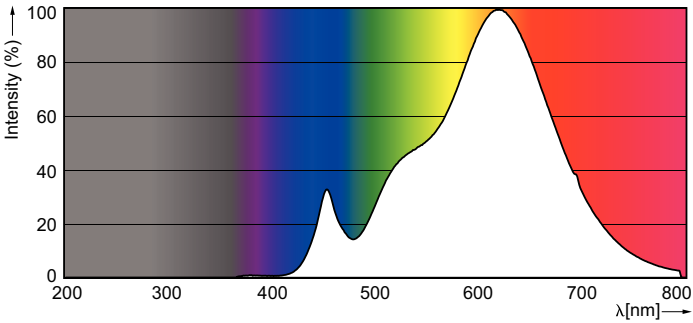

SDPO\_LEDspotL\_0027-Spectral Power distribution

Lifetime

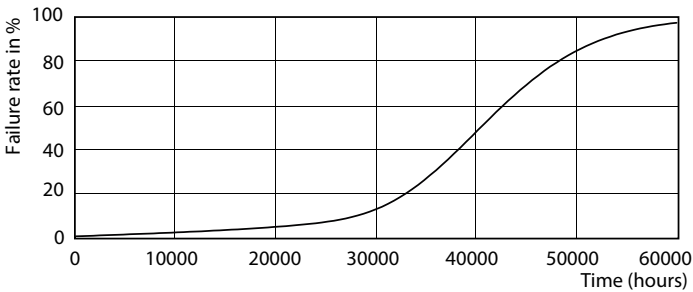

MASTER LEDspotLV AR111 75W G53 940 40D

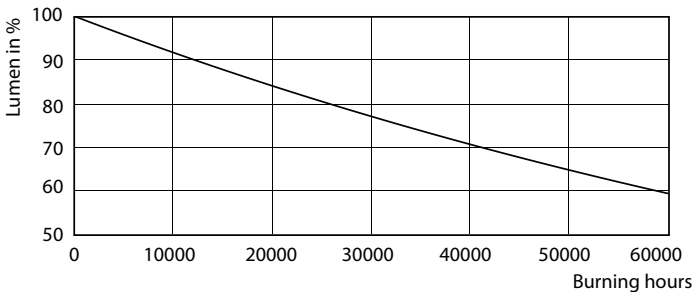

MASTER LEDspotLV AR111 75W G53 940 40D

