



# MASTER LEDspot LV AR111

## MAS LEDspotLV D 20-100W 830 AR111 40D

Delivering a warm, halogen-like accent beam, MASTER LEDspot LV AR111 is an ideal retrofit solution for spot and general lighting applications in the hospitality and retail industry. It is particularly suitable for general lighting where the light is on all the time, such as creative accent lighting applications in shops, restaurants, hotels, and especially for galleries, exhibitions and museums. The robustly designed MASTER LEDspot LV AR111 offers various beam angles for a clearly defined beam spread. There is no UV or IR in the beam, making it suitable for illuminating heat-sensitive objects (food, organic materials, paintings, etc.). The patented intelligent driver enables broad compatibility with existing electromagnetic and electronic halogen transformers. MASTER LEDspot LV AR111 delivers huge energy savings and minimises maintenance cost without any reduction in brightness.

### Product data

General Information		Luminous Efficacy (rated) (Nom)	
Cap-Base	G53 [G53]	67.50 lm/W	
Nominal lifetime	25,000 hour(s)	Color Consistency	<6
Switching Cycle	50,000	Color rendering index (CRI)	80
Lighting Technology	LED	LLMF At End Of Nominal Lifetime (Nom)	70 %
EU RoHS compliant	Yes	Operating and Electrical	
Light Technical		Line Frequency	- Hz
Color Code	830 [CCT of 3000K]	Input Frequency	- Hz
Beam Angle (Nom)	40 degree(s)	Power Consumption	20 W
Luminous Flux	1,350 lm	Lamp Current (Nom)	2,400 mA
Luminous Intensity (Nom)	2,350 cd	Wattage Equivalent	100 W
Color Designation	White (WH)	Starting Time (Nom)	0.5 s
Correlated Color Temperature (Nom)	3000 K	Warm-up time to 60% light	instant full light s
		Power Factor (Fraction)	0.7

# MASTER LEDspot LV AR111

Voltage (Nom)	12 V
<b>Temperature</b>	
T-Case Maximum (Nom)	80 °C
<b>Controls and Dimming</b>	
Dimmable	Yes
<b>Mechanical and Housing</b>	
Bulb Shape	AR111
<b>Approval and Application</b>	
Suitable For Accent Lighting	Yes
Energy Consumption kWh/1000 h	22 kWh

## Dimensional drawing

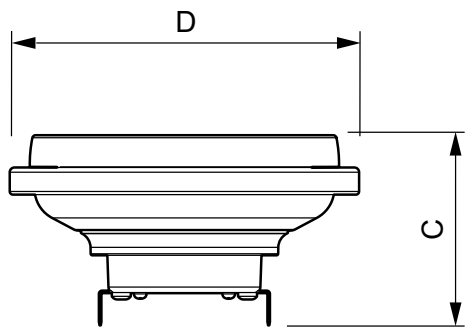
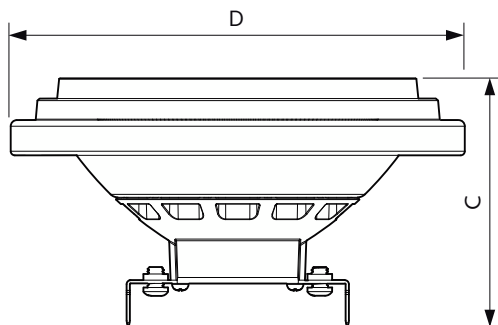

<b>Product Data</b>	
Order product name	MAS LEDspotLV D 20-100W 830 AR111 40D
Full product name	MAS LEDspotLV D 20-100W 830 AR111 40D
Full product code	871869651528000
Order code	929001171208
Material Nr. (12NC)	929001171208
Numerator - Quantity Per Pack	1
EAN/UPC - Product/Case	8718696515280
Numerator - Packs per outer box	6
EAN/UPC - Case	8718696515297

Product	D	C
MAS LEDspotLV D 20-100W 830 AR111 40D	111 mm	62 mm

Product
MAS LEDspotLV D 20-100W 830 AR111 40D

MASTER LEDspot LV AR111

Photometric data

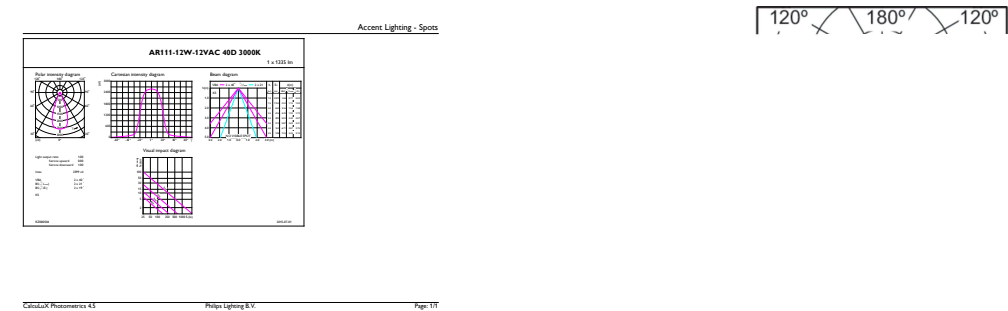

Accent Lighting Spots - MAS LEDspotLV D 20-100W 830 AR111 40D

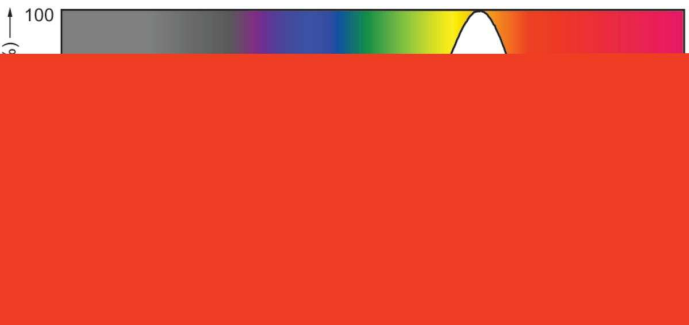

Spectral Power Distribution Colour - MAS LEDspotLV D 20-100W 830 AR111 40D

Lifetime

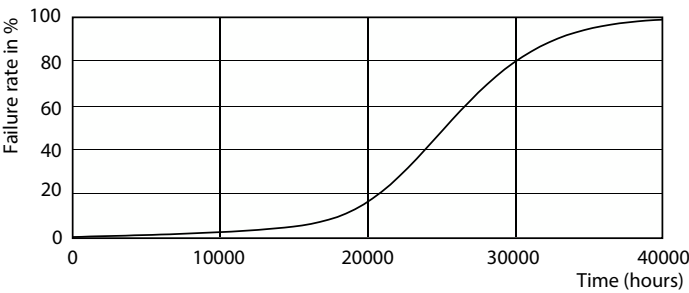

Life Expectancy Diagram - MAS LEDspotLV D 20-100W 830 AR111 40D

Light Distribution Diagram - MAS LEDspotLV D 20-100W 830 AR111 40D

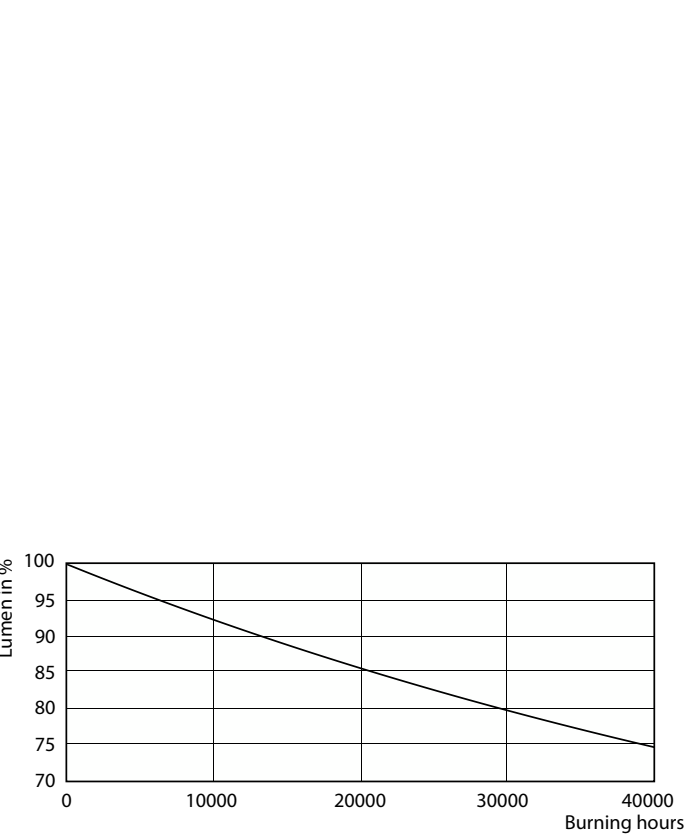

Lumen Maintenance Diagram - MAS LEDspotLV D 20-100W 830 AR111 40D

## MASTER LEDspot LV AR111

