



Date: _____ Type: _____

Firm Name: _____

Project: _____

PDS-60 24V Pre-programmed

Power / data supply for indoor and outdoor applications



For device mounting and maintenance details, refer to the Installation Instructions included in the product packaging, or download documentation from www.colorkinetics.com/ls/pds/pds60/

PDS-60 24 V Pre-programmed is a versatile power / data supply designed for indoor and outdoor LED lighting installations using fixtures from Philips Color Kinetics.

In runs with multiple power / data supplies, PDS-60 24 V Pre-programmed functions as a master control unit, delivering data to the other power / data supplies in the run. Therefore, you use one PDS-60 24 V Pre-programmed unit per run, and standard PDS-60 24 V DMX / Ethernet units for all additional power / data supplies.

PDS-60 24 V delivers 62 watts of power output and accommodates input voltages ranging from 100 VAC to 240 VAC. Short-circuit protection prevents device failure due to incorrectly wired fixtures.

PDS-60 24 V Pre-programmed features built-in visual effects, allowing configurations without Ethernet or DMX controllers.

Featuring a NEMA 4 (IP66) enclosure, PDS-60 24 V Pre-programmed installs in dry, damp, and wet locations.

PDS-60 24 V Pre-programmed offers multiple standard-size conduit entries to accommodate 1/2 in (13 mm) and 3/4 in (19 mm) trade-sized conduit.

Compatible Fixtures

Fixture	Max. Quantity Per PDS-60 24 V
ColorBlast® 6	2
ColorBlast 12	1
ColorBurst® 6	2
C-Splash™ 2	2

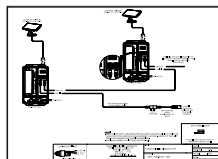

PDS-60 24 V wiring diagrams are available online at www.colorkinetics.com/support/wiring/

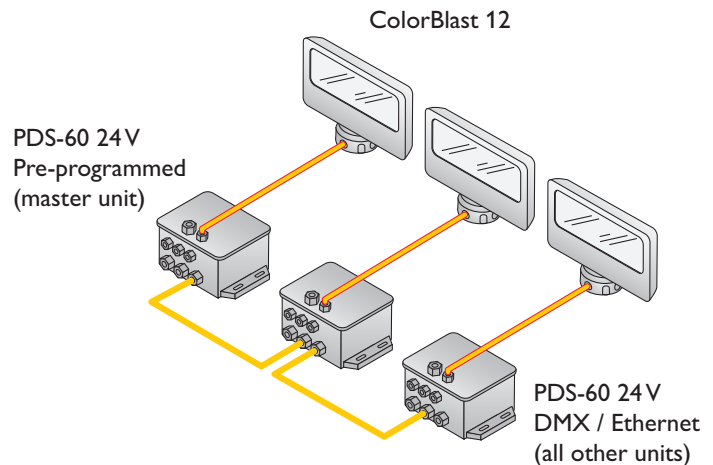

PHILIPS

Specifications

Due to continuous improvements and innovations, specifications may change without notice.

Item	Specification	Details
Electrical	Input Voltage	100 – 240 VAC, auto-switching, 50 / 60 Hz
	Maximum Input Current	1.7 A at 100 VAC, 1.5 A at 120 VAC, .75 A at 240 VAC
	Power Output	24 VDC, 62 W maximum
	Fuse Rating	(2) 4 A, 5 x 20 fast blow fuses
Physical	Dimensions (Height x Width x Depth)	3.6 x 5.5 x 8.8 in (91 x 140 x 224 mm)
	Weight	4.5 lb (2.0 kg)
	Construction	Cast aluminum enclosure with slots for surface mounting
	Finish	Gray matte
	Connectors	Data RJ-45 input and output connectors
		Power / Data Output 3-pin terminal block
		Power Input Line-neutral-ground cable, flying leads
	Temperature Ranges	14° – 104° F (-10° – 40° C) Operating
		14° – 122° F (-10° – 50° C) Startup
		-40° – 176° F (-40° – 80° C) Storage
	Humidity	0 – 95%, non-condensing
	Cooling	Convection
	Heat Dissipation	25% of total power input at maximum load
	Data Input Source	Internal
Certification and Safety	Certification	UL / cUL, CE, PSE
	Classification	UL Class 2 power supply
	Environment	Dry / Damp / Wet Location, IP66

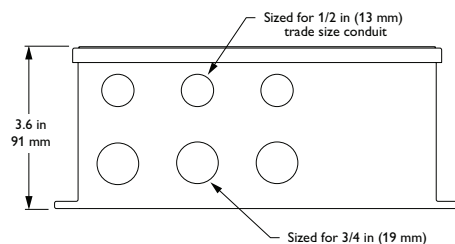
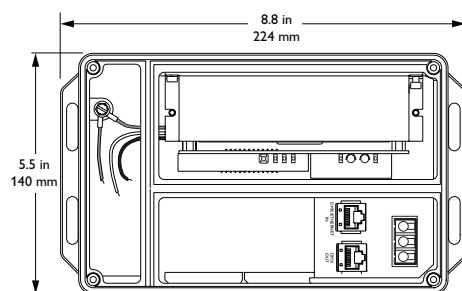

Overall Dimensions

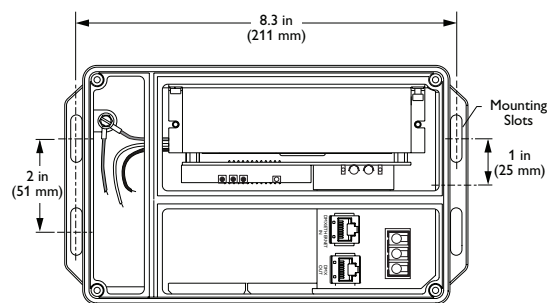

Mounting Dimensions

Ordering Information

Item	Included Components	Item Number	Philips 12NC
PDS-60 24 V Pre-programmed	Power / data supply, (3) EMI suppression cores, (2) spare fuses, (8) NPT threaded seal plugs, and Installation Instructions	109-000017-00	910503700096

Use Item Number when ordering in North America.

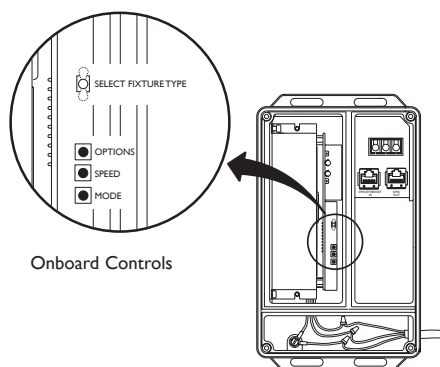

Onboard Controls

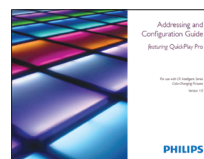
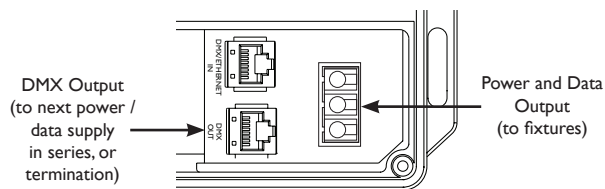

For complete instructions on configuring the PDS-60 24V Pre-programmed for use in an Ethernet or DMX environment, or using pre-configured controls, refer to the *Addressing and Configuration Guide* available online at www.colorkinetics.com/support/addressing/



Philips Color Kinetics
3 Burlington Woods Drive
Burlington, Massachusetts 01803 USA
Tel 888.385.5742
Tel 617.423.9999
Fax 617.423.9998
www.philipscolorkinetics.com

Copyright © 2009 – 2010 Philips Solid-State Lighting Solutions, Inc. All rights reserved. Chromacore, Chromasic, CK, the CK logo, Color Kinetics, the Color Kinetics logo, ColorBlast, ColorBlaze, ColorBurst, eW Fuse, ColorGraze, ColorPlay, ColorReach, iW Reach, eW Reach, DiMand, EssentialWhite, eW, iColor, iColor Cove, IntelliWhite, iW, iPlayer, Optibin, and Powercore are either registered trademarks or trademarks of Philips Solid-State Lighting Solutions, Inc. in the United States and / or other countries. All other brand or product names are trademarks or registered trademarks of their respective owners. Due to continuous improvements and innovations, specifications may change without notice.

DAS-000059-02 R01 12-10