

Coreline Wall-mounted WL120V

Mounting instructions

Instructions de montage

Montageanleitung

Montage instructie

Istruzioni di montaggio

Instrucciones de montaje

Instruções de montagem

Monteringsinstruktioner

Monteringsvejledning

Kokoonpano- ja kiinnitysohjeet

Montaj yönergesi

ΟδηγίεςX τφξασνομόηθηX

Instrukcja montazu

Szerelési utasítások

Návod k montáži

bycñherwbz gj vjynf.e

Návod k montáži

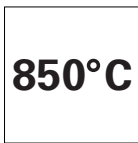
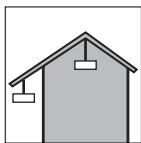
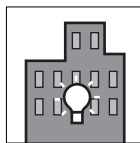

	Flux(Lm)	CCT	P(W)	kg	↑	←	IP..	IK..
WL120V LED16S / PSR	1600	3000K / 4000K	24	1.65	max. 25 °C -20 °C	max. 35 °C -20 °C	65	10
WL120V LED16S / PSR MDU		3000K / 4000K	24	1.75				
WL120V LED12S / PSR	1200	3000K / 4000K	18	1.65				
WL120V LED12S / PSR MDU		3000K / 4000K	18	1.75				

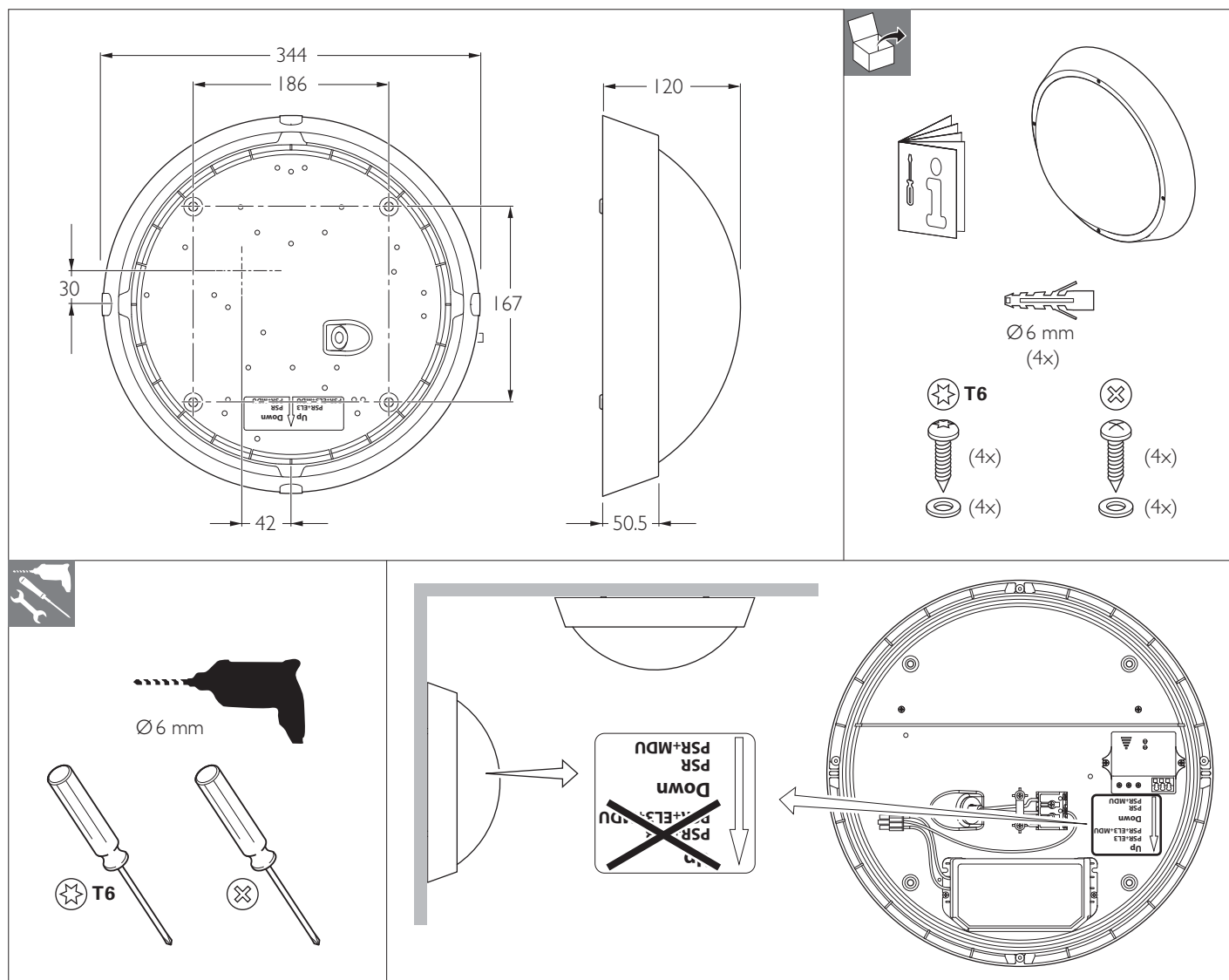

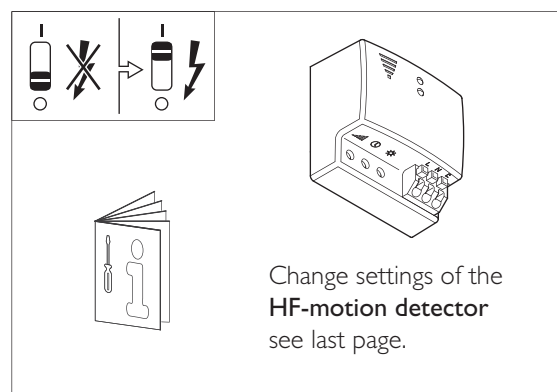
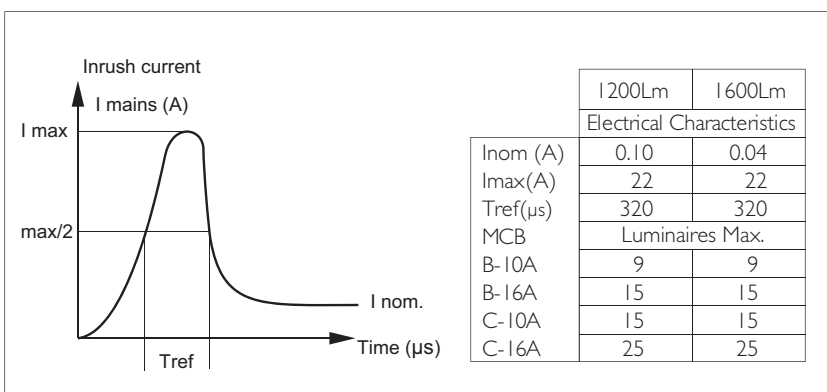
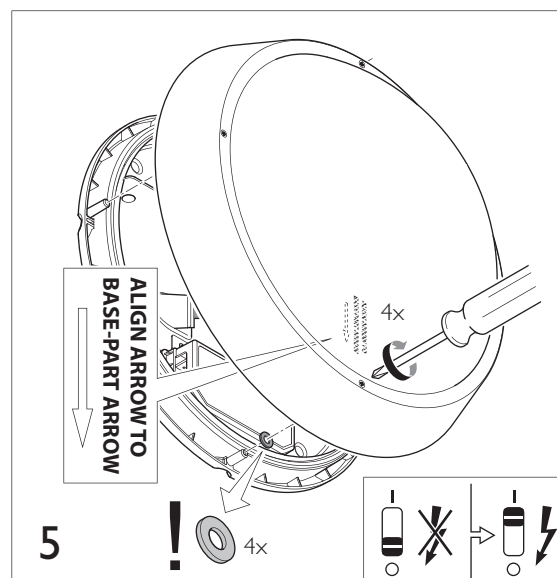
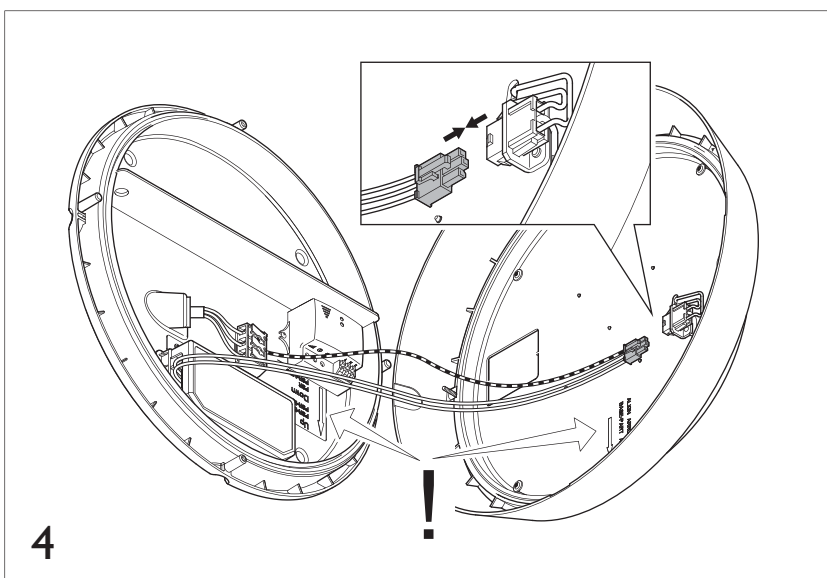
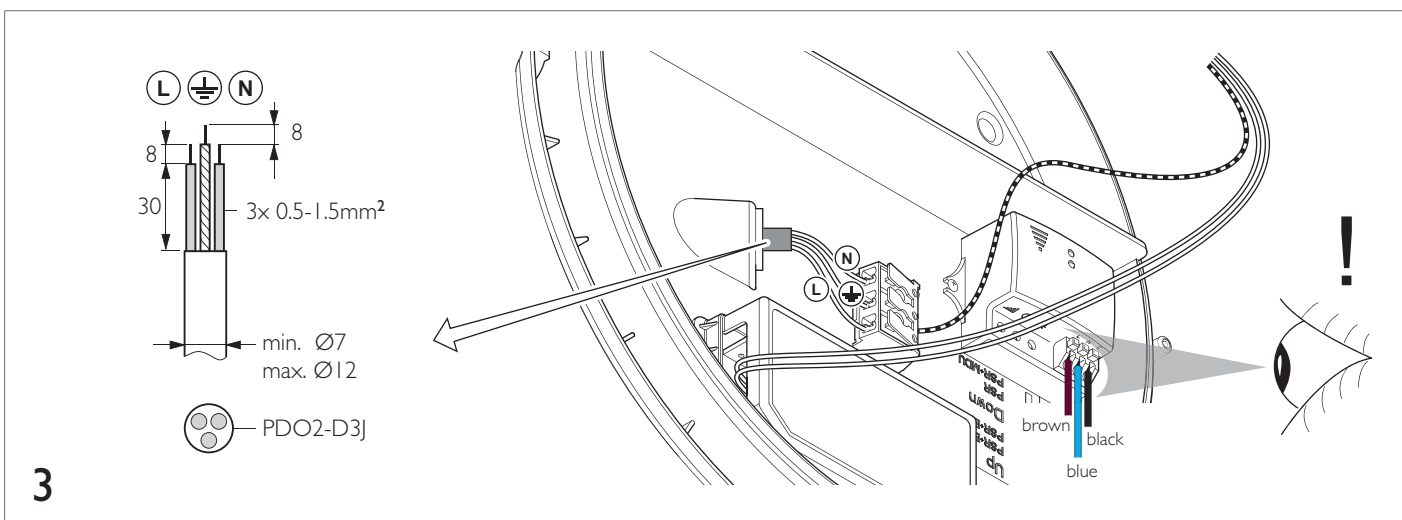
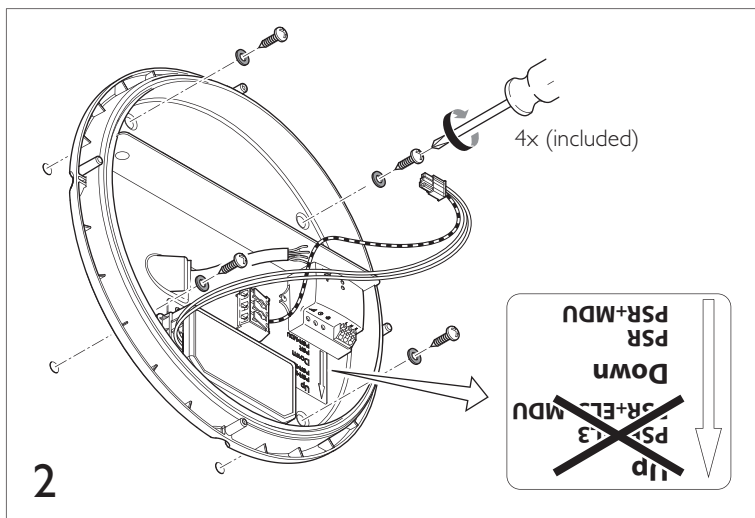
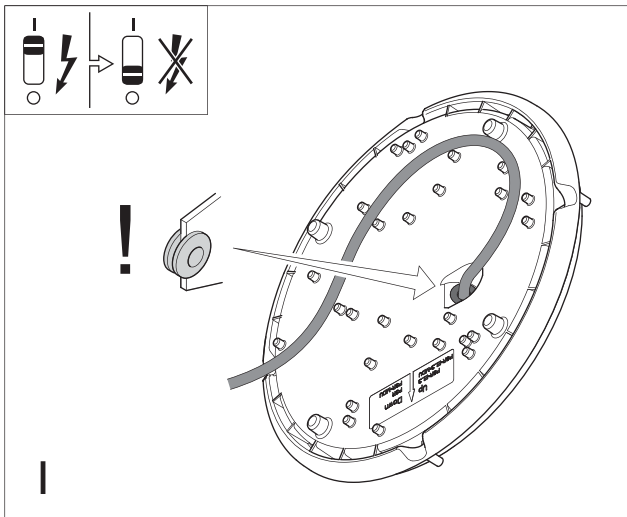

Replacement Driver

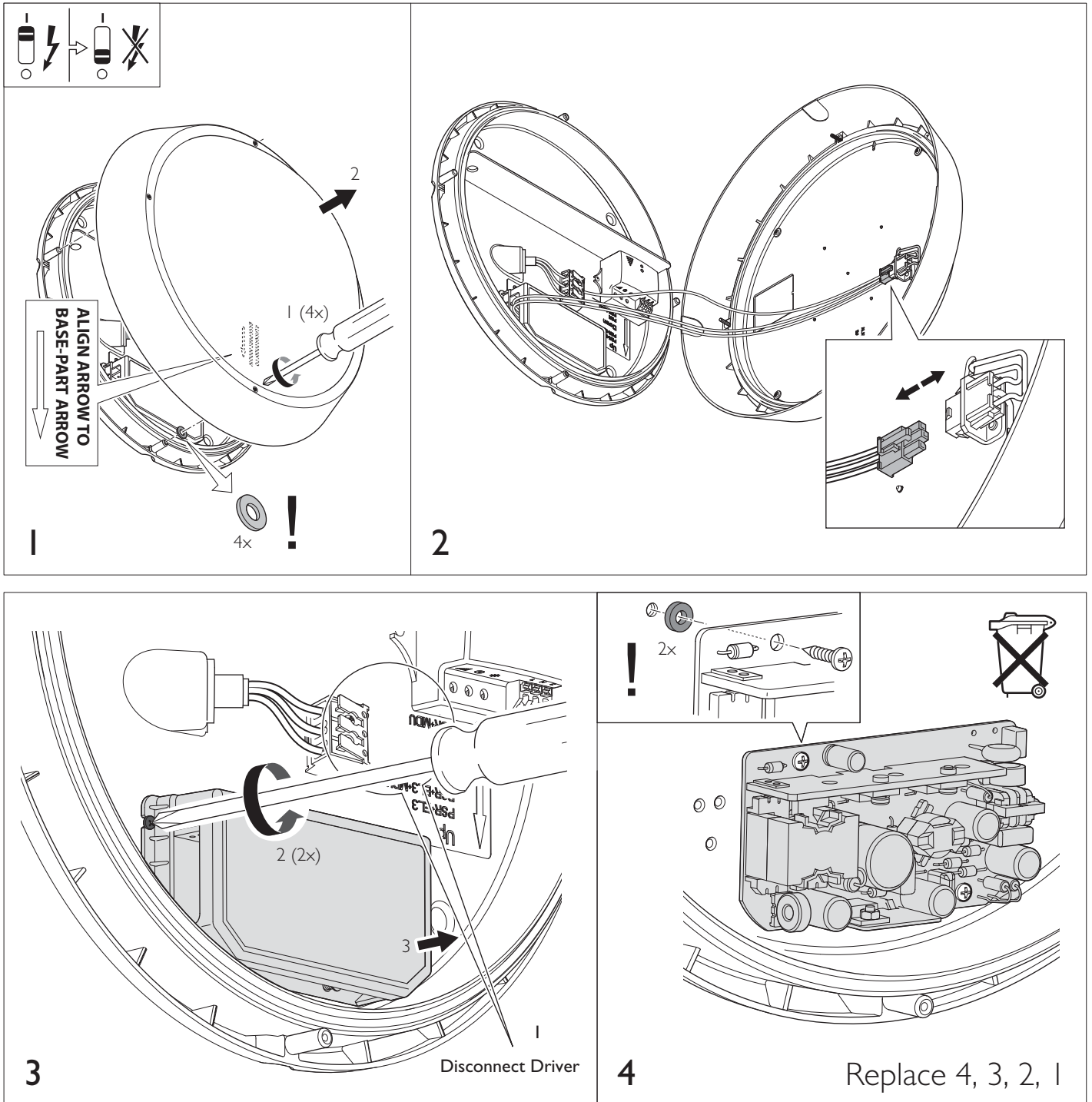

Maintenance instructions

There are a few instructions regarding the maintenance of this LED luminaire. This is to assure the lighting quality of this unique LED lighting concept.

- Do not touch electronic components! Electronic components are under high voltage.
- Do not stare into LED light beam.
- The luminaire shall be installed by a qualified electrician and wired in accordance with the latest EEE electrical regulations or the national requirements.
- Above average concentration of sulfur effects the useful lifetime of the produkt. E.g: Light color changes from white to blue. Typically in chicken & pig farms.



HF-MOTION DETECTOR

OPERATING MANUAL

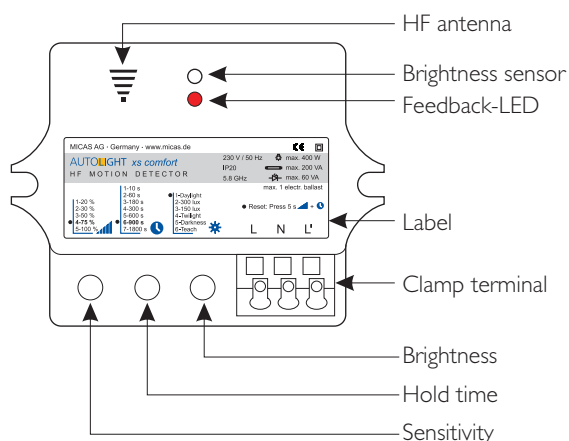

Figure 1: Description of the device

FUNCTIONS

DETECTION

When the device detects movements within the detection field, the luminair is automatically switched on for a defined dwell time.

TECHNICAL DATA

Sensor

Sensor principle

Frequency range

Radiated power

Detection field

Range

Detection angle

Detection triggering speed

Operating conditions

Mounting height

HF-motion detector

5.8 GHz +/- 75 MHz

< 5 mW

Up to 10 m (at 100% sensitivity, frontal, sensor uncovered)

Approx. 120° (depending on the cover)

0.3 ... 3 m/s (1 ... 10 km/h)

Max. 2.70m (wall mounting),
max. 4.00 m (ceiling mounting)

SETTINGS

AUTOLIGHTxs comfort has the following factory settings(see bullets on label):

- Sensitivity / Range 75 %
- Dwell time 900 s
- Twilight level: daylight

All factory or all individual settings are retained even after loss of power. By simultaneous pressing of „Sensitivity“ and „Dwell time“ for 5 s, current settings can be reset to the factory settings.

INDIVIDUAL SETTINGS

Pressing a button advances the respective function to the next step. (LED flashes for acknowledgement)

With multiple consecutive keystrokes it is possible to switch a function by multiple steps without waiting for the blinking sequence after each step ("fast track"). After the highest level, the setting recommences with "Step 1".

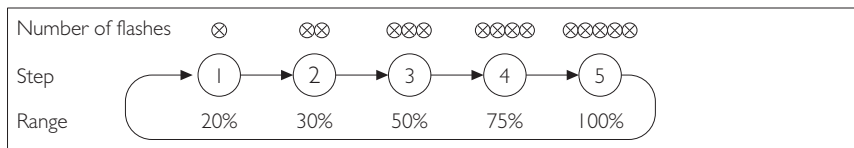

Figure 2: Setting of Sensitivity / Range (Button 1)

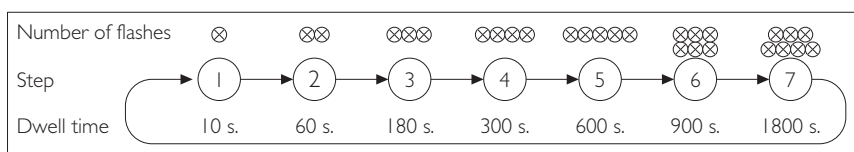

Figure 3: Setting of Dwell time (Button 2)

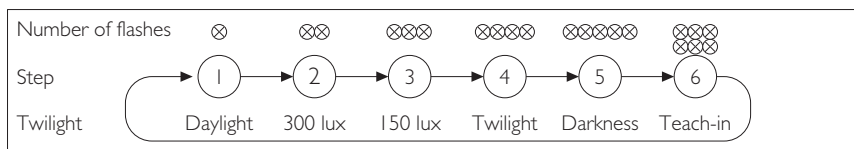

Figure 4: Setting of Twilight (Button 3)

The „Teach-in mode“ is activated by pressing button 3 (Twilight) for longer than 3 s. It is indicated visually by continuous slow flashing. After two minutes the current twilight value is measured for one minute. The LED flashes faster. On completion of this process the currently measured brightness value is saved as the threshold setting in AUTOLIGHTxs comfort and is available as the twilight value for step 6.

DAYLIGHT SENSOR

AUTOLIGHTxs comfort is fitted with a daylight sensor, which can be adjusted using the following steps:

- „Daylight“: The consumer can be triggered at any time, even in daylight.
- „300 Lux“: The consumer can be triggered when the ambient is less than approx. 300 Lux.
- „150 Lux“: The consumer can be triggered when the ambient is less than approx. 150 Lux.
- „Twilight“: The consumer can be triggered only at twilight of less than approx. 50 Lux.
- „Darkness“: The consumer can be triggered only in darkness less than approx. 5 Lux.
- „Teach-in“: The sensor switch-on value calibrated for the consumer as the current brightness or less.