

**READ AND UNDERSTAND THESE INSTRUCTIONS BEFORE INSTALLING LUMINAIRE**

This luminaire is intended for installation in accordance with the National Electrical Code and local regulations. To assure full compliance with local codes and regulations, check with your local electrical inspector before installation. To prevent electric shock, turn off electricity at fuse box before proceeding.

**Retain these instructions for maintenance reference.**

cord into the fixture housing. After final adjustment insure sufficient slack is present in power cord before securely tightening strain relief.

CAUTION: Once inverter is connected battery power will be present. Do not attempt to service unit while inverter is connected.

- Prior to joining inverter connector, install appropriate wattage lamp (see fixture label) and restore/establish power to the branch circuit.
- Connect inverter connector and install canopy housing door. Allow 24 hours for emergency battery to fully charge.

WIRE DIAGRAM

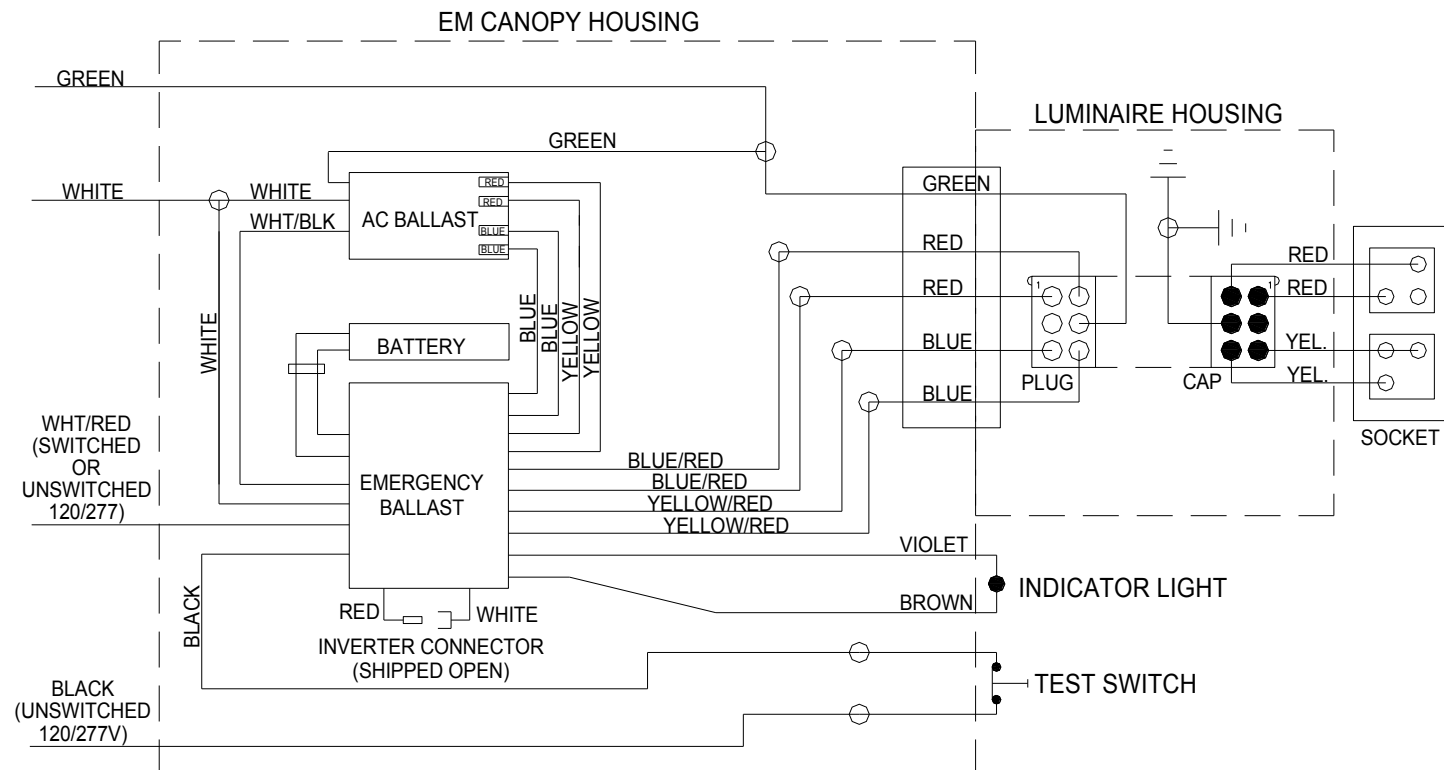
**READ AND UNDERSTAND THESE INSTRUCTIONS BEFORE INSTALLING LUMINAIRE**

This luminaire is intended for installation in accordance with the National Electrical Code and local regulations. To assure full compliance with local codes and regulations, check with your local electrical inspector before installation. To prevent electric shock, turn off electricity at fuse box before proceeding.

**Retain these instructions for maintenance reference.**

**INSTRUCTION FOR INSTALLATION OF PRE-WIRED COMPACT FLUORESCENT****EMERGENCY LIGHTING DECORATIVE PENDANT LUMINAIRE**

**WARNING: (RISK OF FIRE) SUPPLY WIRE MUST BE RATED 90°C. MOST DWELLINGS BUILT BEFORE 1985 HAVE SUPPLY WIRE RATED FOR 60°. CONSULT A QUALIFIED ELECTRICIAN BEFORE INSTALLATION.**

**IMPORTANT SAFEGUARDS**

READ AND FOLLOW ALL SAFETY INSTRUCTIONS

WHEN USING ELECTRICAL EQUIPMENT, BASIC SAFETY PRECAUTIONS SHOULD ALWAYS BE FOLLOWED INCLUDING:

- Turn off AC power before proceeding.
- Be sure all electrical connections are complete and outlet box is closed before inverter connector on emergency pack is connected.
- Do not use outdoors.
- Do not mount near gas or electrical heaters.
- Do not attempt to service the battery. A sealed, rechargeable, no maintenance battery is used. Do not incinerate or mutilate; may burst or release toxic materials. Do not short circuit; may cause burns. Battery acid can cause burns to skin and eyes. If acid is spilled on skin or eyes, flush with water and contact a physician immediately.
- Equipment should be mounted in locations and at a height where it will not readily be subject to tampering by unauthorized personnel.
- The use of accessory equipment is not recommended by the manufacturer and may cause an unsafe condition.
- Do not use equipment for other than intended use.
- This unit has more than one power supply connection point. To reduce the risk of electrical shock, disconnect both the normal and the emergency power supplies before servicing.
- Before servicing to prevent electrical shock, disconnect the battery connector on the emergency pack (located behind the canopy access door). Make certain that the switch (if fixture is switched) and the unswitched lines to the emergency pack are turned off at the fuse box. Servicing should be performed by qualified personnel only.

**INSTALLATION****WARNINGS:**

- TO PREVENT DAMAGE TO THE EMERGENCY BALLAST, JOIN THE BATTERY CONNECTOR BEFORE SUPPLYING AC POWER TO THE EMERGENCY BALLAST.
- TO PREVENT HIGH VOLTAGE FROM BEING PRESENT ON BLUE/RED & YELLOW/RED OUTPUT LEADS PRIOR TO INSTALLATION, INVERTER CONNECTOR MUST BE OPEN. DO NOT JOIN INVERTER CONNECTOR UNTIL INSTALLATION IS COMPLETE AND AC POWER IS SUPPLIED TO THE EMERGENCY BALLAST.

- Make sure AC power is off at fuse box.
- Make sure that the necessary branch circuit wiring is available. An unswitched source of power is required for the emergency pack.
- The emergency pack must be fed from the same branch circuit as the AC ballast.
- In switched fixtures, "unswitched" lead must be connected ahead of any local switching.
- Be sure all electrical connections are made and the outlet box is closed before inverter connector is connected.

This luminaire is intended for installation in accordance with the National Electrical Code and local regulations. To assure full compliance with local codes and regulations, check with your local electrical inspector before installation. To prevent electric shock, turn off electricity at fuse box before proceeding.

Retain these instructions for maintenance reference.

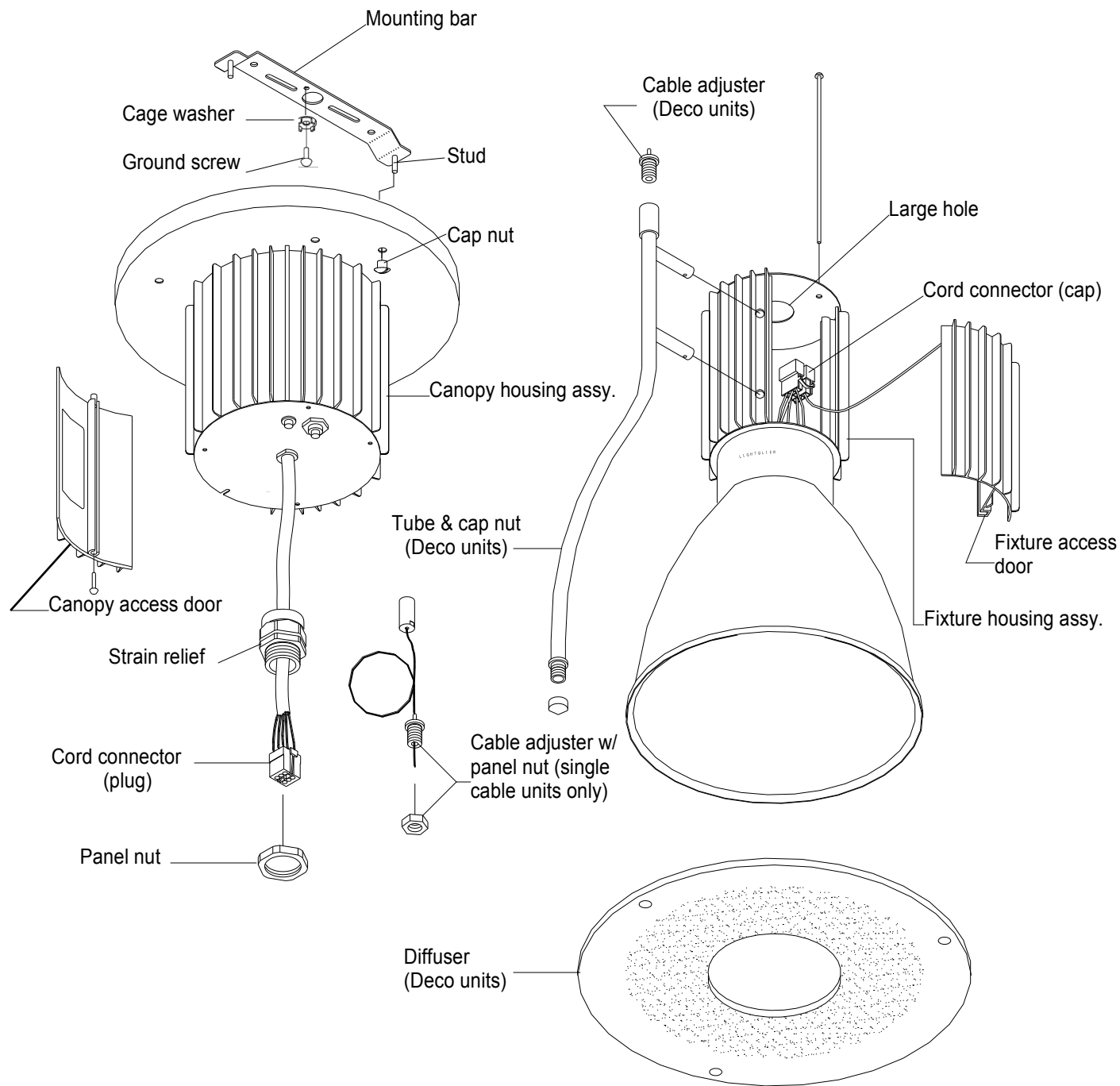

FIG. 1

This luminaire is intended for installation in accordance with the National Electrical Code and local regulations. To assure full compliance with local codes and regulations, check with your local electrical inspector before installation. To prevent electric shock, turn off electricity at fuse box before proceeding.

Retain these instructions for maintenance reference.

This luminaire mounts to a standard 4-inch round or octagonal outlet box (not included). For normal switched operation with emergency back-up function two power supply leads from the same branch circuit are required; one switched and one unswitched. Minimum wire size required from the power supply is 18 AWG.

**WARNING:** Insure that power supply is turned off at the breaker or fuse box prior to installation. This unit has more than one power supply connection point. To reduce the risk of electric shock, disconnect both the branch circuit breakers or fuses and the emergency power supply at the inverter connector before servicing.

**CAUTION:** Do not attempt to access or handle the emergency ballast circuit board. A residual charge may be present in the storage battery and/or capacitors. Verify that the inverter connector (single red to single white lead connector) is disconnected prior to installation.

1. Locate and remove canopy housing access door by loosening Philips head screw identified by slotted hole. Verify that inverter connector (single red to single white lead connector) is disconnected.
2. Attach mounting bar to outlet box with ends facing down, using screws provided with outlet box. Screw threaded studs into outer most holes approx. ¼ inch. Connect one end of ground wire to ground connection of outlet box and other end to mounting bar using green ground screw and cage washer provided. Install additional anchors, suitable to ceiling application, through provided mounting holes.
3. For 120V/277 60Hz operation, while supporting canopy housing make electrical connections as follows using suitable electrical wire nuts (available at hardware or electrical supply);
  - Green lead to ground.
  - White lead to neutral.
  - White/Red lead to switched 120/277V power supply.
  - Labeled Black lead to unswitched 120/277V power supply.
4. Position canopy assembly over mounting studs, install decorative cap nuts, and secure. Do not over tighten.
5. For decorative 3-cable suspension units, remove suspension cables from shipping bags. Remove luminaire access door. (For 12 & 16 Inch units, first remove diffuser disk by unscrewing decorative cap nuts on end of tubes, and loosen Philips screw at slotted hole. The decorative tube need not be removed from door. For 9 Inch units, locate door and remove long screw on top closest to door.) While supporting luminaire, slip cables into adjusters at tops of the decorative tubes and verify that they are secure. Remove panel nut from strain relief fitting and feed power cord connector and strain relief fitting through large center hole in the top of luminaire. Install panel nut from inside to secure strain relief fitting. Join cord connector halves and re-install access door. luminaire height may be adjusted by depressing top of adjusters. Release top of adjuster to lock cables into position. Reinstall luminaire access door and assemble diffuser disk. SEE STEP 8.
6. For standard single cable suspension units, locate and remove luminaire access door. (For 12 & 16 Inch units, loosen Philips screw at slotted hole. For 9 Inch units, remove long screw on top closest to door.) Remove suspension cable from shipping bag. While supporting luminaire, install cable adjuster through center hole in top of luminaire using panel nut to secure.

Remove panel nut from power cord strain relief fitting, feed power cord connector and strain relief through large hole and re-install panel nut from inside to secure strain relief fitting. Join wire connector halves and re-install access door. SEE STEP 8.
7. For all cable suspension units, suspension cable(s) should support weight of luminaire. Weight of luminaire should not put strain on power cord. Unit is shipped fully extended. At initial installation, to change height or adjust for plumb, adjust suspension cables first. On 12 & 16 Inch single cable suspension units securely tighten the knurled safety nut on cable adjuster after final setting. If necessary, power cord may be adjusted by loosening strain relief and feeding excess