

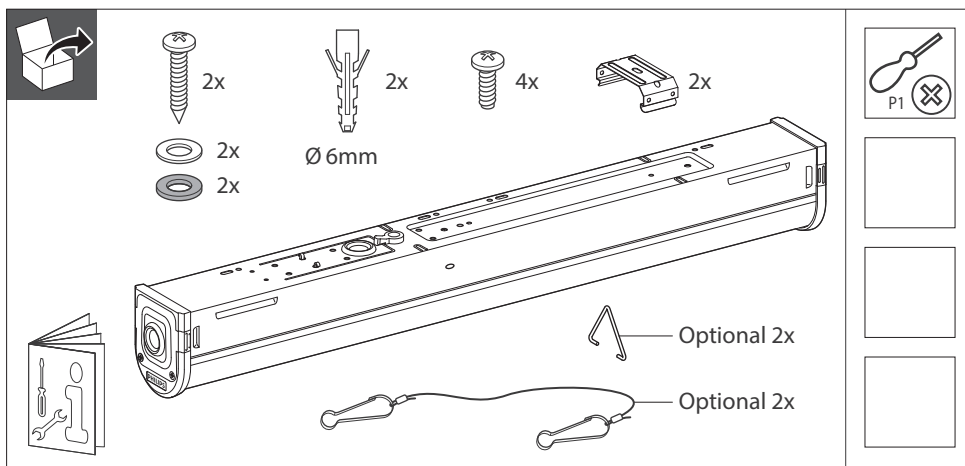

Coreline Batten

BN124C ELB3



	Pnom (W)	Pmax (W)	A(mm)	Bmin(mm)	Bmax(mm)	
BN124C LED41S/840 PSU ELB3 TW1 L1200	42	46	1134	876	924	2,18
BN124C LED64S/840 PSU ELB3 TW1 L1500	60	64	1416	1176	1224	2,55

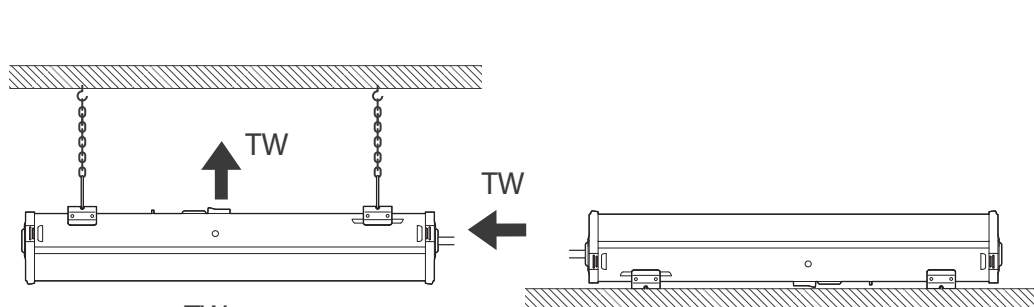
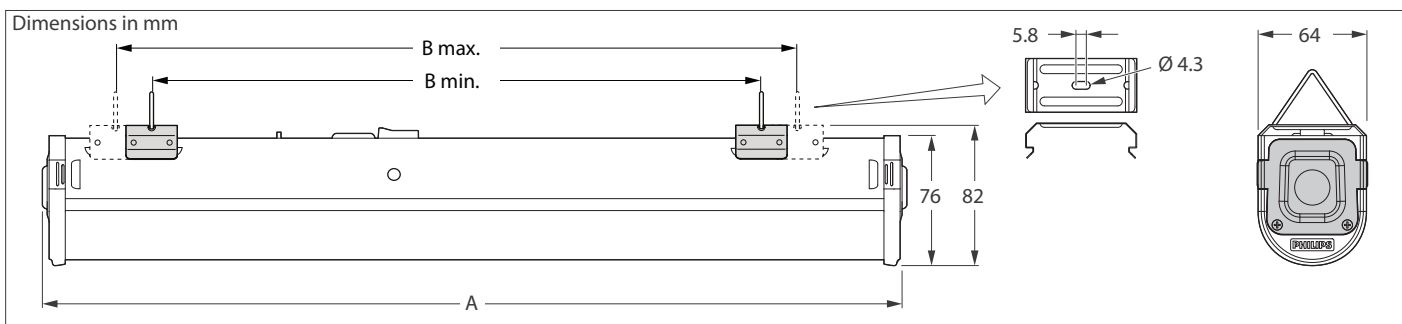

TW

Max. number of connected luminaire 10X

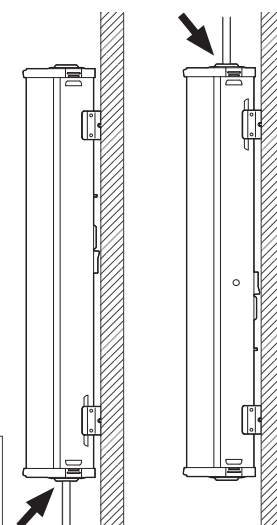

- The luminaire shall be installed by a qualified electrician and wired in accordance with the latest IEE electrical regulations or the national requirements.
- LED board & led driver are not serviceable and not replaceable.



ATTENTION
OBSERVE PRECAUTIONS
FOR HANDLING
ELECTROSTATIC
SENSITIVE
DEVICES

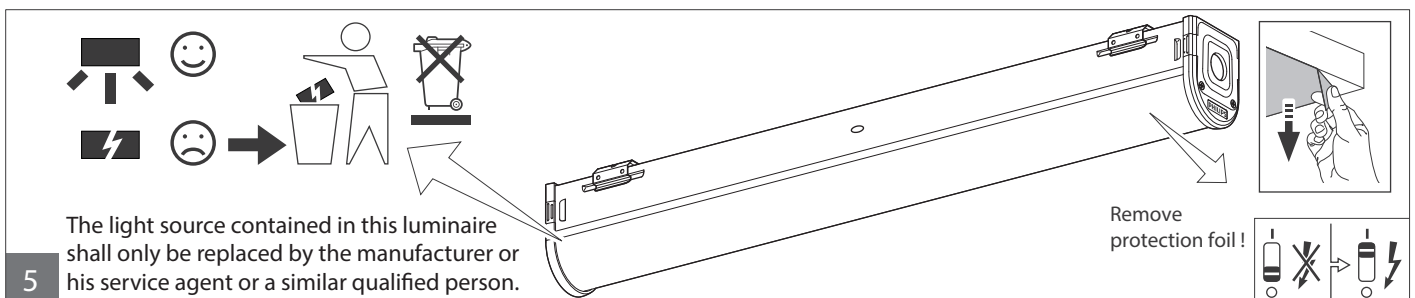
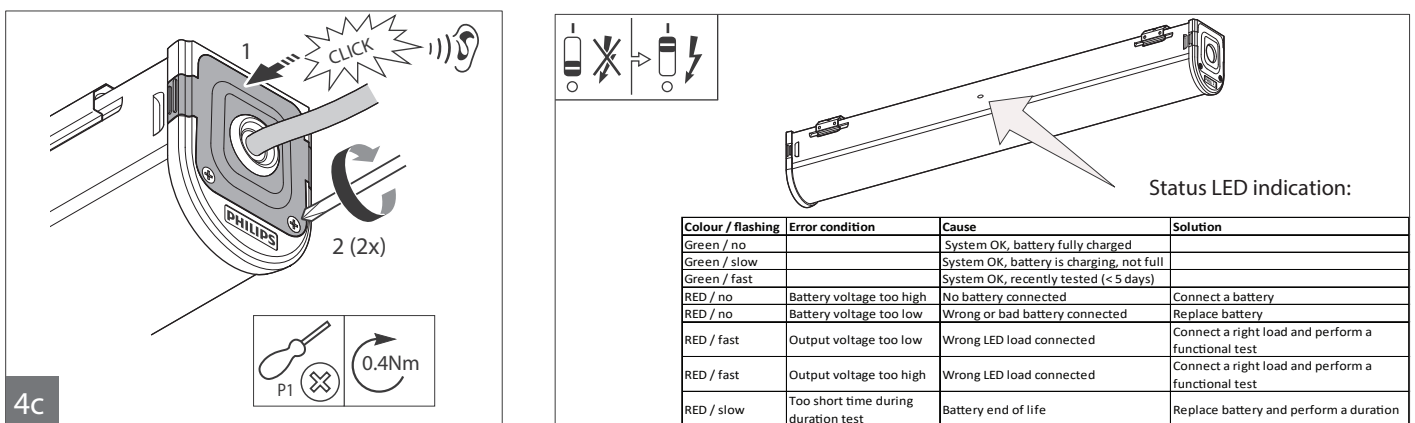
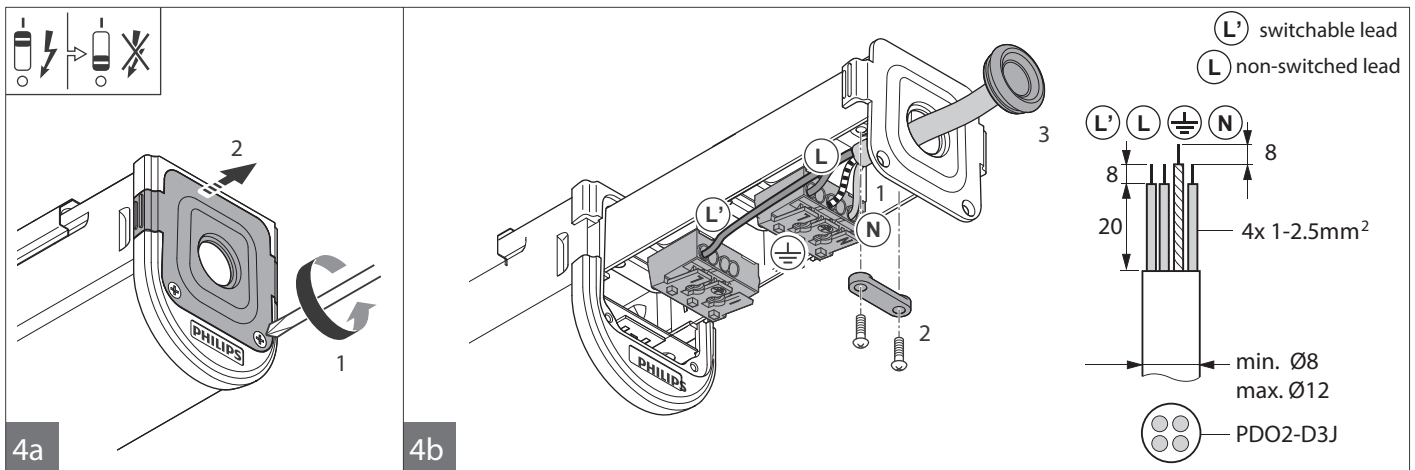
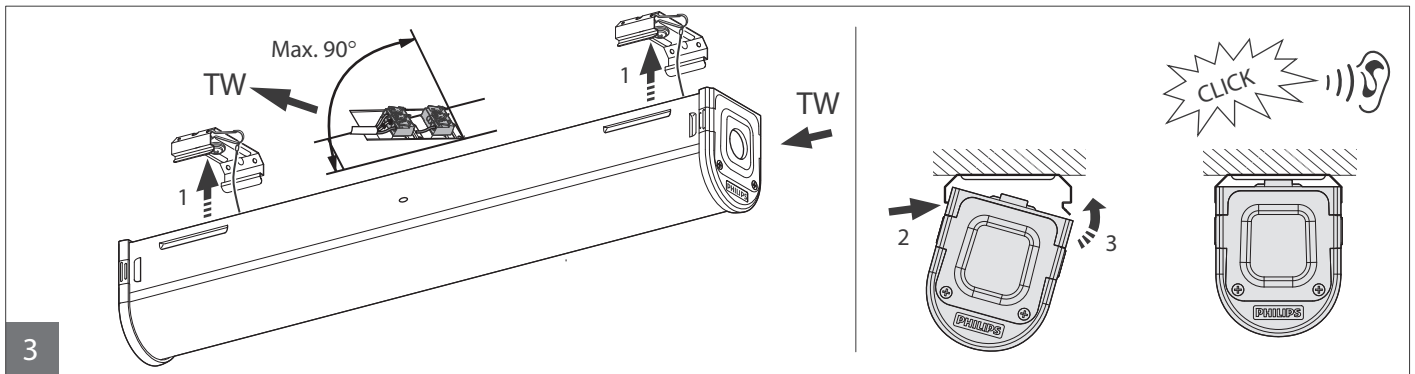
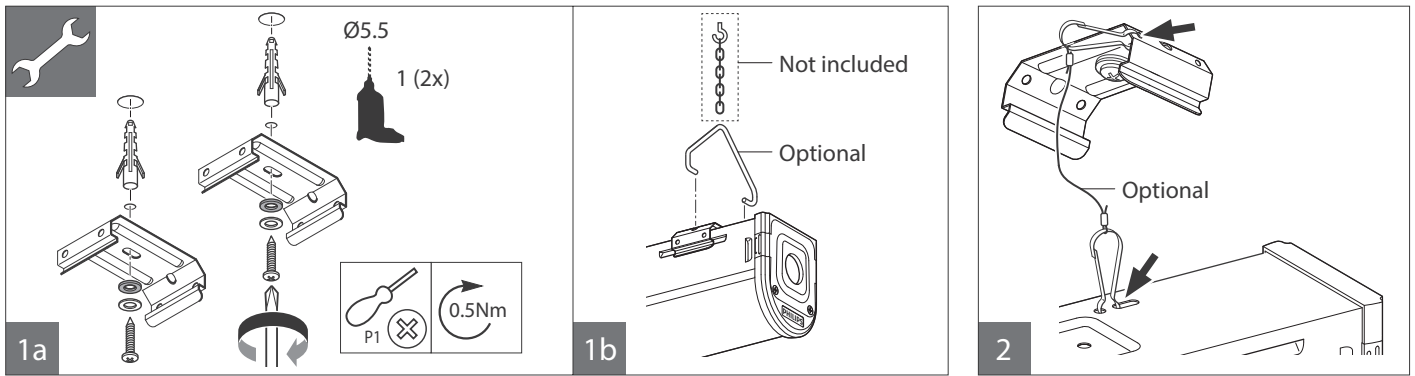



Emergency Luminaires with Batteries

Date of

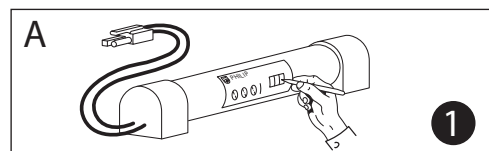

No tie wrap



Log book

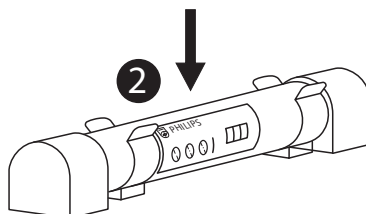

Test high voltage max. 500V



Caution, risk of electric shock!

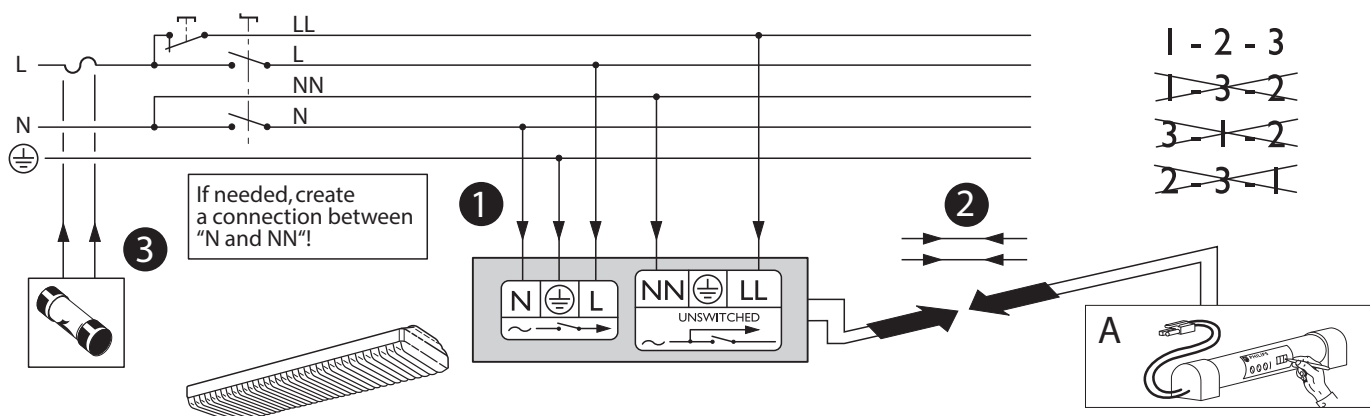

Charge time



24.00



Test: min. 5 s

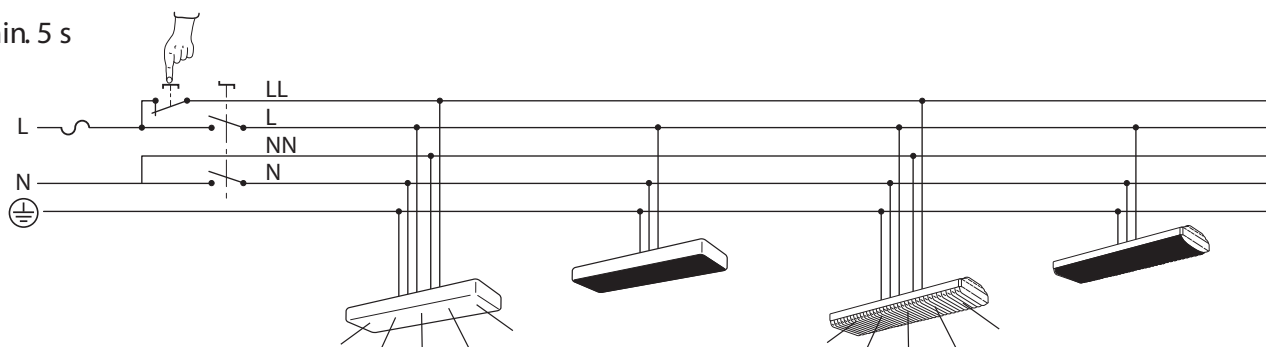

Lifetime

The batteries have a life time expectancy of 4 years when maintained properly. Replace after that time!

Periodic testing

Periodic tests should be performed according to EN50172: 2004, clause 7.2.3 and 7.2.4.

Each month the driver is running in emergency mode for 30 seconds.

Once a year a full discharge cycle of at least 3 hrs should be performed.

The tests could be done by complete disconnection of the luminaire.

Replacement Battery



SERVICE WARNING
DISCONNECT BATTERY

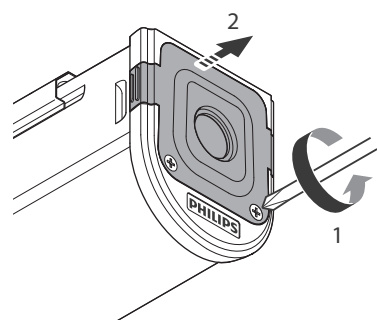
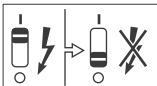

1

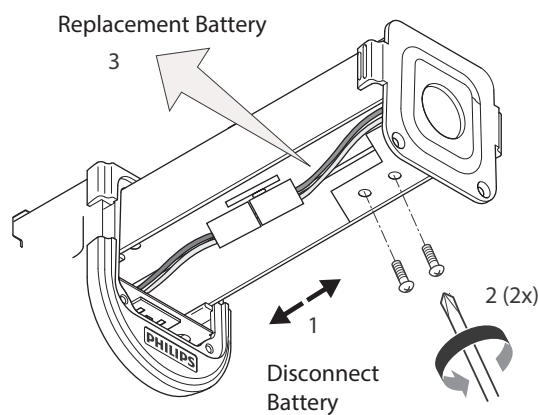

2

Replace 3, 2, 1

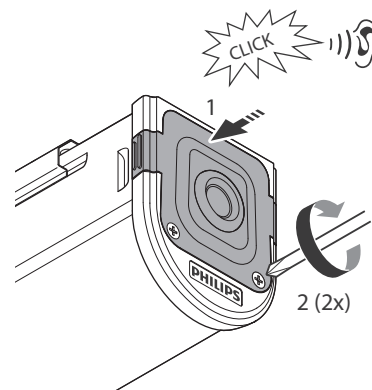

3

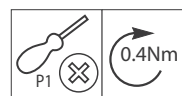

Inrush current

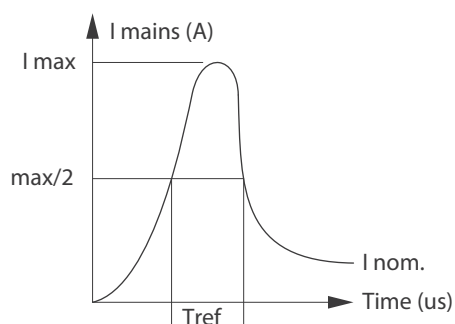

	LED41S L1200	LED64S L1500
Electrical characteristics		
Inom (mA)	290	370
I _{max} (A)	8	8
Tref (μs)	60	60
MC	Max. number of connected Luminaires	
B-10 A	1	15
B-16 A	24	24
C-10 A	24	24
C-16 A	40	40

Light intensity distribution curves

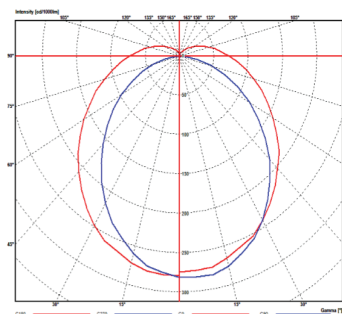

Rated lumen output in emergency mode: 500lm