

PHILIPS

Coreline
Waterproof

WT120C EL

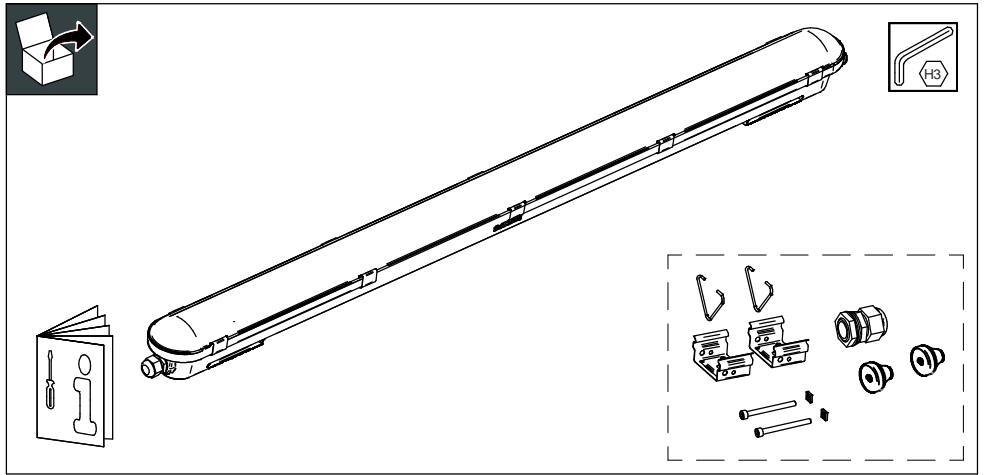

220 V
240 V

50 Hz
60 Hz



Max. 25 °C
Min. 0 °C



LIFETIME
50k HRS

IP65

IK08

GLOW
WIRE
850 °C



	System Power(W)	kg	System light output (Lm)	Color temperature (K)
WT120C LED22S/840 PSU L1200 EL1	22,5	2,3	2200	4000
WT120C LED22S/840 PSU L1200 EL3	22,5	2,5	2200	4000
WT120C LED40S/840 PSU L1200 EL1	32,5	2,3	4000	4000
WT120C LED40S/840 PSU L1500 EL3	32,5	2,5	4000	4000
WT120C LED34S/840 PSU L1500 EL1	28,5	2,5	3400	4000
WT120C LED34S/840 PSU L1500 EL3	28,5	2,7	3400	4000
WT120C LED60S/840 PSU L1500 EL1	57	2,5	6000	4000
WT120C LED60S/840 PSU L1500 EL3	57	2,7	6000	4000

Type	Dimension (mm)						Nr. of clips
	A	B	C	D	E	F	
WT120C LED 22S L1200	82	1250	87	38	960	96	10
WT120C LED 40S L1200		1530			1213		12
WT120C LED 34S L1500							
WT120C LED 60S L1500							

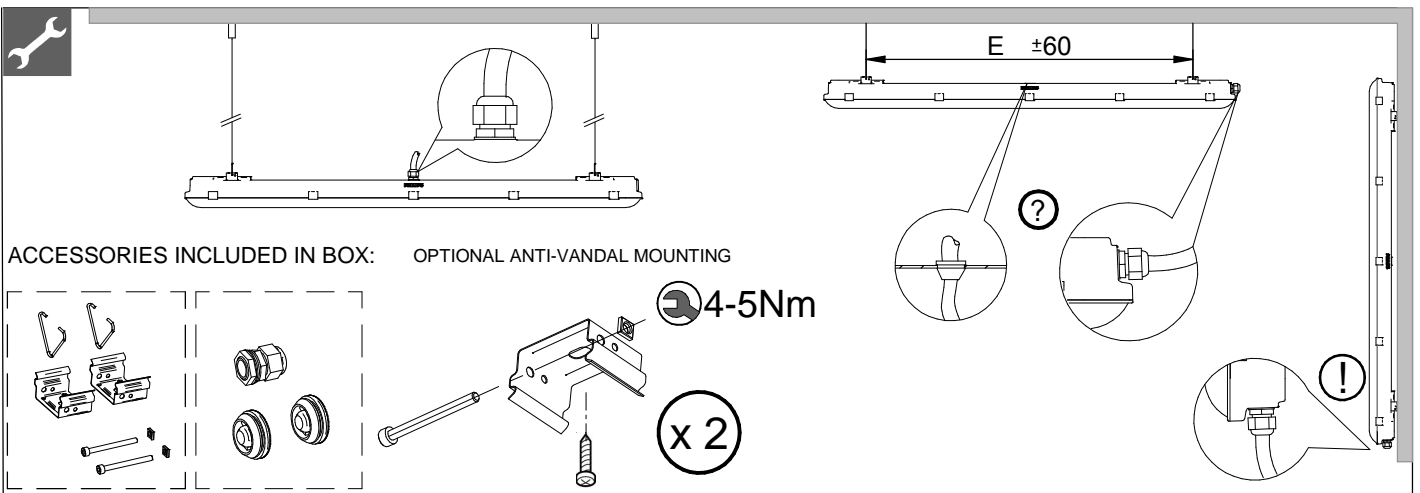



Switch off the power supply before installation

□0,75-2,5mm²

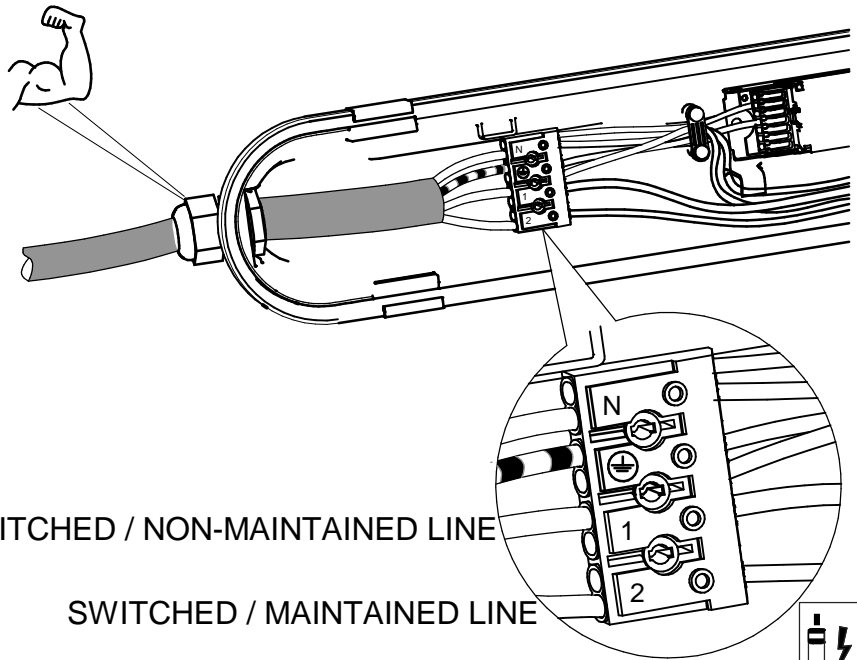
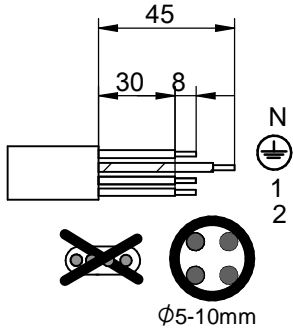

UN-SWITCHED / NON-MAINTAINED LINE

SWITCHED / MAINTAINED LINE

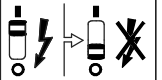

2

THROUGH WIRING

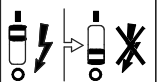
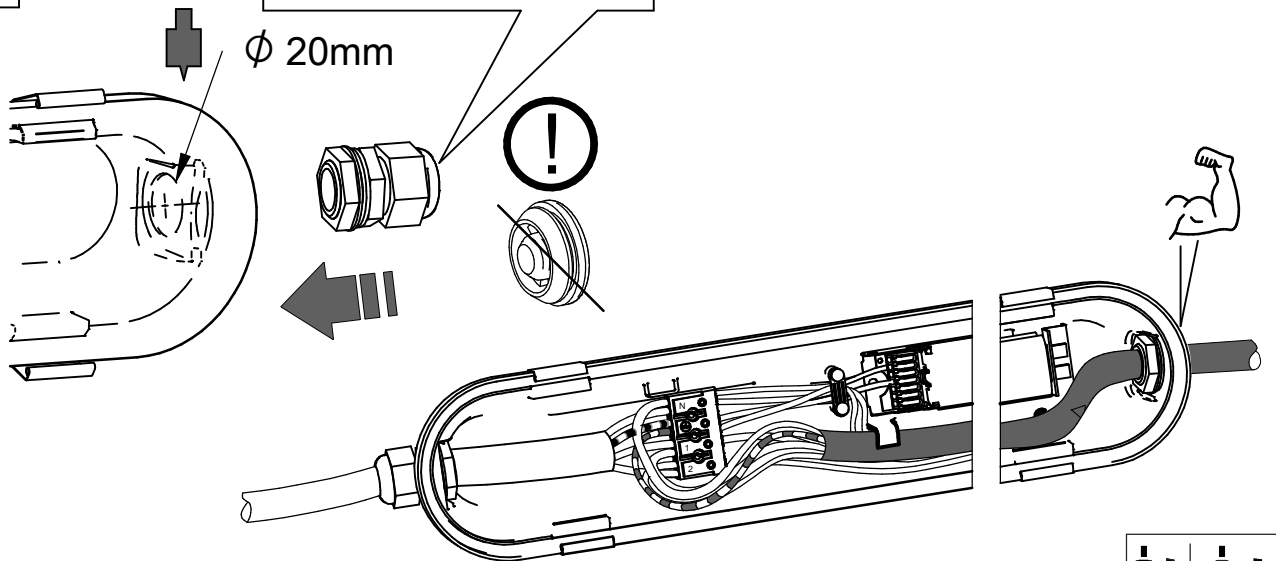
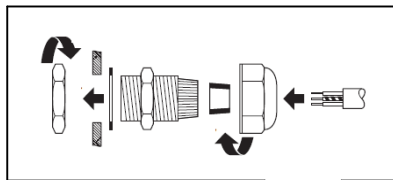
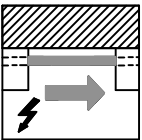

3

USE ONLY OPICAL SUB-ASSEMBLY THAT DELIVERED WITH HOUSING IN ONE BOX

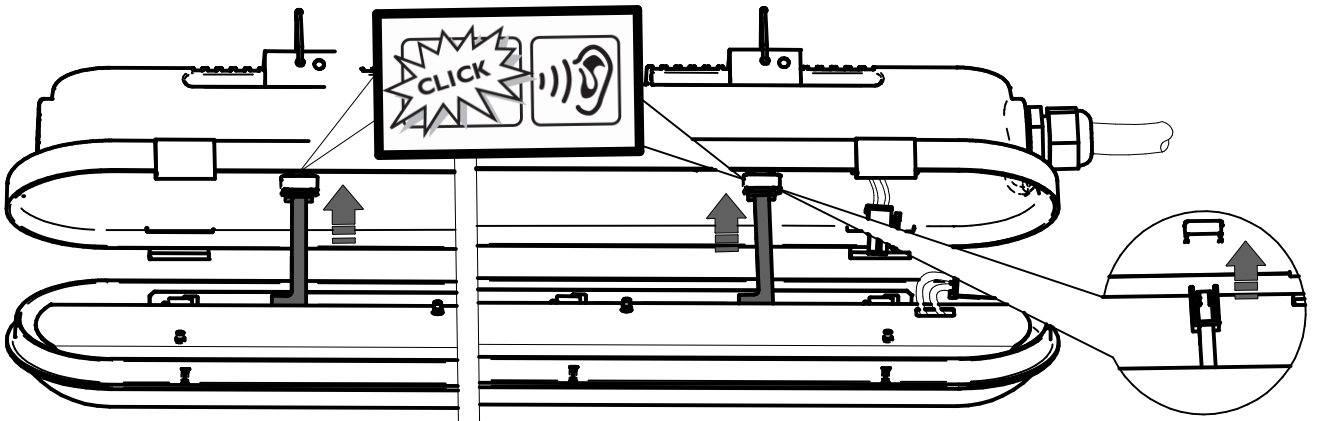

4

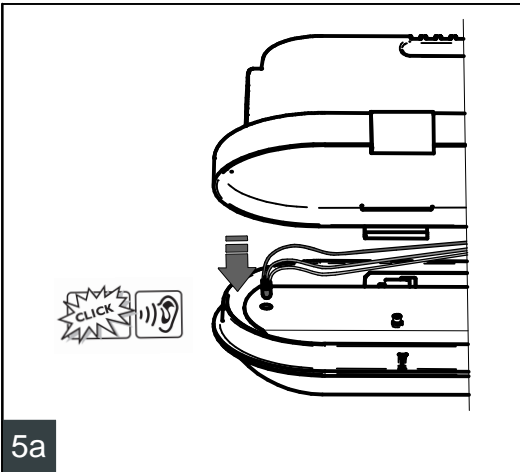

5a

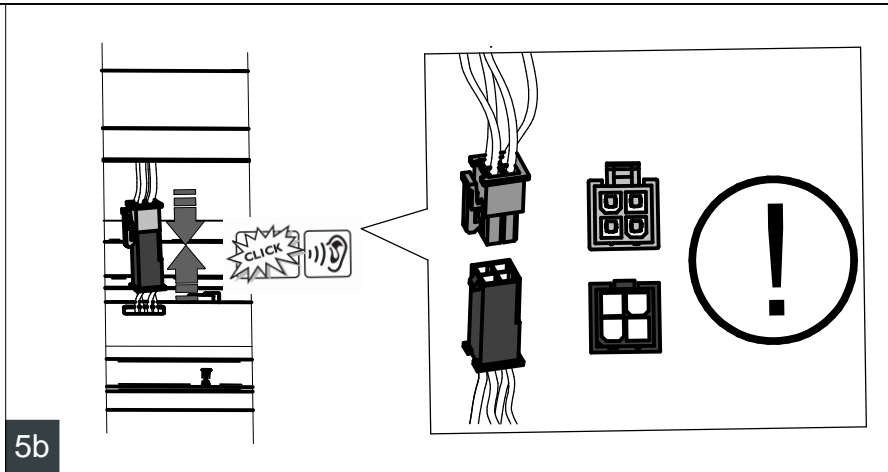

5b

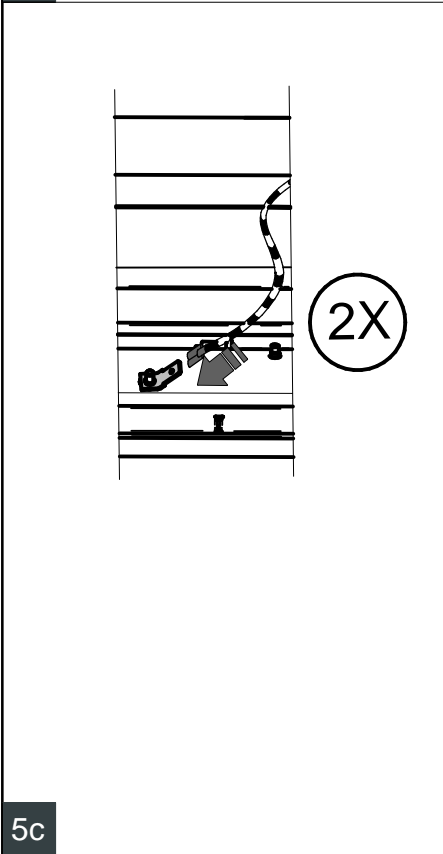

5c

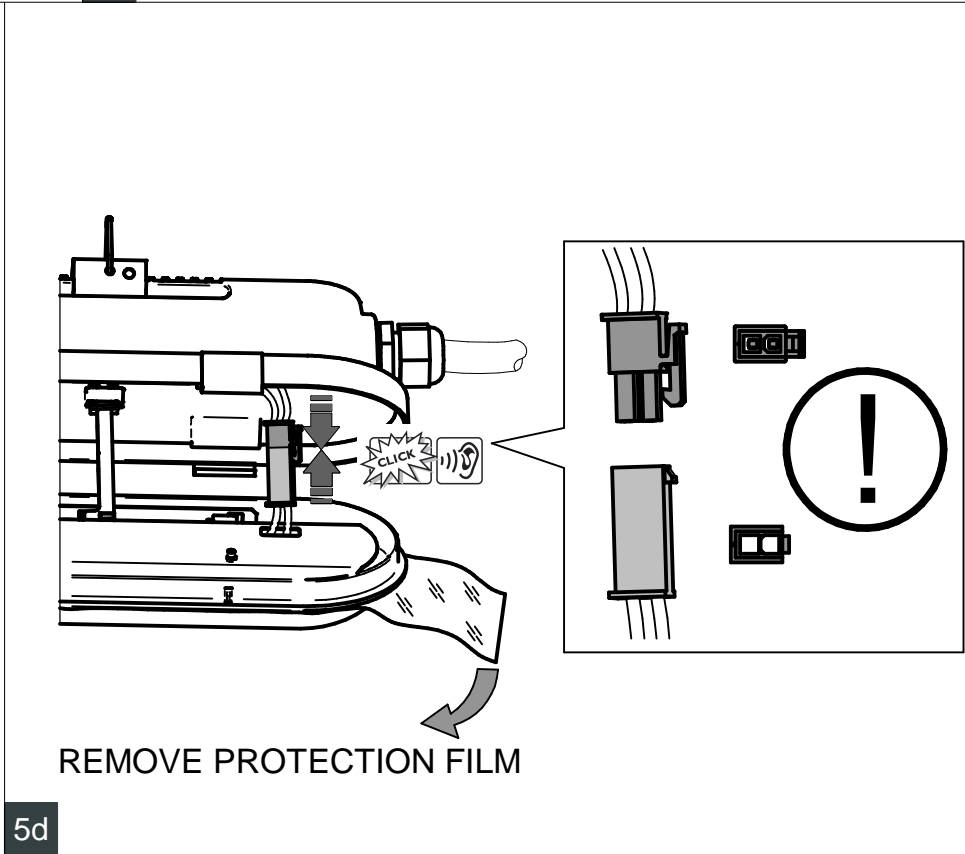

5d

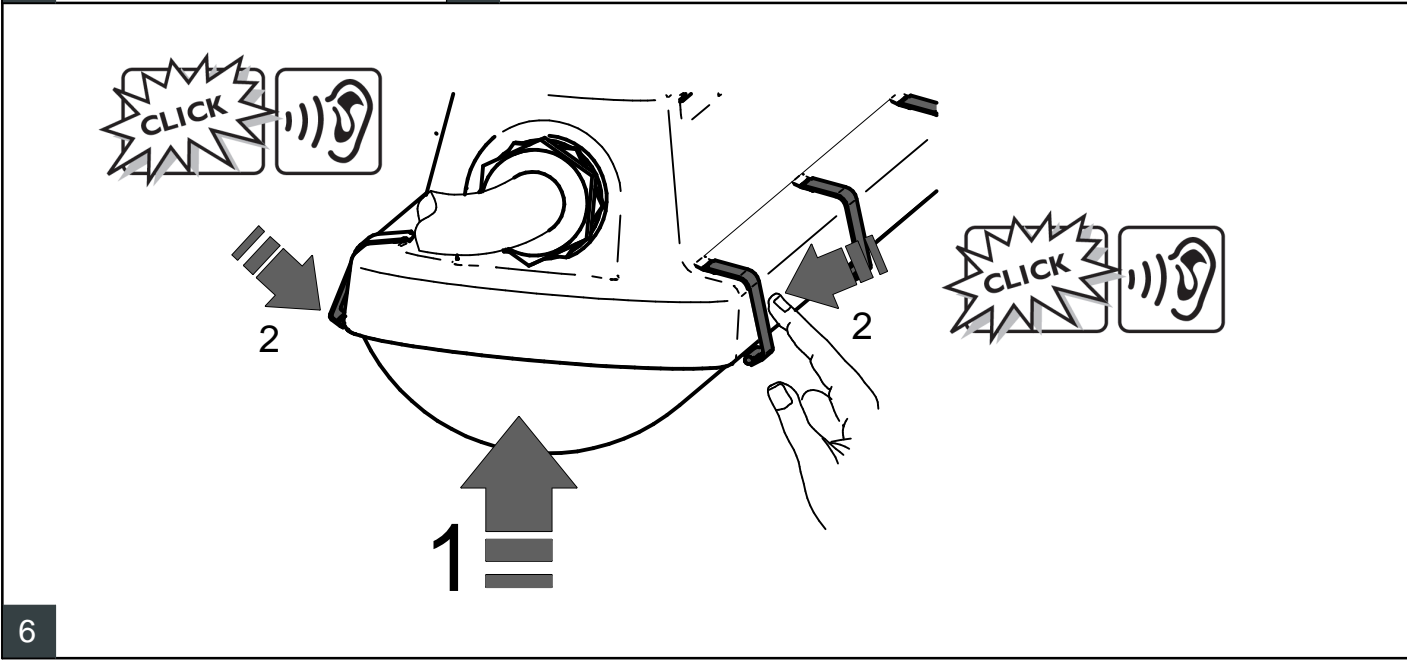

6

SERVICE: (DRIVER / BATTERY REPLACEMENT)



The batteries have a life time expectancy of 4 years.

Light source (LED) is not replaceable.

A) OPEN LUMINAIRE

B) DECOUPLE BATTERY WIRES

C) UNTIGHT BATTERY SCREWS

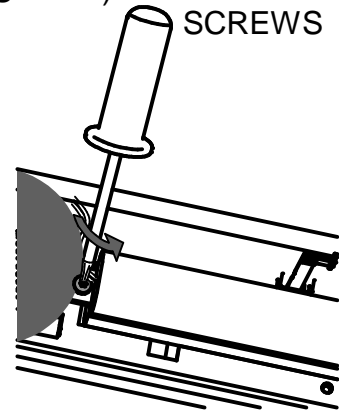
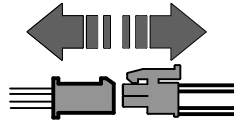
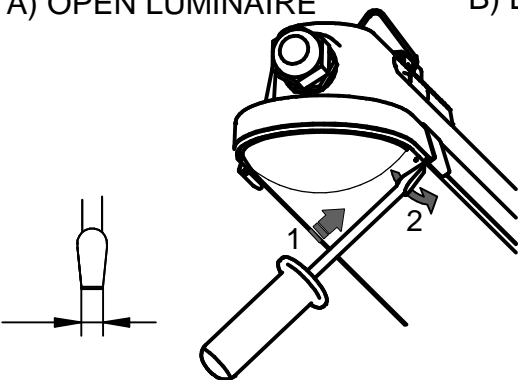

MAXIMAL SCREWDRIVER SIZE: 8MM

7

	LED22S	LED34S	LED40S	LED60S
I _{peak} [A]	14	17,8	15,1	17,8
T _{width} [μs]	250	182	230	282
Max. Nr of products				
Drivers / MCB 16A type B [max.]	33	24	33	24
Drivers / MCB 10A type B [max.]	20	15	20	15
Drivers / MCB 16A type C [max.]	56	40	56	40
Drivers / MCB 10A type C [max.]	33	24	33	24

LIGHT INTENSITY
DISTRIBUTION CURVES
EMERGENCY MODE

--- C 0-180 PLANE

--- C 90-270 PLANE

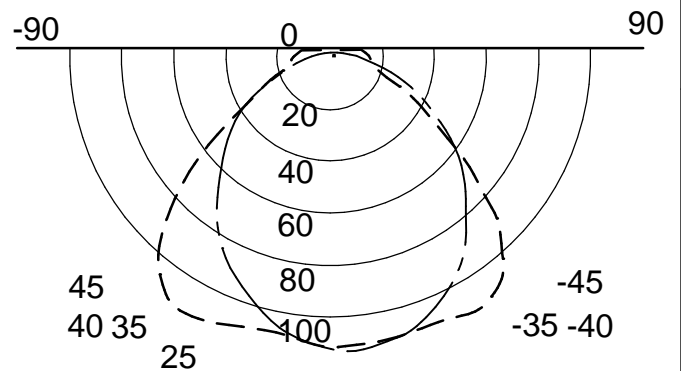
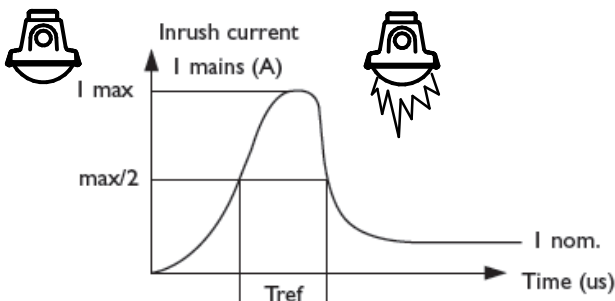

Maintenance instructions

To assure the lighting quality of this unique LED lighting concept there are only a few instructions regarding the maintenance of this LED luminaire:

- * Do not touch electronic components!
Electronic components may be under high voltage.
- * Do not stare into LED light beam.
- * The luminaire shall be installed by a qualified electrician and wired in accordance with the latest IEE electrical regulations or the national requirements.
- * Above average concentration of sulfur affects the useful lifetime of the product.
E.g: Light color changes from white to blue. Typically in chicken & pig farms.



ATTENTION
OBSERVE PRECAUTIONS
FOR HANDLING
ELECTROSTATIC
SENSITIVE
DEVICES



