



Linear Recessed

TruGroove LED

# Add **dimension** to your vision

Philips Ledalite TruGroove LED Linear Recessed Luminaires integrate with Armstrong Formations™ Clouds, bringing seamless coordination to your design.



# Simple **sophistication** within the clouds

Sunbeams streaming through clouds can inspire a pause, and an appreciation of nature's surrounding beauty. Your uniquely designed architectural spaces evoke a similar response, and we can help to add new light and dimension to your vision. TruGroove LED is now available to integrate with Armstrong Formations™ Clouds in exposed or open plenum ceiling designs.

This exclusive partnership brings boundless flexibility to your design, and streamlines your specifying and installation processes. And as always, you receive excellent light distribution and outstanding energy performance for maximum impact in form and function.



# No more limits on your **vision**

The sky's the limit. Your vision is an uncompromised reality thanks to the multitude of cloud panel and integrated lighting options. TruGroove LED in Formations™ Clouds offer interesting visual appeal in new and renovation spaces without custom creation expenses. Each cloud has a central 4-inch opening specifically designed to integrate the TruGroove LED fixture.

TruGroove LED in Formations™ Clouds offer:

- **Performance or Definition optics** – create bright, visually comfortable open areas with high transmission and lower energy use, or complement decorative, way finding, or high ceiling spaces
- **Multiple color temperatures, lumen packages and run lengths** – fine-tune your design to enhance and captivate
- **Flexibility beyond the cloud** – extend your design aesthetic with our complete TruGroove LED family which includes wall mount and inside/outside corners



# Creative **freedom**, unrivaled **performance**

You don't need extraordinary expenses and complexities to create an exceptional, unique suspended ceiling in your architectural space. You do, however, require lighting solutions that seamlessly embody your sophisticated style while delivering flexibility and performance. You can rely on Philips Lighting to meet or exceed those expectations and partner with you to create a space that delivers aesthetic impact with smooth, pure luminance and paramount energy performance.

- **Performance and comfort** – outstanding visual cut-off and spacing criteria permit ultra-low energy densities and improved visual comfort
- **Trust** – depend on us for collaboration and consultation at every step of your project
- **Efficiency** – TruGroove LED luminaires are independently tested to IES LM-79 and are designed to deliver energy densities well below industry guidelines
- **Seismic design** – TruGroove LED luminaires in Formations Clouds are approved for seismic categories D, E and F

# Harmony in your design

Planning and creating your unique space is complex and time-consuming; and we want to help simplify your processes wherever possible. In this manner, we streamlined your specification and installation steps by partnering with Armstrong to simplify linear LED lights and cloud ceilings as one pre-engineered system. This means that you enjoy the blended expertise and dependable support of two respective industry foreleaders: Philips Lighting and Armstrong.

- **Holistic solution** – components were specifically created to function together to reduce unnecessary complexity that may arise when specifying and adapting components from unassociated vendors
- **Labor time and cost savings** – no yokes or independent supports are used, and on-site customizations are not necessary
- **Plug and play platform** – TruGroove LED maintenance and replacements are quick and hassle-free
- **Acoustics** – Armstrong ceilings offer an unrivaled acoustical performance



## Lens and T-grid configurations

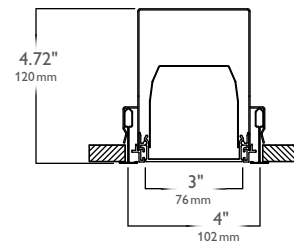

Flush lens, standard  $\frac{9}{16}$ "  
Flush lens, standard  $\frac{15}{16}$ "

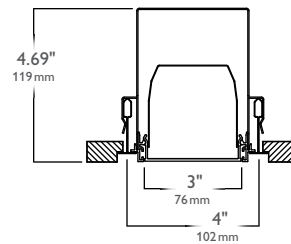

Flush lens, tegular  $\frac{9}{16}$ "

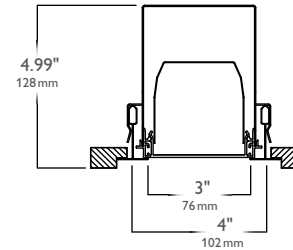

Flush lens, tegular  $\frac{15}{16}$ "

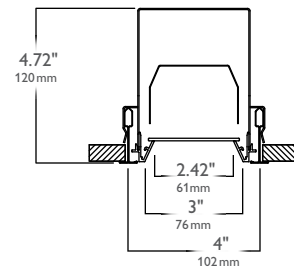

Regressed lens, standard  $\frac{9}{16}$ "  
Regressed lens, standard  $\frac{15}{16}$ "

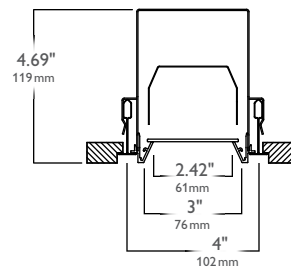

Regressed lens, tegular  $\frac{9}{16}$ "

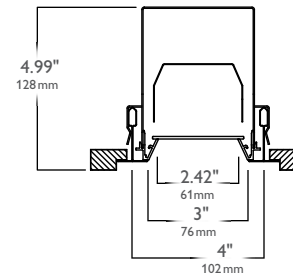

Regressed lens, tegular  $\frac{15}{16}$ "

# Explore your options

# Available Armstrong Formations™ Cloud shapes and sizes

## 2' x 2' Panels

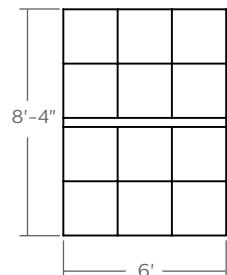

6' x 8'

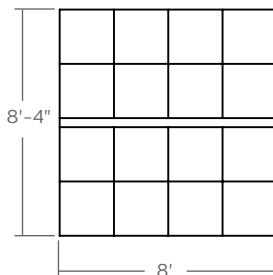

8' x 8'

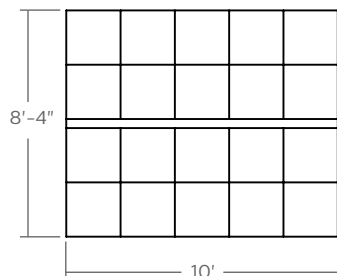

8' x 10'

**Grid options:**  
Prelude  
Suprafine  
Interlude

**Ceiling panel options:**  
Optima Tegalur  
Ultima Tegalur  
Calla Tegalur  
Lyra Tegalur

## 30" x 30" Panels

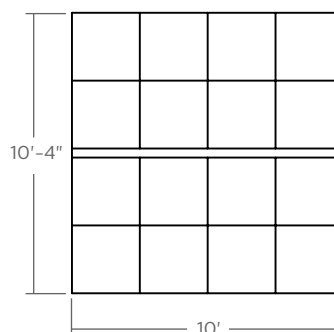

10' x 10'

**Grid options:**  
Suprafine  
Interlude

**Ceiling panel options:**  
Optima Tegalur  
Ultima Tegalur  
Calla Tegalur  
Lyra Tegalur

All clouds have a 4in wide opening in the center specifically designed for the integration of a Philips Ledalite TruGroove LED luminaire.

Clouds must be ordered separately from TruGroove LED luminaires. Armstrong customer service is available to help with your project from start to finish. To order Armstrong Formations Clouds, call 1-800-840-8521.

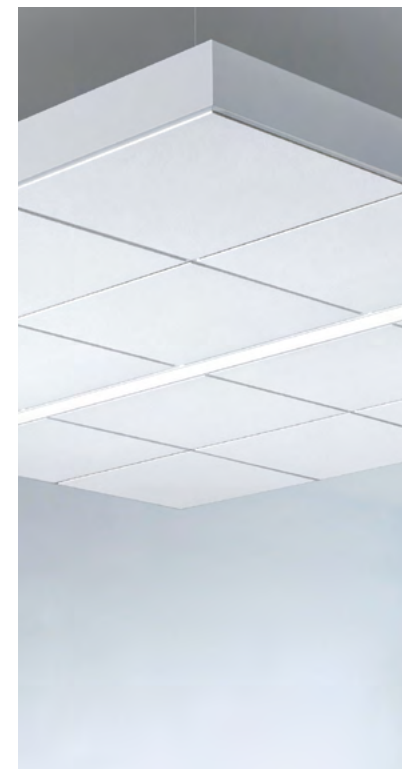

# TruGroove LED Specification Guide

Product Version			Distribution	Light Source			Optics	Body			Electrical		
Series	Version	Performance	Source	Lamps		Performance	Housing	Ceiling / Trim	Run Length / Size	Wiring	Voltage	Ballast / Driver	
				Color Temp.	Lumen Package*								
39	TruGroove Recessed	S Standalone	1 Symmetric	L LED	A 4000K	E 3000lm / 4ft	MesoOptics Lens Q Flush R Regressed	S Standard C Chicago	5 Armstrong Formations	06 6' 08 8' 10 10'	1 1 cct 3 1 cct w/ emergency 5 1 cct w/ battery pack 7 1 cct w/ dimming	1 120V 2 277V 3 347V	E Standard
					B 3500K	G 2200lm / 4ft							
					C 3000K	K 1500lm / 4ft							

\* Nominal output within a range. Consult spec sheets for exact lumen output for each configuration.



©2014 Koninklijke Philips N.V. All rights reserved. Philips reserves the right to make changes in specifications and/or to discontinue any product at any time without notice or obligation and will not be liable for any consequences resulting from the use of this publication.

PLe-1403BR 07/14 [www.philips.com/luminaires](http://www.philips.com/luminaires)

Philips Lighting  
North America Corporation  
200 Franklin Square Drive  
Somerset, NJ 08873  
Tel. 855-486-2216

Imported by: Philips Lighting,  
A division of Philips Electronics Ltd.  
281 Hillmount Road  
Markham, ON, Canada L6C 2S3  
Tel. 800-668-9008