

## READ AND UNDERSTAND THESE INSTRUCTIONS BEFORE INSTALLING FIXTURE

This fixture is intended for installation in accordance with the National Electrical Code and local regulations. To assure full compliance with local codes and regulations, check with your local electrical inspector before installation. To prevent electrical shock, turn off electricity at fuse box before proceeding.

**Retain these instructions for maintenance reference.**

INSTRUCTION SHEET NO.

# IS:40411

1198 Page 1 of 1

## INSTRUCTION SHEET FOR ASSEMBLY AND INSTALLATION OF 9" PENDALYTE™ SERIES

1. Thread STUD into CROSSBAR as shown (fig.1).
2. Using appropriate slots in CROSSBAR, secure CROSSBAR to OUTLET BOX using OUTLET BOX SCREWS (provided with OUTLET BOX).
3. While supporting CANOPY ASSEMBLY make connections: black POWER CORD lead to hot (black) supply lead; white POWER CORD lead to neutral (white) supply lead. Green POWER CORD wire is a ground wire and must be connected to grounding terminal or ground lead inside OUTLET BOX. Use WIRE NUTS (local hardware item). Push supply wires and connections back into OUTLET BOX.
4. Tighten SET SCREW into STRAIN RELIEF BUSHING to secure POWER CORD.

**CAUTION: MAKE CERTAIN WIRES ARE NOT PINCHED BETWEEN PARTS.**

5. Place STUD through hole in CANOPY and thread ADJUSTING COLLAR onto STUD securing CANOPY ASSEMBLY against ceiling.

### POWERHEAD INSTALLATION:

1. Remove DOOR from POWERHEAD by removing screw (labeled open) in top mounting plate. Pull door directly away from powerhead.
2. Height Adjustment: To raise fixture, push CABLE down into HANGER FITTING. If necessary, push excess POWERCORD down into POWERHEAD. (Make certain CABLE does not interfere with internal wiring or components, both POWERCORD and CABLE may be cut inside POWERHEAD.) To lower fixture, push down on PLUNGER and allow fixture to drop to desired height.
3. If necessary, cut excess CABLE from inside POWERHEAD.
4. Using wire nuts (local hardware item) wire fixture: Black fixture lead to hot (black) POWERCORD lead; white fixture lead to neutral (white) POWERCORD lead. Attach green ground wire from BOTTOM PLATE to green ground wire from POWERCORD and ballast (if supplied).
5. Reinstall door and secure in place by tightening SCREW through TOP MOUNTING PLATE.
6. Install recommended lamp(s).

**CAUTION: MAXIMUM WATTAGE AS MARKED ON FIXTURE MUST NOT BE EXCEEDED.**

### REFLECTOR INSTALLATION:

1. To secure REFLECTOR to SPACER NECK, position MOUNTING SCREWS through KEYSLOTS and twist REFLECTOR counter-clockwise. Secure REFLECTOR in position by tightening MOUNTING SCREWS.

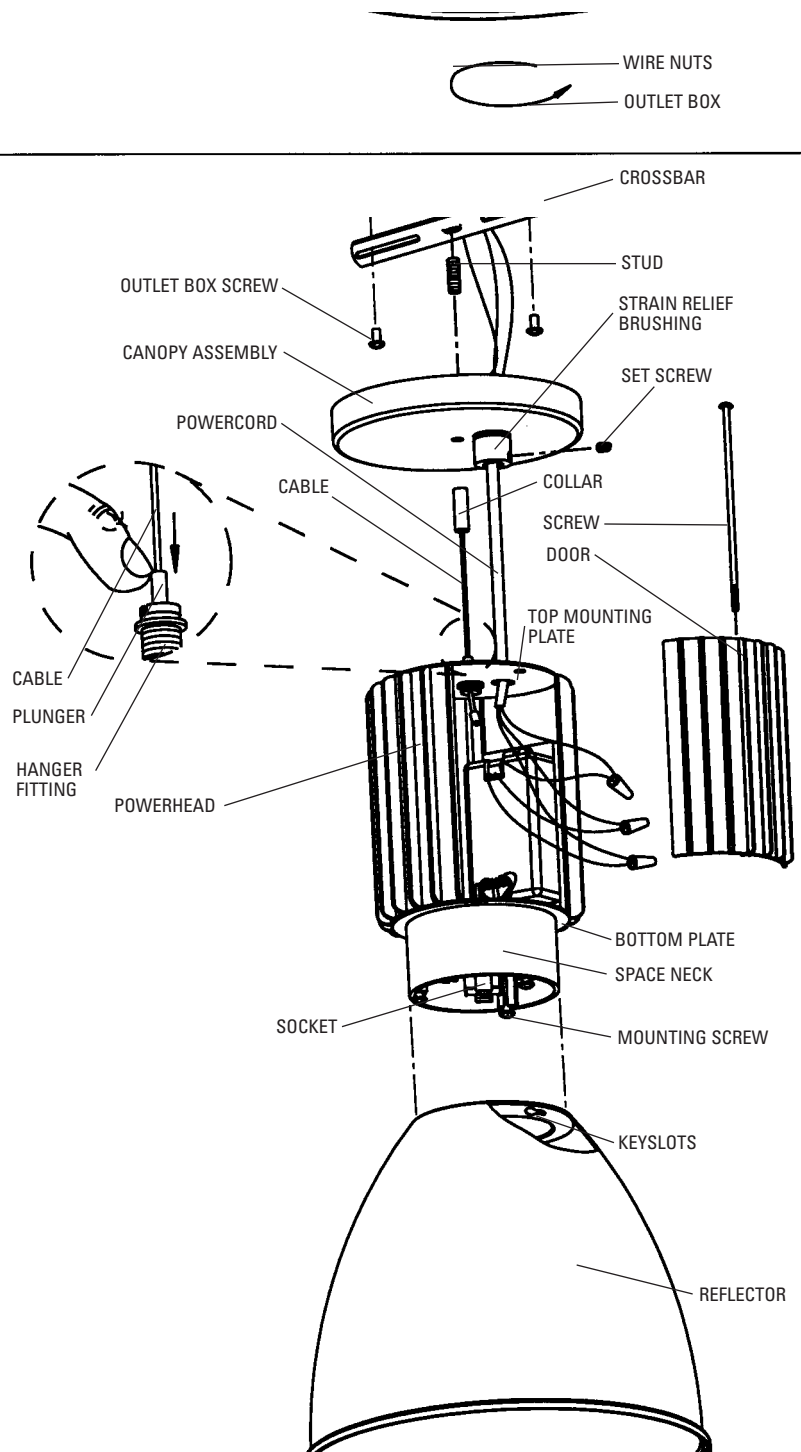

FIG. 1