

PHILIPS

Smart Balance

SM480C



220 V
240 V

50Hz
60Hz

IP40

IK02

GLOW
WIRE
650 °C

Max.
40 °C
Min.
10 °C



SM480C

4.6 kg

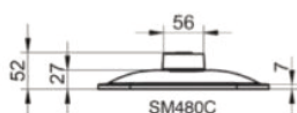

All dimensions are in mm.

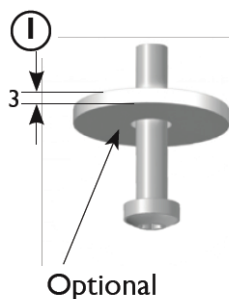
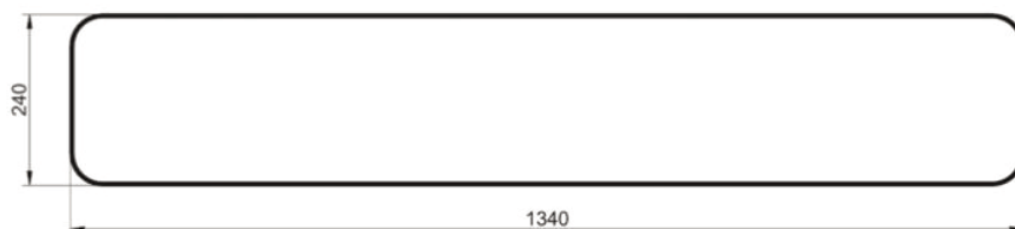
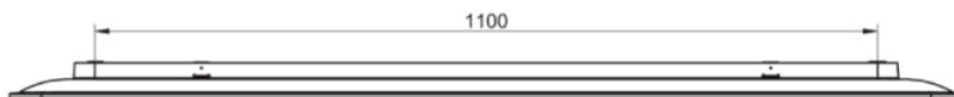

Optional

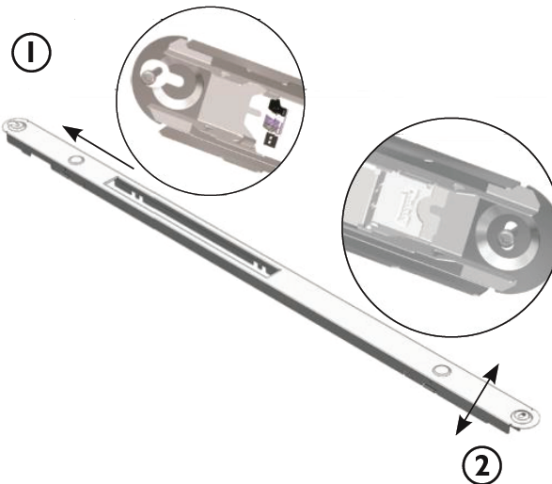

Optional

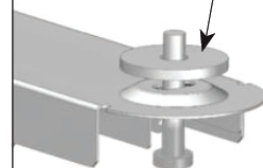

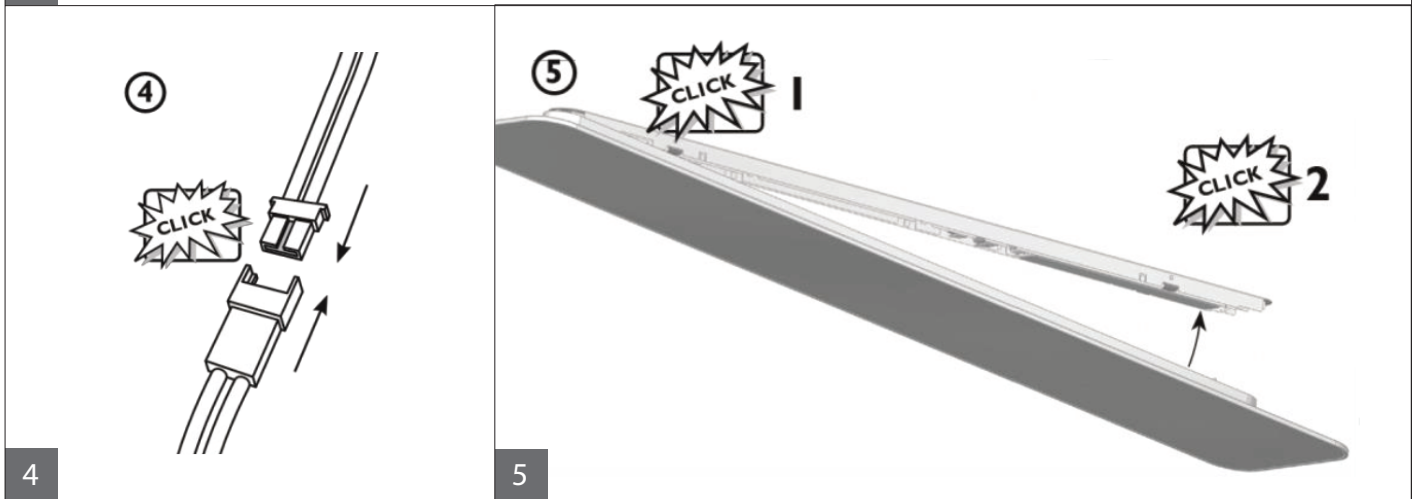
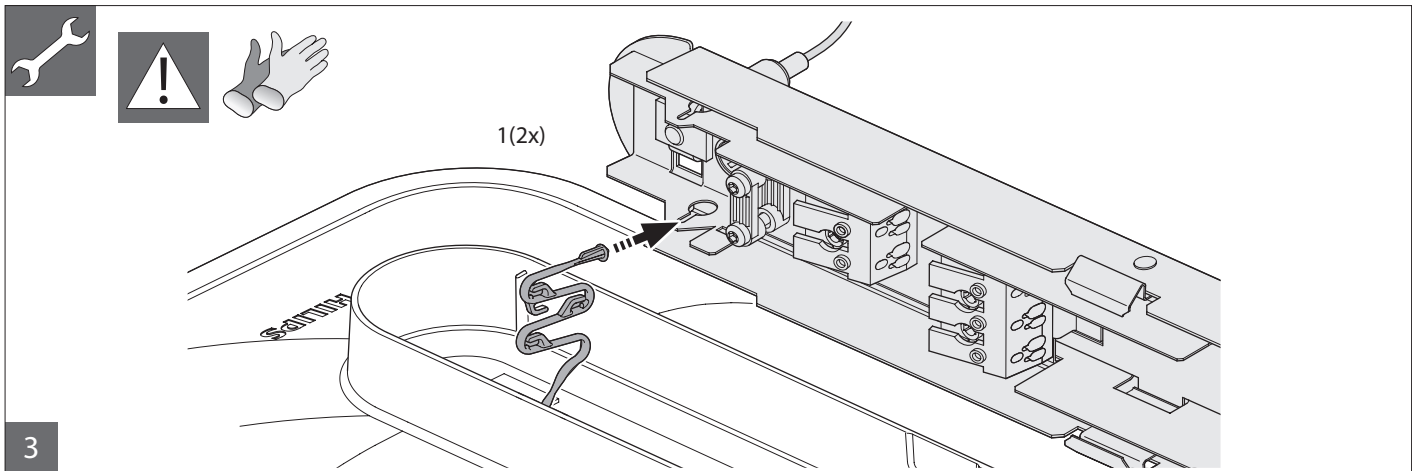
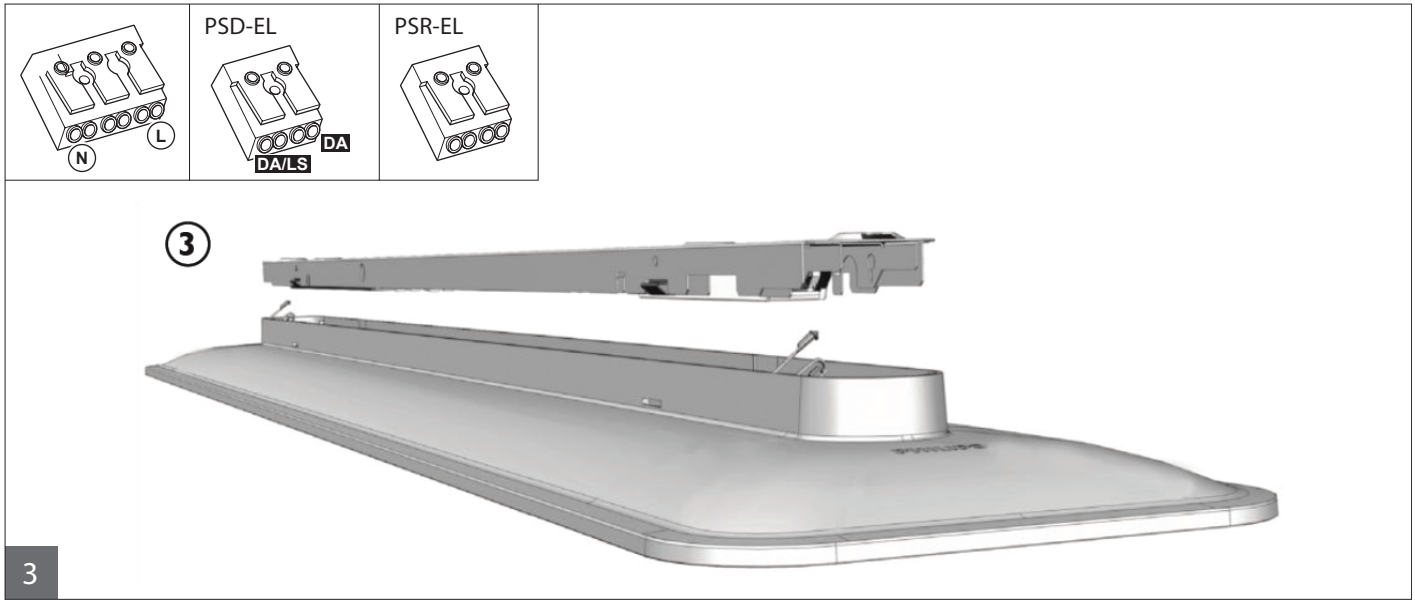

PoE

Condition Philips to specify to the customers (instruction):
 > to use UTP (Unshielded Twisted Pair) CAT5E or CAT6 cable
 > the maximum length of the cable to be 20 meters.
 Apply a minimum radius of the Ethernet cable of 4x the cable diameter.



To open

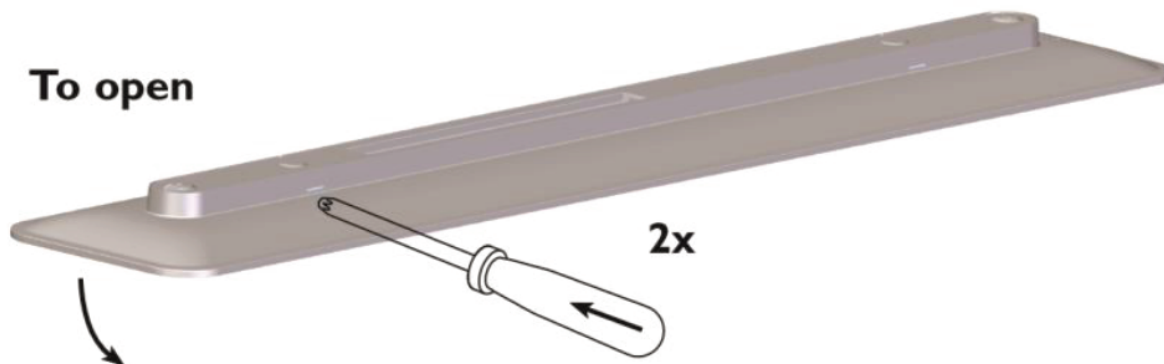

Maintenance instructions

To assure the lighting quality of this unique LED lighting concept there are only a few instructions regarding the maintenance of this luminaire:

Do not touch electronic components!

Electronic components are under high voltage. Electronic components are ESD sensitive.

During installation or when maintaining the luminaire always use static free gloves to avoid marks on the luminaire.

To remove dirt and spots use the following:

- o Dust: only use micro fiber cloths
- o Fingerprints, etc.: use a cleaner for synthetic materials with antistatic properties.

- ☐ Do not stare into the LED light beam.
- ☐ A SmartBalance luminaire with DALI driver also support Touch and Dim functionality.
- ☐ This luminaire should not be used for illumination during building activities due to dirt and dust contamination.



ACL
versions only

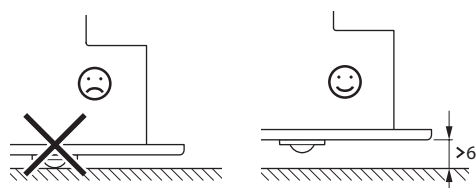

Inrush current

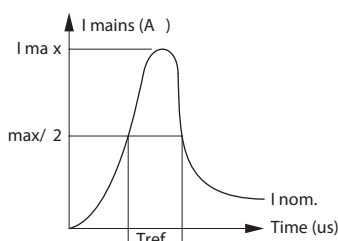

	Xitanium 200VTD 230V
	75W
	Electrical characteristics
I _{max} (A)	48
T _{ref} (μs)	180
EL I max. (mA)	0,7
	Luminaires Max.
MCB (16A-B)	20
EL CB 30mA	30

EL = Earth leakage