

READ AND UNDERSTAND THESE INSTRUCTIONS BEFORE INSTALLING FIXTURE

This fixture is intended for installation in accordance with the National Electrical Code and local regulations. To assure full compliance with local codes and regulations, check with your local electrical inspector before installation. To prevent electrical shock, turn off electricity at fuse box before proceeding.

Retain these instructions for maintenance reference.

INSTRUCTION SHEET NO.

IS:2000LVR

Page 1 of 2

INSTALLATION PROCEDURE FOR REMODELER KITS 2000LVR USE FOR 2000 SIZE TRIMS

EXISTING CONSTRUCTION

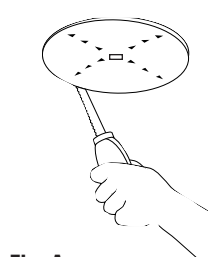

Fig. A
1. Cut Opening

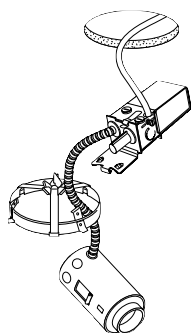

Fig. B
2. Wire-In

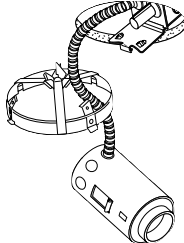

Fig. C
3. Anchor

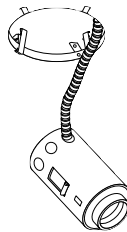

Fig. D
4. Attach Mounting Ring

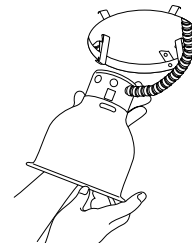

Fig. E
5. Snap-On

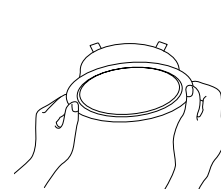

Fig. F
6. Push-Up

WARNING: (RISK OF FIRE) DO NOT INSTALL INSULATION WITHIN 3" OF FIXTURE SIDES OR WIRING COMPARTMENT, NOR ABOVE FIXTURE IN SUCH A MANNER SO AS TO ENTRAP HEAT.

1. CUT OPENING (Fig. A)

Use aperture sticker provided as a template to cut a hole in the ceiling. Cut to outside edge of sticker.

2. WIRE-IN (Fig. B)

Wire to SUPPLY LEADS. (For CABLE, use built-in CABLE CLAMP in J-BOX). WHITE FIXTURE LEAD to NEUTRAL SUPPLY LEAD. BLACK FIXTURE LEAD to HOT (120V) SUPPLY LEAD. BARE FIXTURE WIRE to SUPPLY GROUND. Use wirenuts (local hardware item). Place all electrical connections in the J-BOX. Attach J-BOX cover onto J-BOX. For flexible CONDUIT use 90° connector (not supplied) (Fig. G) or 3/8" SPRING CONNECTOR (provided) (Fig. H). If 3/8" SPRING CONNECTOR is used, place J-BOX and TRANSFORMER ASSEMBLY onto ceiling, attach CONNECTOR to CONDUIT and push into one of the 7/8" dia. knock out holes in J-BOX. Pull J-BOX and TRANSFORMER ASSEMBLY toward ceiling opening (as shown in Fig. B) and complete wiring.

3. PUT THRU AND ANCHOR (Fig. C)

1. Place J-BOX PLATE onto ceiling and push NAIL TAB into ceiling.
2. Push LONG LEGS of NAIL CLIPS (supplied in parts bag) into RAISED BUMP of J-BOX PLATE and SHORT LEG into ceiling. (Fig. I)

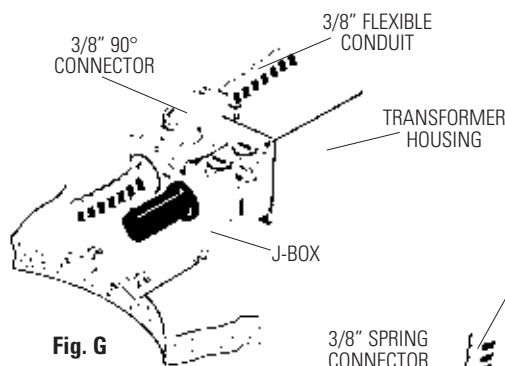

Fig. G

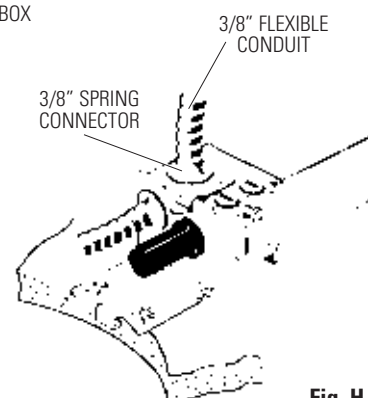

Fig. H



Fig. I

**PHILIPS
LIGHTOLIER**

Philips Lighting North America Corporation
200 Franklin Square Drive
Somerset, NJ 08873, USA
Phone: 855-486-2216

Philips Lighting Canada Ltd.
281 Hillmount Road
Markham ON, Canada L6C 2S3
Phone: 800-668-9008

READ AND UNDERSTAND THESE INSTRUCTIONS BEFORE INSTALLING FIXTURE

This fixture is intended for installation in accordance with the National Electrical Code and local regulations. To assure full compliance with local codes and regulations, check with your local electrical inspector before installation. To prevent electrical shock, turn off electricity at fuse box before proceeding.

Retain these instructions for maintenance reference.

INSTRUCTION SHEET NO.

IS:2000LVR

Page 2 of 2

4. ATTACH MOUNTING RING (Fig. D)

IMPORTANT: If using TRIMS 2022LV, 2024LV, or 2004 Series, discard MOUNTING RING and follow Steps in 4A.

Push MOUNTING RING into opening until FLANGE sits against ceiling. Slide MOUNTING STRAPS down to trap ceiling thickness and then bend up to secure.

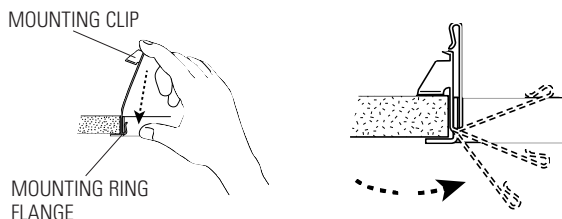

5. SNAP-ON (Fig. E)

SEE SEPARATE

6. PUSH-UP (Fig. F)

REFLECTOR TRIM
INSTRUCTION SHEETS.

7. LAMPING (Fig. L)

1. Make sure that power is **OFF** when lamping or relamping. Remove LAMP RING from SOCKET CUP by pulling straight down.
2. Insert LAMP (MR16 bulb) between LAMP SPRINGS until face of bulb sits firmly on GLASS LAMP GUARD. (Fig. L)
3. Attach SOCKET to bi-pin prongs on LAMP.
4. Insert LAMP RING with LAMP and GLASS LAMP GUARD back into SOCKET CUP.

WARNING:

1. LAMP MANUFACTURERS REQUIRE THE GLASS LAMP GUARD BE IN PLACE BEFORE ENERGIZING LAMP, AND THAT GREAT CARE MUST BE TAKEN THAT LAMP IS FULLY COOLED BEFORE RELAMPING. AVOID FINGER MARKS ON INSIDE OF LAMP FOR THEY MAY CAUSE SHORT LAMP LIFE AND POSSIBLE BREAKAGE.

2. USE ONLY REFLECTOR TRIMS PROVIDED BY LIGHTOLIER, INC. THE USE OF OTHER MANUFACTURER'S REFLECTOR TRIMS VOIDS THE UNDERWRITERS LABORATORIES LISTING AND COULD CONSTITUTE A FIRE HAZARD.

8. ADJUSTMENT (Fig. M)

1. For vertical adjustment insert blade of screwdriver into the open slot of YOKE.
2. Using the screwdriver as a lever, tilt the entire LAMP HOLDER to the desired angle.
3. For horizontal adjustment, rotate the LAMP HOLDER.

NOTE:

1. LOW VOLTAGE FIXTURES should be dimmed only with special dimmers intended specifically for that purpose. Use Lightolier Lytemode, Scenist, Crescendo VA, Neptune VA, Precision VA, Easyset VA, Sunrise VA, Radiant VA or autotransformers or electronic dimmers intended for use with low voltage fixtures.
2. LOW VOLTAGE FIXTURES may produce audible sound when used with dimmers, which may be objectional in acoustically critical areas.

4A. PUSH-UP AND CLIP-ON

1. CLIP is inserted from inside housing, through "T" slot.
2. Downward force is then applied, with screwdriver on top of CLIP or engaged in SCREWDRIVER SLOT in CLIPS FLANGE.
3. Force is applied until CLIP is snugly seated.

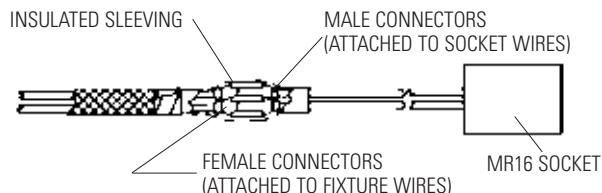
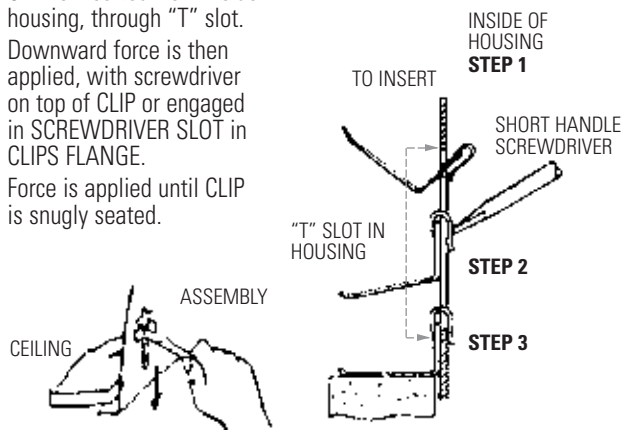

Fig. K

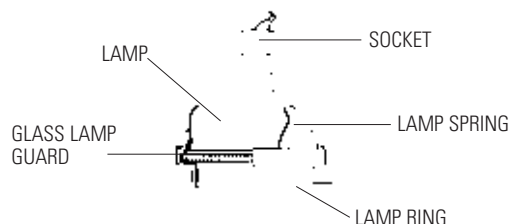

Fig. L

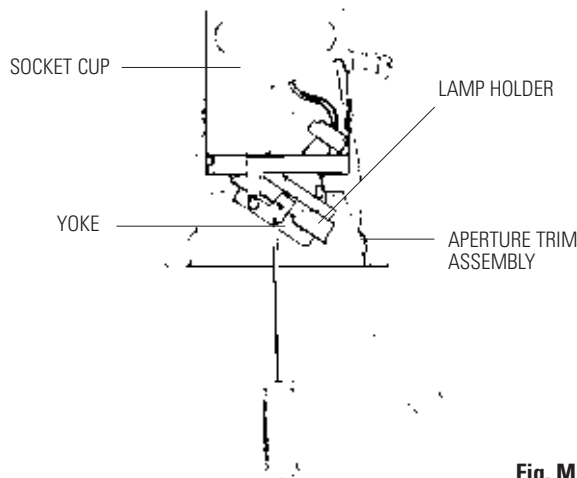

Fig. M

PHILIPS LIGHTOLIER

Philips Lighting North America Corporation
200 Franklin Square Drive
Somerset, NJ 08873, USA
Phone: 855-486-2216

Philips Lighting Canada Ltd.
281 Hillmount Road
Markham ON, Canada L6C 2S3
Phone: 800-668-9008