

**Read and understand these instructions before installing luminaire (fixture) .**

This luminaire is intended for installation in accordance with the National Electrical Code and local regulations. To assure full compliance with local codes and regulations, check with your local electrical inspector before installation. To prevent electrical shock, turn off electricity at fuse box before proceeding. Allow fixture to cool before handling.

**Retain these instructions for maintenance reference.**

INSTRUCTIONS FOR REFLECTORS 24MHT4RS, 24MHT4RSCCZ, 24MHT4RNF, 24MHT4RNFCCZ, 24MHT4RF, 24MHT4RFCCZ, 24MHT45RS, 24MHT45RSCCZ, 24MHT45RNF, 24MHT45RNFCCZ, 24MHT45RF, 24MHT45RFCCZ, 24MHT4RSWRM, 24MHT4RNFWRM, 24MHT4RFWRM, 24MHT45RSWRM, 24MHT45RNFWRM, 24MHT45RFWRM

COMPATIBILITY	
REFLECTOR NUMBER	LUMINAIRE CATALOG NUMBER. NUMBER WILL BE FOLLOWED WITH A FINISH SUFFIX SUCH AS WH, BK, AL TO NAME A FEW.
24MHT4RS, 24MHT4RSCCZ, 24MHT4RNF, 24MHT4RNFCCZ, 24MHT4RF, 24MHT4RFCCZ, 24MHT4RSWRM, 24MHT4RNFWRM, 24MHT4RFWRM	8109, 8111, 8112
24MHT45RS, 24MHT45RSCCZ, 24MHT45RNF, 24MHT45RNFCCZ, 24MHT45RF, 24MHT45RFCCZ, 24MHT45RSWRM, 24MHT45RNFWRM, 24MHT45RFWRM	8114, 8115

**REFER TO INSTRUCTION SHEET INCLUDED WITH LUMINAIRE FOR LAMPING AND LUMINAIRE OPERATION.**

**INSTRUCTIONS FOR INSTALLING THE REFLECTOR.**

*Note: Handle the reflector with clean gloves or plastic film to avoid fingerprints.*

1. Unscrew the 2 KNURLED KNOBS from the HOUSING.
2. Remove the COVER from the HOUSING.
3. Unscrew the HOLDER SCREWS.
4. Install the REFLECTOR, securing with HOLDER SCREWS.
5. Assemble COVER to HOUSING.
6. Secure with KNURLED KNOBS.

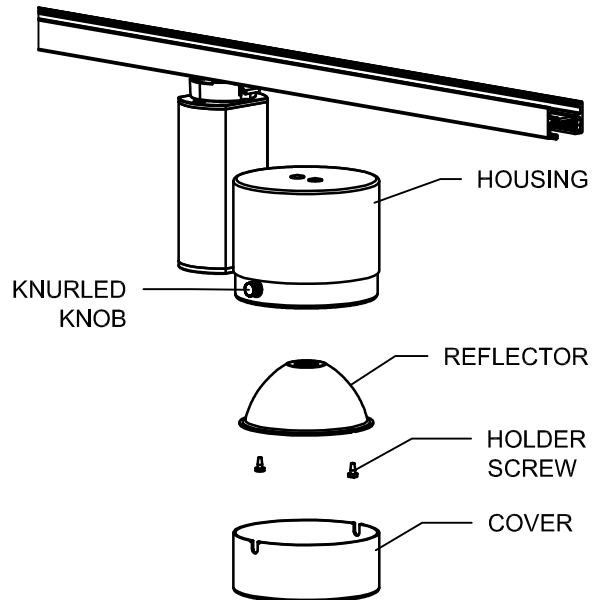

© 2016 Philips Lighting Holding B.V. All rights reserved.  
Specifications are subject to change without notice.  
[www.philips.com/luminaires](http://www.philips.com/luminaires)

IS:RFMH Feb-16 page 1 of 1

Philips Lighting North America Corporation  
200 Franklin Square Drive  
Somerset, NJ 08873 USA  
Phone: 855-486-2216

Philips Lighting Canada Ltd.  
281 Hillmount Road  
Markham ON, Canada L6C 2S3  
Phone: 800-668-9008