

PHILIPS

Maxos LED General Lighting

4MX400

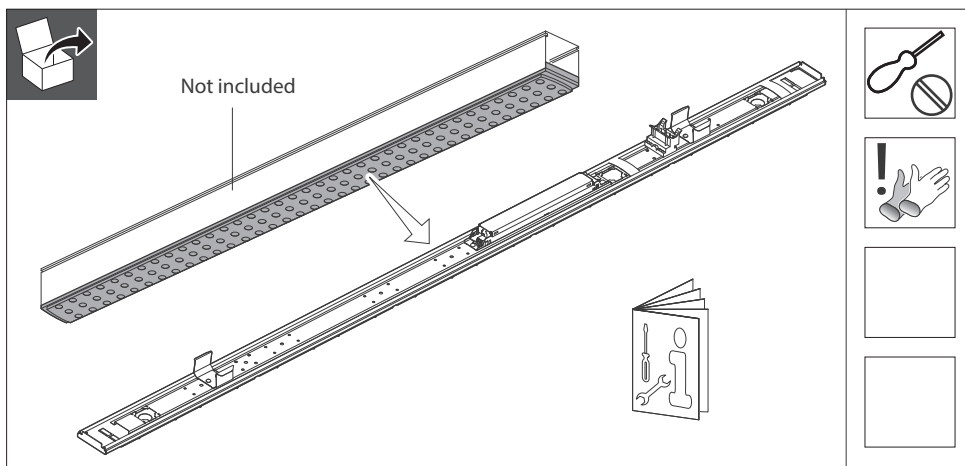

220V
240V

50Hz
60Hz



LEDs

IP20



GLOW
WIRE
650 °C



	LEDs	CCT	Type	A	kg		
4MX400			491	1475	1.80		
4MX416	40S/55S/66S/80S	830/840	581	1528	1.85		
4MX433							

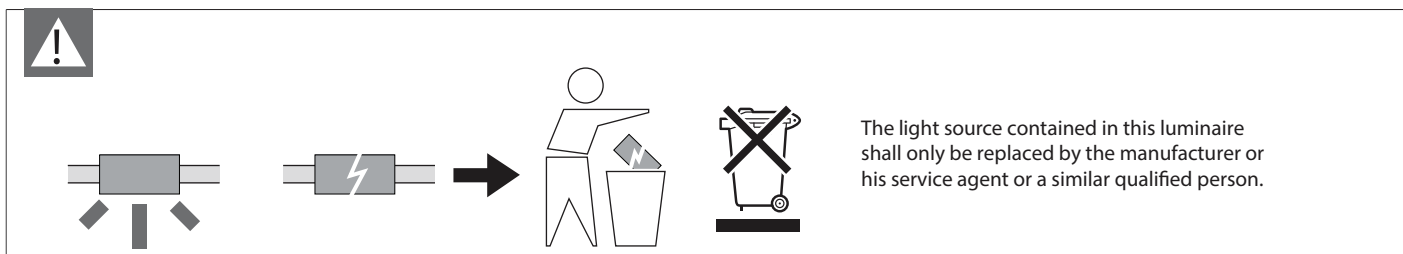
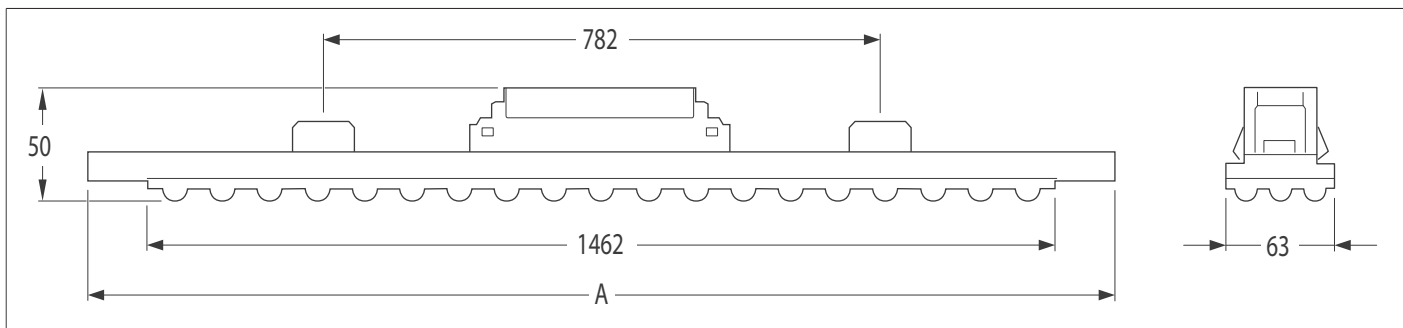

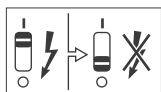

Trunking TTX400
(not included)

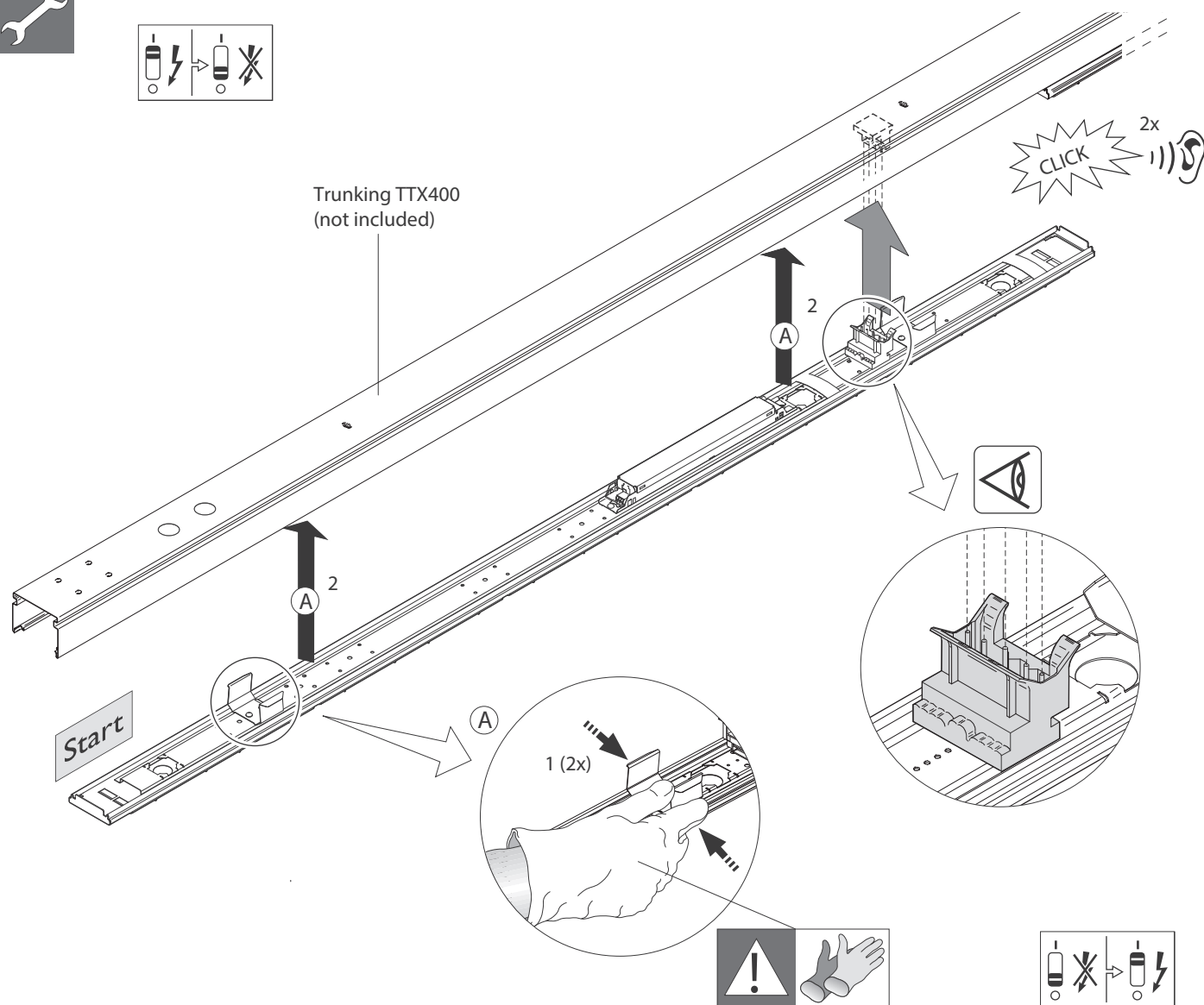

Service

Trunking section module type	L [mm]	
	491	581
Standard	380-400	265-280
Asymmetric	390-410	265-280
Emergency Light	130-150	160-180

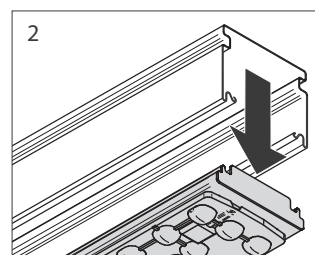
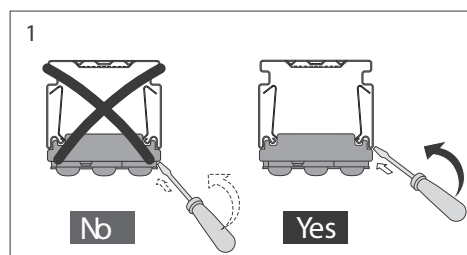
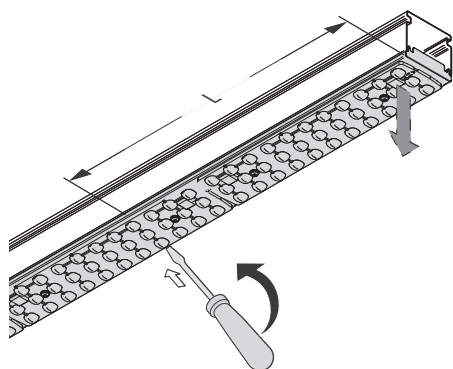



Way of retrofit

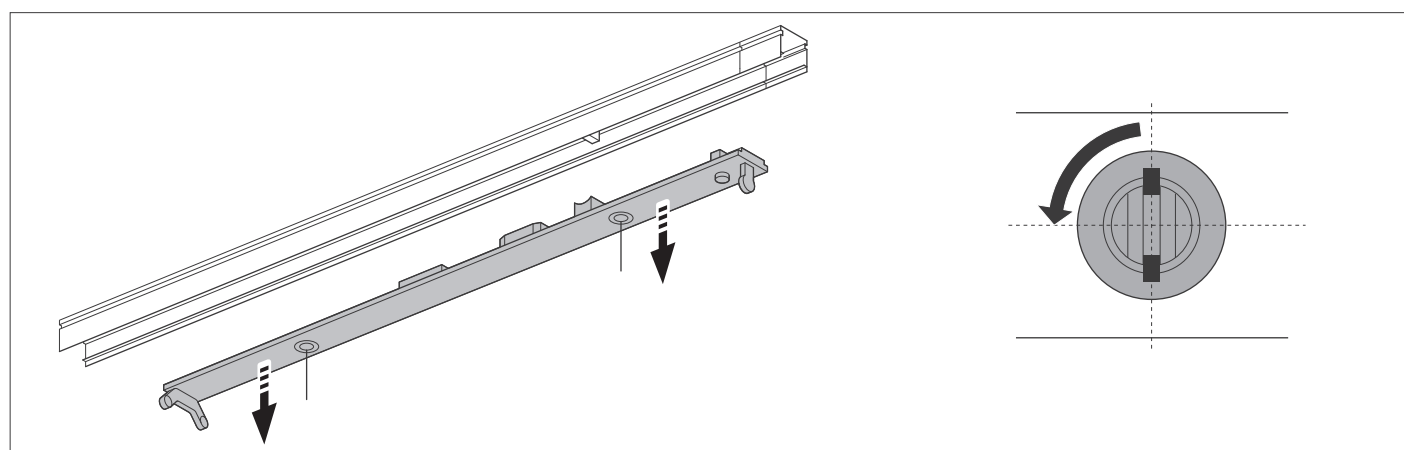
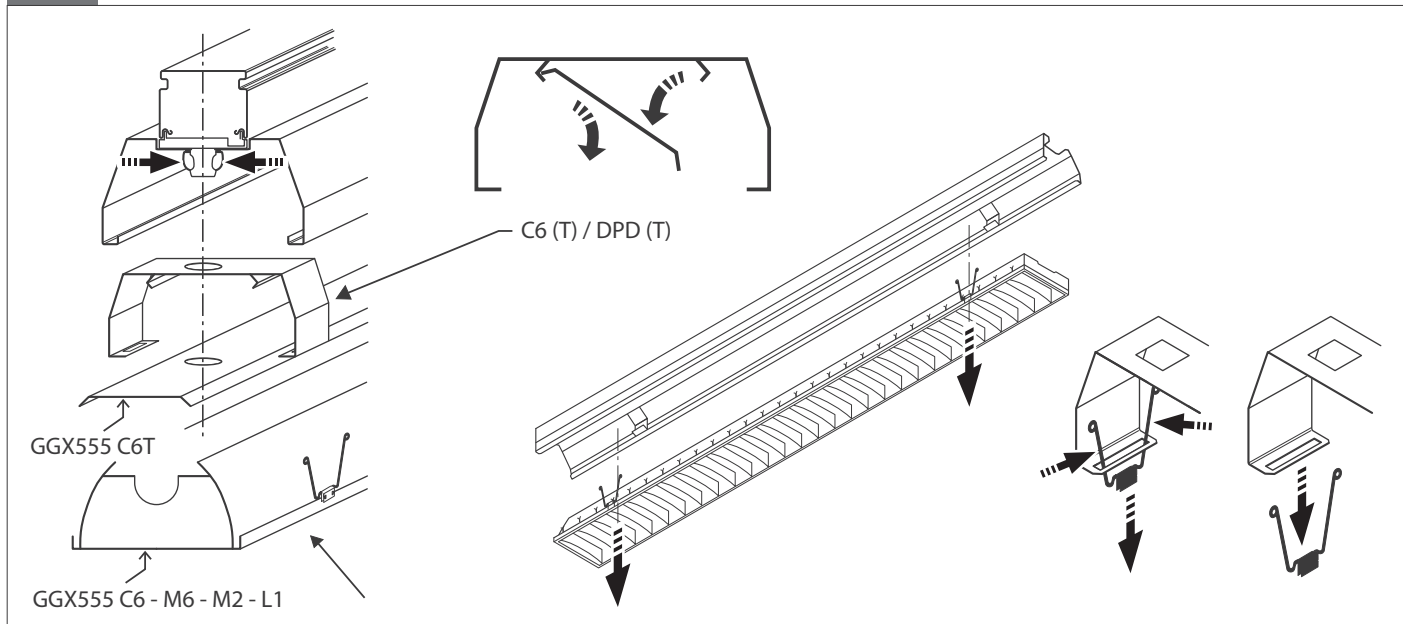

Option: DALI C-2R

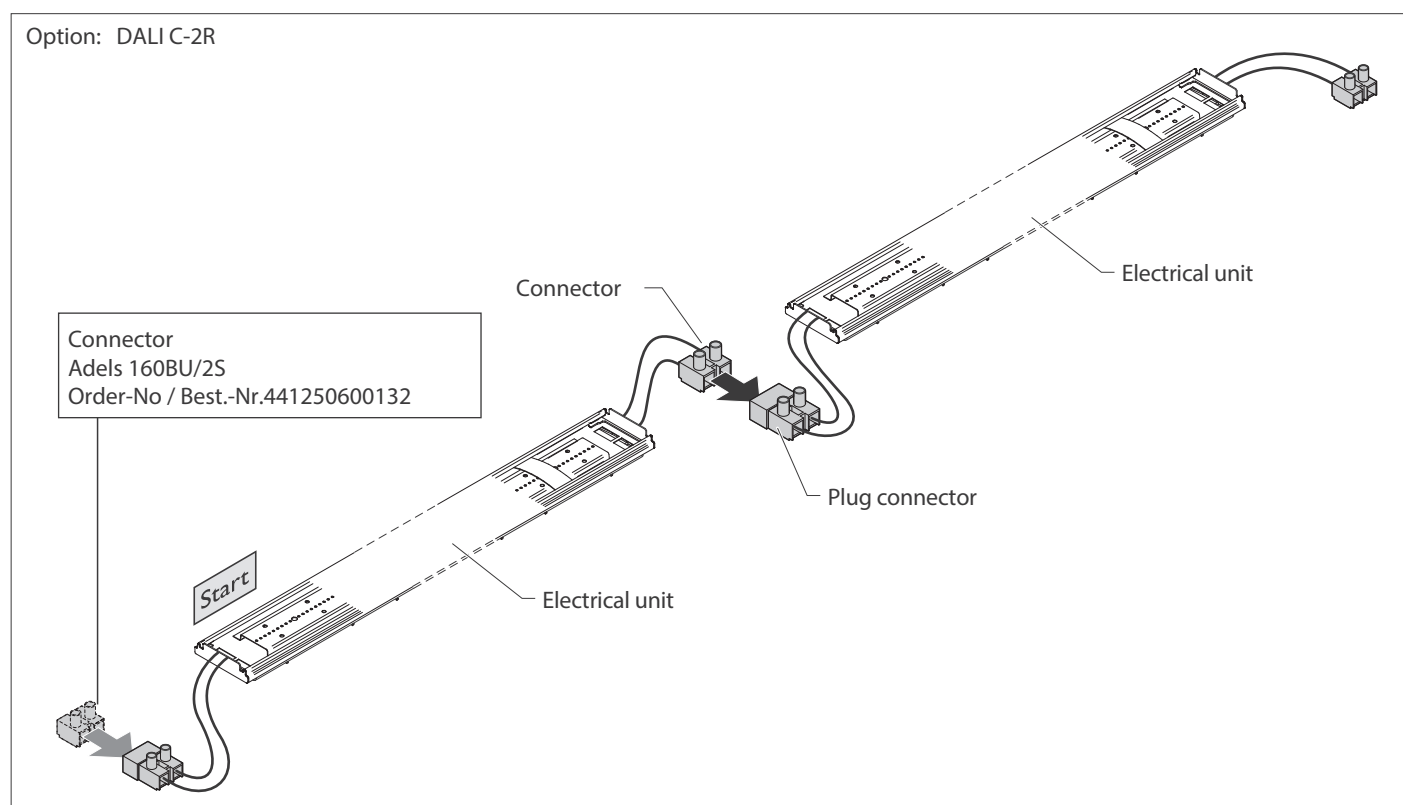

Given the choices made in this unique lighting concept, there are a few instructions regarding the maintenance.

- Prevent water from entering on or in the luminaire at installation and during use of the luminaire
- During installation or maintaining the luminaire please use gloves to avoid spots on the cover.
- Do not clean with a dry cloth as it will cause the product to attract dust. Dirty spots can be removed:
Only dust: use a damp cloth (no dripping water), preferably anti-static.
Fingerprints etc: use a damp cloth (no dripping water) with a cleaner appropriate for polycarbonate/PMMA plastics
- Do not touch electronic components as they are ESD sensitive.
- Do not stare into LED beam.
- Luminaire should not be used for illumination during building activities. due to dust accumulation inside the luminaire.

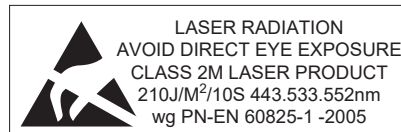
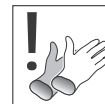

Inrush current

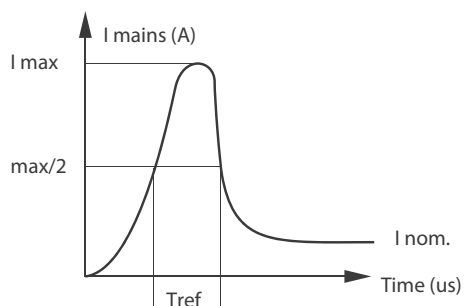

	PSD	PSU
I _{max} (A)	21	17,8
T _{ref} (μs)	280	282
MCB	Drivers Max.	
B-10 A	14	14
B-16 A	24	24
C-10 A	24	24
C-16 A	40	40



© 2019 Signify Holding

All rights reserved. This document contains information relating to the product portfolio of Signify which information may be subject to change. No representation or warranty as to the accuracy or completeness of the information included herein is given and any liability for any action in reliance thereon is disclaimed. The information presented in this document is not intended as any commercial offer and does not form part of any quotation or contract. Philips and the Philips Shield Emblem are registered trademarks of Koninklijke Philips N.V.. All other trademarks are owned by Signify Holding or their respective owners.

Signify Holding.
The Netherlands