

PHILIPS

LUXSPACE2 PoE

DN560B/561B/570B/571B/572B



DN560B/561B
DN570B/571B

DN572B

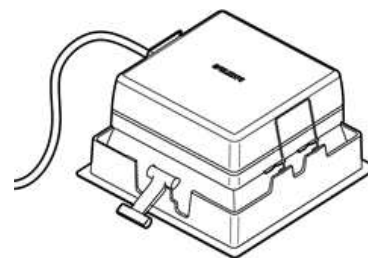
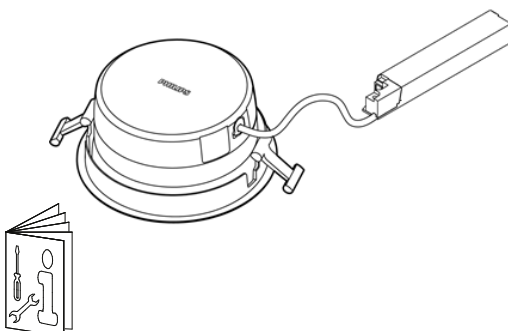

IP20

GLOW
WIRE
650 °C



| | | A | B | C | CCT/CRI | P | P max | |
|----------------------|--------|-------|-------|------|---------|--------|-------|---------|
| DN560B/DN561B | LED8S | 250mm | 550mm | ≥3mm | 830/840 | 8 W | 8,8 W | 0,72 kg |
| DN560B/DN561B | LED12S | 250mm | 550mm | ≥3mm | 830/840 | 11,6 W | 13 W | 0,72 kg |
| DN570B/DN571B/DN572B | LED12S | 300mm | 700mm | ≥3mm | 830/840 | 11 W | 12 W | 1,17 kg |
| DN570B/DN571B/DN572B | LED20S | 300mm | 700mm | ≥3mm | 830/840 | 17,6 W | 19,4W | 1,17 kg |
| DN570B/DN571B/DN572B | LED24S | 300mm | 700mm | ≥3mm | 830/840 | 21,8W | 24W | 1,17 kg |

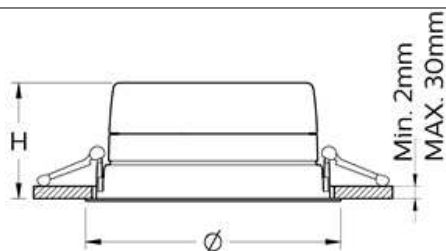

| | H [mm] | Ø [mm] | mm |
|--------|--------|--------|-----|
| DN560B | 72 | 164 | 150 |
| DN561B | 86 | 164 | 150 |
| DN570B | 96,5 | 214 | 200 |
| DN571B | 119 | 214 | 200 |

| | H [mm] | □ | mm |
|--------|--------|-----|-----|
| DN572B | 119 | 214 | 200 |

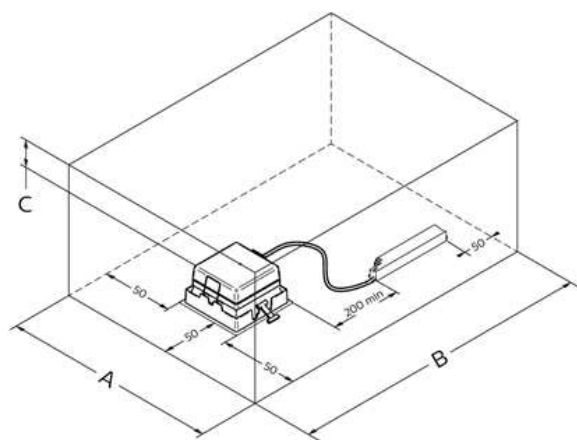
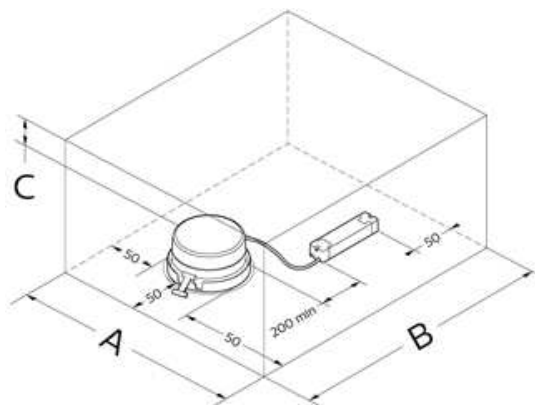
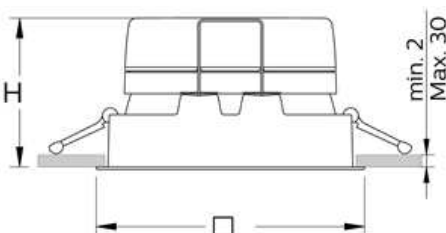

4443 160 19651

© / 2016, Philips Lighting Holding B.V. All rights reserved

2/1

Printed in ...
Data subject to change without notice
Keep for future reference: www.philips.com/lighting

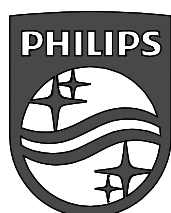
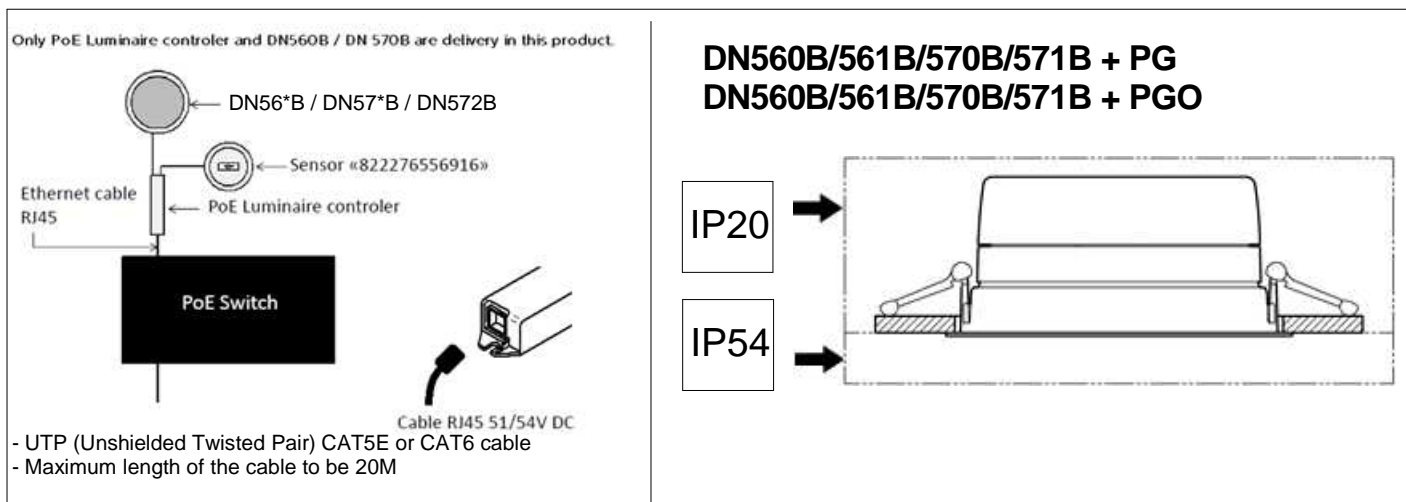
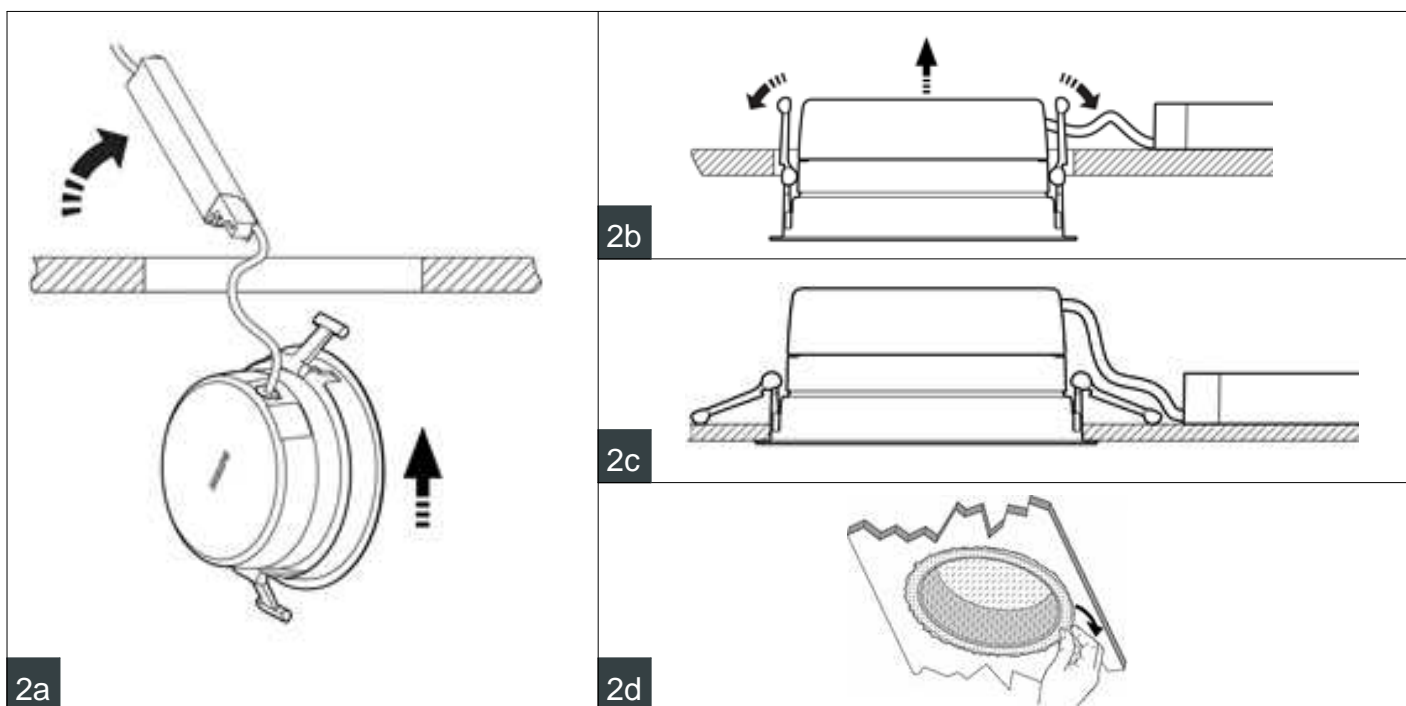
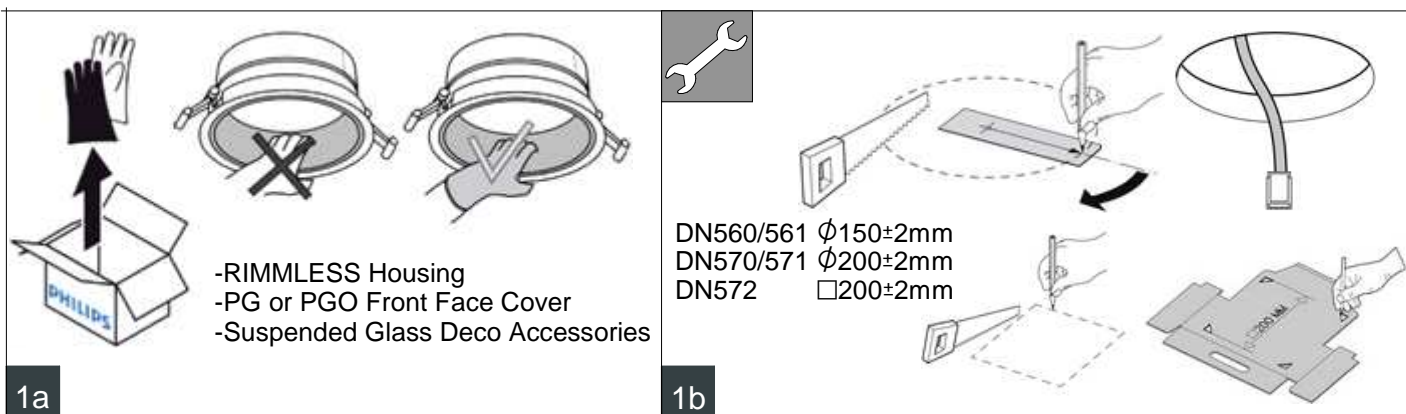

©2017 Philips Lighting Holding B.V.
 All rights reserved. Reproduction in whole or in part is prohibited without the prior written consent of the copyright owner.
 The information presented in this document does not form part of any quotation or contract, is believed to be accurate and reliable and may be changed without notice. No liability will be accepted by the publisher for any consequence of its use.
 Publication thereof does not convey nor imply any license under patent- or other industrial or intellectual property rights.

Philips Lighting Holding B.V.
 The Netherlands