

**Read and understand these instructions before installing luminaire.**

This luminaire is intended for installation in accordance with the National Electrical Code and local regulations. To assure full compliance with local codes and regulations, check with your local electrical inspector before installation. To prevent electrical shock, turn off electricity at fuse box before proceeding.

**Retain these instructions for maintenance reference.**

## **PowerTrip™ CONNECTOR FXS99 FOR USE WITH FXS SERIES SUSPENDED MOUNT TANGENT™ TRACK, PLD SERIES POWERTRIP BREAKERS ONLY, AND FXS SERIES CABLE OR STEM KITS.**

### **NOTE:**

CABLE OR STEM KITS ARE OPTIONAL.

POWERTRIP CONNECTOR CAN BE FED USING A JUNCTION BOX. FED DIRECTLY USING FLEXIBLE OR RIGID CONDUIT WITH  $\frac{3}{8}$  OR  $\frac{1}{2}$  ELECTRICAL CONNECTOR FROM STANDARD CEILINGS OF GRID CEILINGS RUNNER SYSTEMS.

- **TURN POWER AT BREAKER BOX BEFORE INSTALLING ELECTRICAL CONNECTOR AND TRACK.**
- **CORD IS NOT TO BE USED TO SUPPORT TRACK LOAD. USE STEMS OR CABLES.**
- **IF FEEDING WITH ELECTRICAL CONNECTORS: DO NOT USE POWERTRIP AS A CONDUIT SUPPORT. INDEPENDANT CONDUIT SUPPORTS MUST BE USED TO ATTACH THE CONDUIT TO THE BUILDING STRUCTURE.**
- **USE 12 GA. OR 14 GA. SOLID WIRE IN CONNECTOR ONLY. CONNECTOR RATING 120V. 20AMP, 60HZ.**
- **USE THE PROPER CURRENT RATED LIGHTOLIER PLD SERIES BREAKER TO LIMIT THE LOAD ON THE CIRCUIT. (BREAKERS SOLD SEPERATELY)**

### **A. INSTALLING SUSPENDED POWERTRIP FEED (FXS99) TO JBOX**

1. Remove CENTER KNOCK OUT from MOUNTING PLATE.
2. Install MOUNTING PLATE to JUNCTION BOX.
3. Pass LINE, NEUTRAL, and GROUND LEADS through middle knockout in center of MOUNTING PLATE. (Use Solid 12 AWG or 14 AWG copper supply only, DO NOT USE stranded wire).
4. Insert BREAKER (**PURCHASED SEPERATELY**) into MOUNTING PLATE in rectangular opening on the flange.
5. Take the LINE (bk lead) from the JUNCTION BOX and strip back the wire  $\frac{7}{16}$  and splice to one of the black leads of the BREAKER TERMINAL (Fig. 2).
6. Then take the GROUND (green or bare copper wire) and strip back enough to place on one side of one #8 GND SCREW. Also use green or bare copper wire to PIGTAIL 6 in off one of the remaining #8 GND SCREW (Fig. 2).  
**Notes: Each ground terminal accepts one wire only.**
7. SUPPLY WIRE HARNESS is supplied in 10' length for use with 8' CABLE or STEM supports. For shorter drops, lay out appropriate length. Cut SUPPLY WIRE HARNESS to desired length plus 1 foot. Example: For 48" STEM, INSTALLER desires 5' SUPPLY WIRE HARNESS length for WIRE management. Cut SUPPLY WIRE HARNESS 6' long (5' + 1').

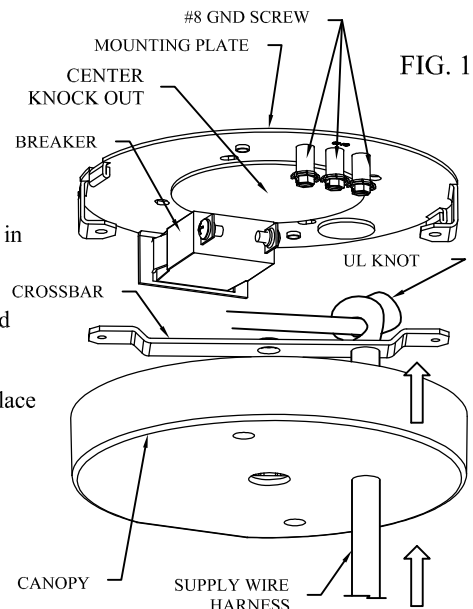

8. Pass SUPPLY WIRE through the CANOPY and the CROSSBAR using the hole that is offset to the side of center. (Fig.1)
9. Tie UL KNOT above CROSSBAR for STRAIN RELIEF. Leave 9" of SUPPLY WIRE HARNESS beyond KNOT.
10. Slit and open METALLIC SHEATHING to expose MIN 6" LEAD LENGTH for SUPPLY CONNECTIONS.

11. Splice SUPPLY LEADS from SUSPENDED POWER FEED to BRANCH CIRCUIT LEADS (BLACK to BLACK breaker lead, WHITE to WHITE, GREEN to GROUND SCREW and METALLIC SHEATHING to GND SCREW  
NOTE: KEEP GROUND WIRE, AND METAL SHEATHING AWAY FROM BREAKER TERMINALS.

FIG. 2

12. Tuck SUPPLY CONNECTIONS in JBOX.

13. Secure CROSS BAR to MOUNTING PLATE with screws provided.  
**NOTE: CROSSBAR should sit on top of EARS on MOUNTING PLATE. (Fig 5)**

14. Bring CANOPY up and put in place and fasten with TORX screws that are provided.

15. Install suspend track. (See Instruction Sheet IS:FXS04 section A.)

### B. ELECTRICAL CONNECTION AT TRACK

1. Unscrew and remove COVER from FEED. (Retain screws for securing cover after installation).
2. Clamp FEED HALVES into track. Ensure GROUND CONTACT is inserted into groove containing polarity dimples and NEUTRAL FEED HALF is inserted in channel WITHOUT polarity dimples (Fig. 3).
3. Replace SLEEVE. (Fig. 3).
4. Replace COVER on FEED and tighten screw (Fig. 4).

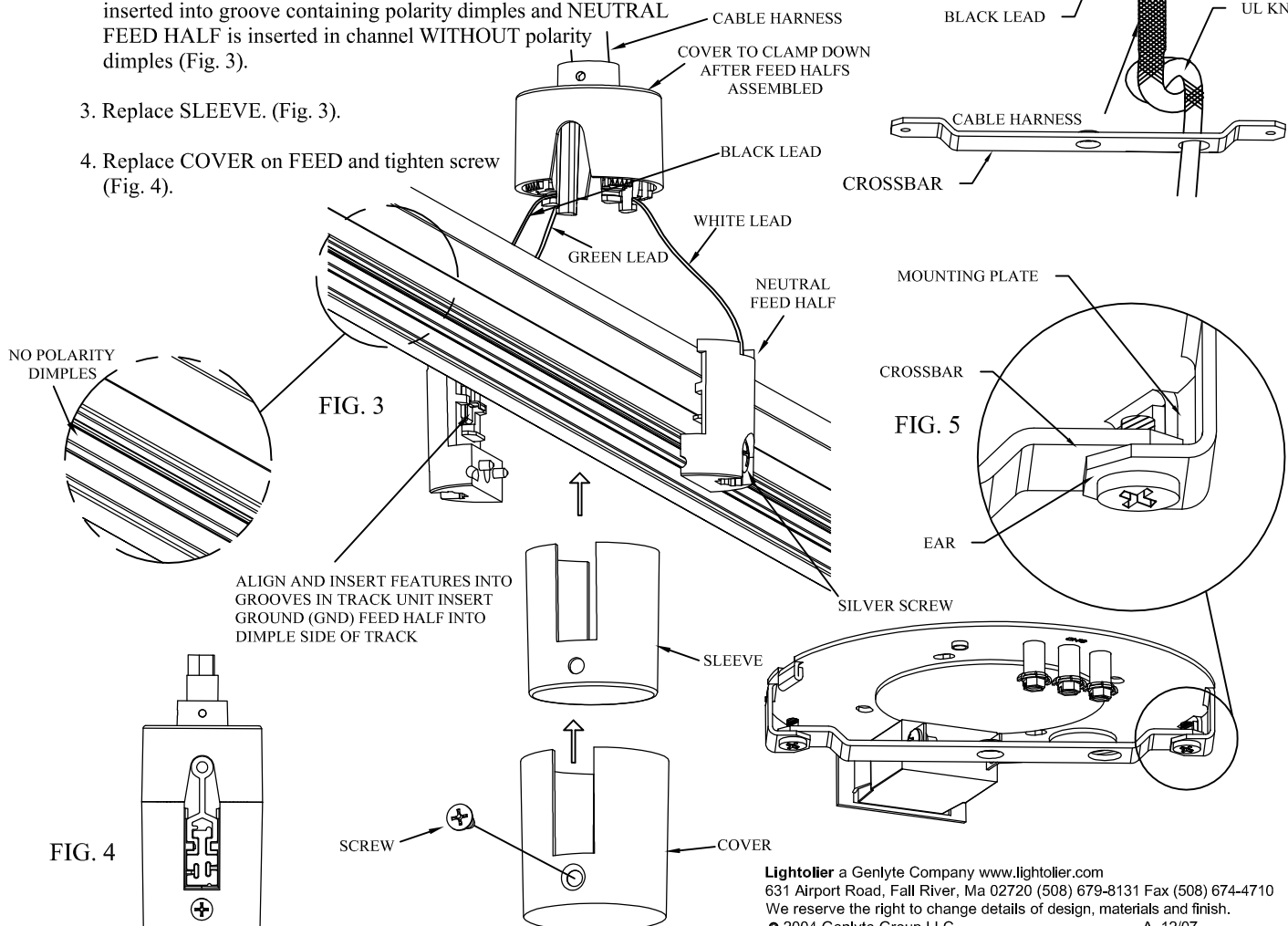

## C. INSTALLING POWERTRIP FEED (FXS99 TO DIRECT FEED CONDUIT CONNECTION ON DRYWALL CEILING

1. Cut out template located on last page of instruction sheet of POWERTRIP FEED (FXS99) and orient on ceiling for mounting position.
2. Punch out  $\frac{7}{8}$ " knockout on MOUNTING PLATE and attach conduit fitting connection (by others) to MOUNTING PLATE.
3. Cut hole in drywall for conduit fitting and wires. (See template for hole location.)
4. Pass LINE, NEUTRAL, and GROUND supply leads through  $\frac{7}{8}$ " knockout and secure connection (supplied by others) and fasten with min. 6" leads coming out past MOUNTING PLATE. (Use Solid 12 AWG or 14 AWG. copper supply only, DO NOT USE stranded wire).
5. Secure MOUNTING PLATE to drywall ceiling with appropriate mounting hardware (not provided).
6. Then follow instructions from A-4 to B-4 for wiring connections.

## D. USING MECHANICAL SUSPENSION (CABLE/STEMS)

NOTE: Suspension kits FXS68; FXS84; & FXS86 can be used with FXS99 but are PURCHASED SEPARATELY .

1. When powertrip FXS99 is fully assembled and wired together use toggle that is supplied through one of the suspension kits noted above and fasten it into CROSSBAR through the CANOPY's thru hole located at the center of the CANOPY. (Fig. 6)
2. Then follow instructions on instruction IS:FXS04 that comes with suspension kit to apply mounting to the track.

## E. USING AS ELECTRICAL CONNECTION ONLY.

1. Use plug provided to fill in center thru hole on CANOPY by screwing it into the CROSSBAR through the CANOPY. (Fig 7)

