

Philips Luma BGP615/BGP621/BGP623/BGP625/BGP627

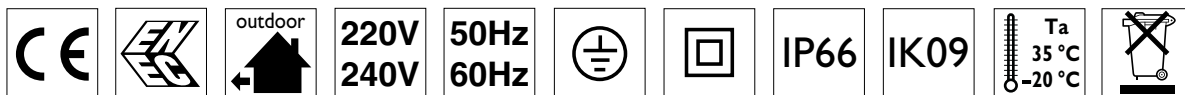

	LEDs	P(W)	P(W)	m ²	Cxs(m ²)	Dimensions in mm					kg
						A	B	C	D		
Luma Micro BGP615	12-20	7-41	9-46	0,049	0,049	551	622	290	32-60	4-6m.	7,5
Luma Mini(lite) BGP621(620)	12-40	7-85	9-95	0,055	0,055	649	720	310	32-60	4-6m.	9,5
Luma 1(lite) BGP623(622)	20-80	12-172	16-192	0,057	0,057	649	720	435	32-60	8-10m.	11,0
Luma 2(lite) BGP625(624)	60-120	34-255	40-278	0,067	0,066	799	876	435	42-60	8-18m.	15,5
Luma 3(lite) BGP627(626)	100-200	58-420	68-454	0,079	0,077	999	1076	435	42-60	10-18m.	20,5

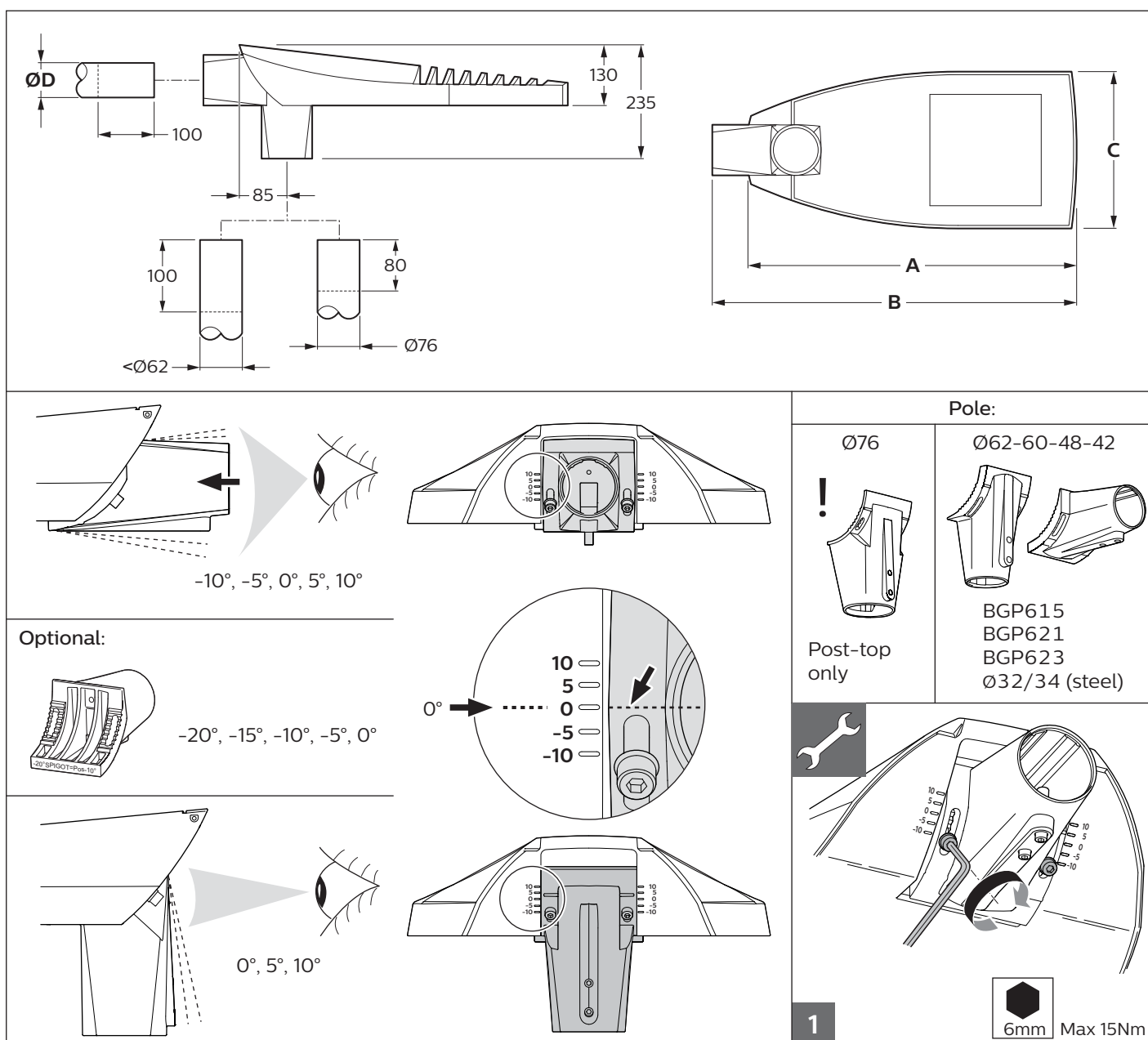

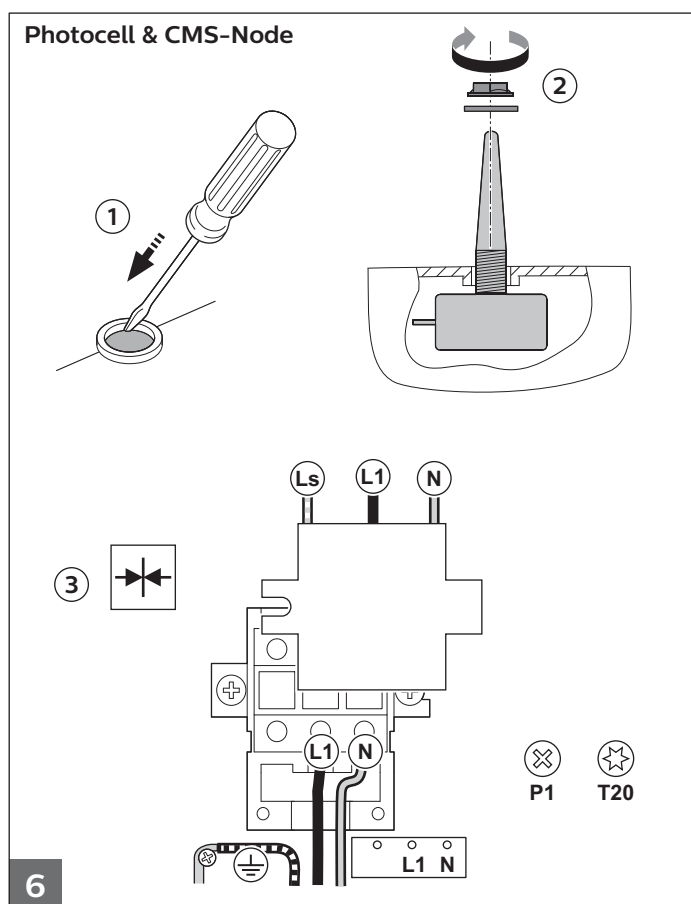
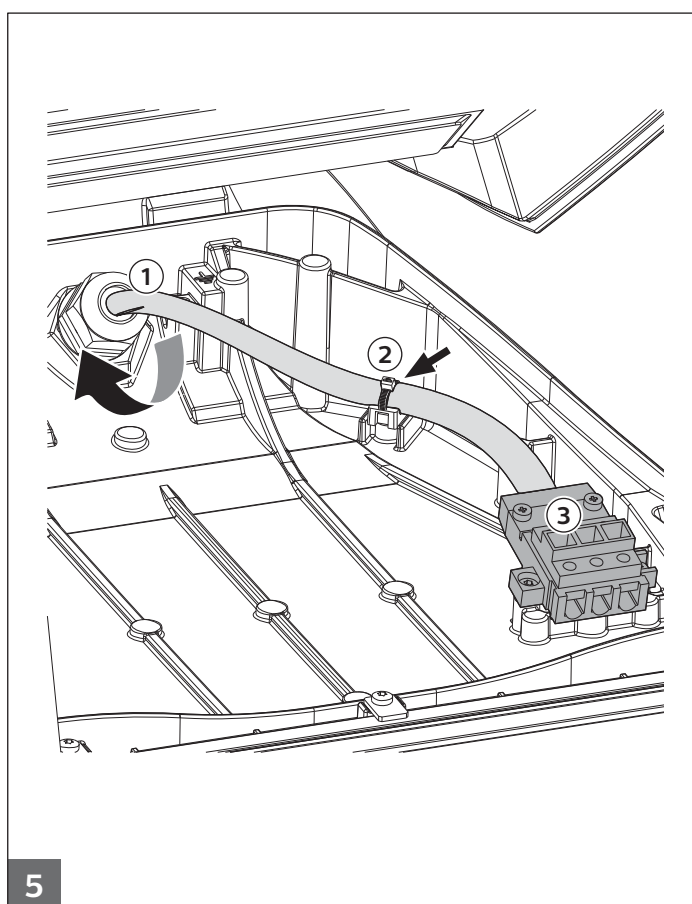
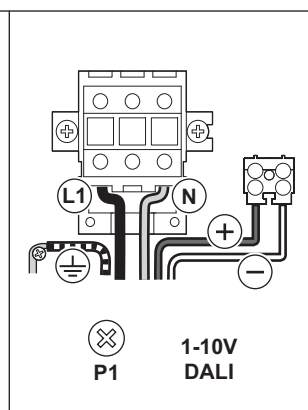
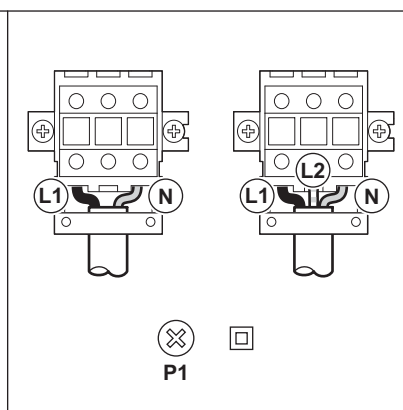
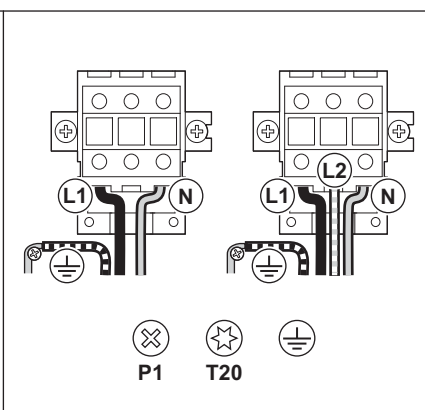
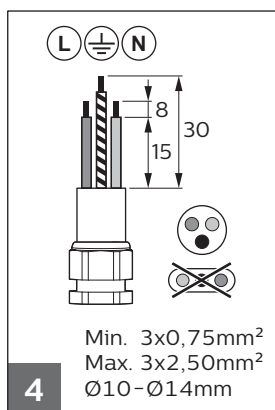
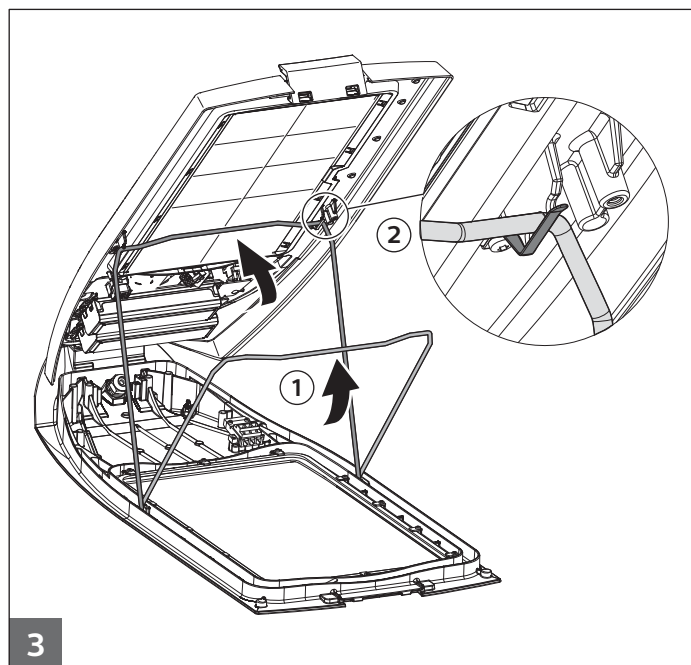
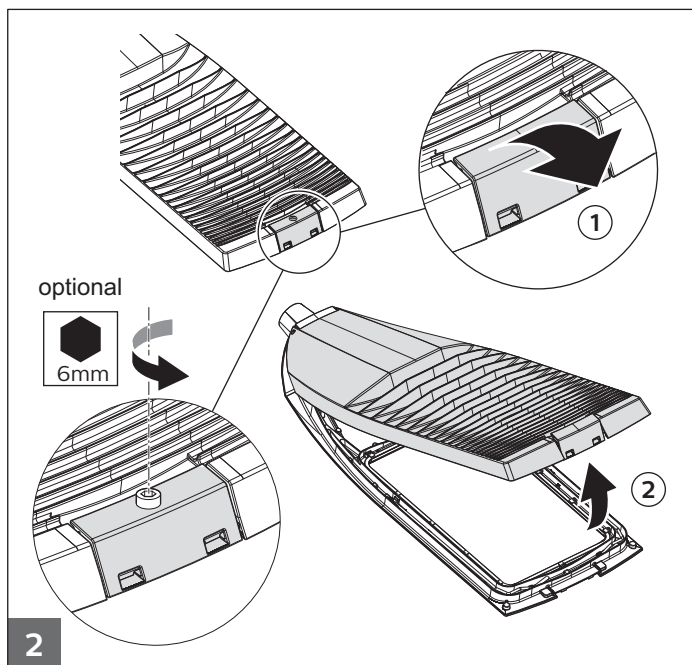

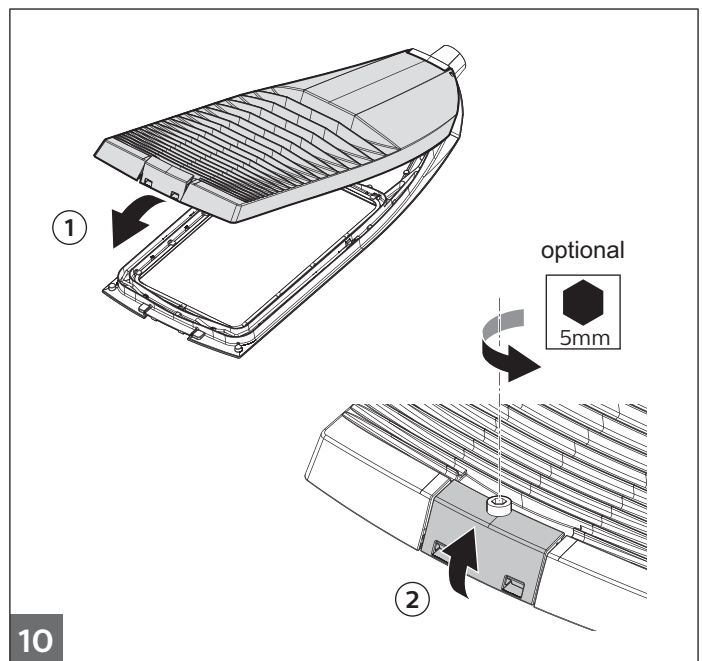
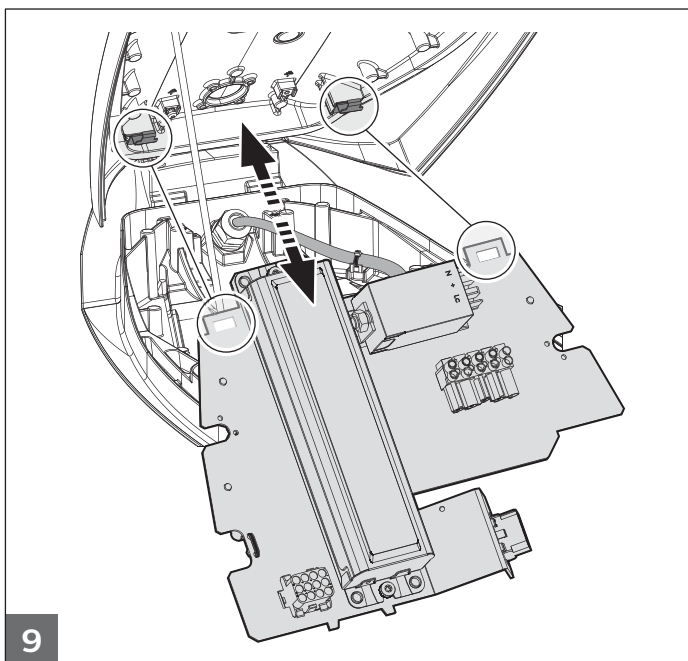
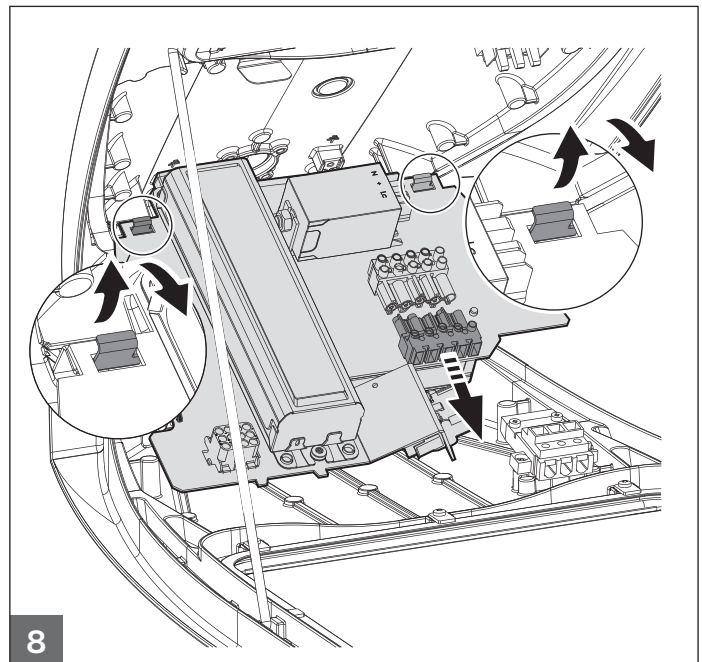
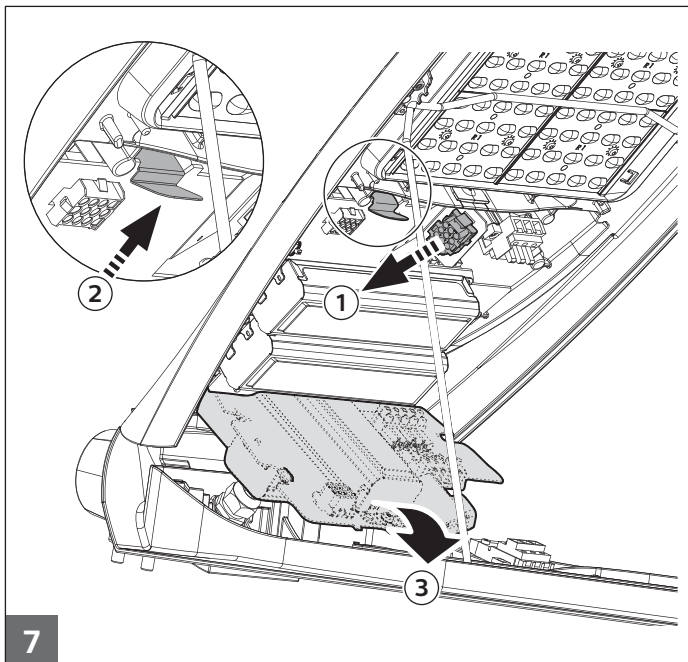

Tolerances

All electrical and flux values are typical values at 25°C ambient (EN60598-2/3).

	flux	W
LEDs	+/- 7%	-
Vf LED	-	+/- 6%
I-driver	+/- 5%	+/- 5%
	+/- 12%	+/- 11%

Temperature Protection

Luma BGP615, BGP621, BGP623, BGP625, BGP627:
Both LED and driver have a temperature protection. When for any reason the temperature of the LED is too high the system first dims back to 50%, if still too hot it will switch off. If the driver is too warm it switches off. Power will return automatically when the temperature has dropped again.

Luma BGP620, BGP622, BGP624, BGP626:
Only driver protection.

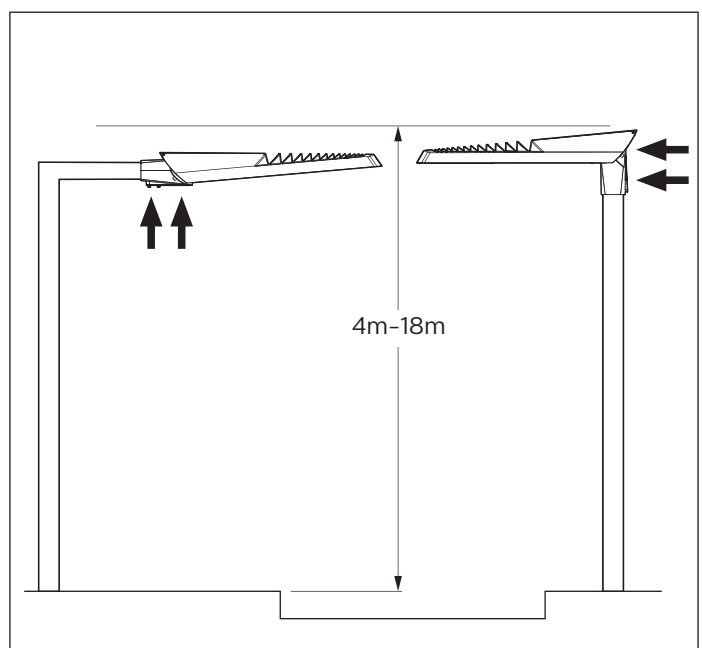

Operation Instructions for Philips luminaire Luma

Content:

1. Safety instructions
2. Conformity with the standards
3. Technical data
4. Installation
5. Taking into operation
6. Maintenance
7. Installation Instructions

1. Safety instructions

For skilled electricians and trained personnel in accordance with national legislation, including the relevant standards.

Observe the national safety rules and regulations for prevention of accidents and the following safety instructions.

1. The technical data on product label, indicated on the luminaire and the gear, are to be observed.
2. Changes of the design and modification to the luminaire are not permitted.
3. The luminaire shall be operated as intended and in undamaged and perfect condition.
4. Only genuine Philips spare parts may be used for replacement.
5. Repairs may only be carried out by a qualified "electrician".
6. Do not keep these operating instructions inside the luminaire during operation.

2. Conformity with standards

- This luminaire meets the requirements of EN 60 598.
- It has been designed, manufactured and tested as a state of art product and according to EN ISO 9001-2000 quality management system.
- It meets CE requirements.

3. Technical data

System Power depends on amount of LEDs and Current; see product label. Ambient : - 20 to + 35 °C in general. Specific max ambient temperature see product label. If nothing is stated on the product label max ambient temperature 25° C. Other ambient temperature on request.

Exceptions for certain versions equipped with dimming gear, mini photocell: please check the product label. Technical details are stated on the product label. This label states number of LEDs, system wattage, supply voltage and frequency, power factor, maximum current, electrical insulation class (if class 2, double insulated), maximum ambient temperature (if nothing is stated the maximum ambient temperature is 25 degrees C), IP value , CE mark. If a programmable driver is used an additional product label is used to show the programming code.

4. Installation

Observe the respective national regulations as well as the general rules of engineering which apply to the installation and operation of electrical apparatus. Transport and storage of the luminaire is permitted in original packaging and specified position only. Installation instructions are included in the packaging of each luminaire and are to be strictly followed. We advise to disconnect the lantern from the power supply before gear exchange.

5. Taking into operation

Prior to operation, check the luminaire for its proper functioning and installation in compliance with these operation instructions, the installation instructions and other applicable regulations.

6. Maintenance, servicing and repair

Disconnect the lantern from the power supply before opening it or carrying out repairs! Observe the national regulations applicable to the maintenance, servicing and testing of electrical apparatus as well as the general rules of engineering.

- Depending on environmental circumstances the luminaire may need to be cleaned. For cleaning only use a damp cloth or sponge. Only use customary household wash-up liquid diluted in water. After cleaning rinse with clear water.
- In case of driver failure, 100% LEDs out, the luminaire can be opened for replacement of this driver.
- Return programmable driver for proper programming of the spare driver or supply the information when ordering the spare driver.
- Check gaskets of the driver housing for their perfect condition. Grease the gasket with acid-free grease.
- Check terminal blocks for their firm fit.
- Only use genuine Philips spare parts.
- The LEDs and lenses can be replaced on site but it is advised to do this indoor to avoid water ingress. Please order a new LED unit using the label information of the luminaire.

7. Warranty disclaimer

- a. No warranty if an unauthorized modification has taken place such as non authorized dimming equipment, CMS, different driver brand/type etc.
- b. No warranty if luminaire has been used outside indicated Temperature/Electrical properties.
- c. No warranty if the drivers have been reprogrammed or reset unauthorized.
- d. No warranty if the usage history of the drivers has been deleted or modified.
- e. No warranty if the luminaire has been used outside the indicated usage properties such as other tilt angles, upside down, submerged etc.
- f. submerged etc.
- g. No warranty if the installation instruction has not been followed properly.

8. Installation instructions

Installation instructions are included in the packaging of each luminaire and are to be strictly followed.