

PHILIPS LIGHTOLIER

Track heads

Classics Roundback

PAR20 track heads

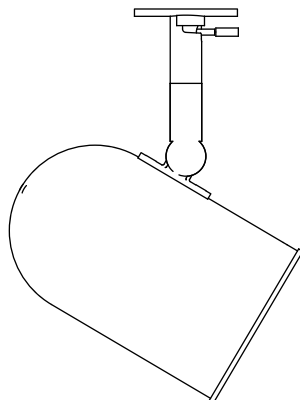

Project: _____
Location: _____
Cat.No: _____
Type: _____
Lamps: _____ Qty: _____
Notes: _____

Ordering guide

example: 9120WH

Series	Size	Mounting	Lamping
9120	<input type="checkbox"/>		
9120 Classics Roundback	WH Matte White BK Matte Black	All Lytespan Track Systems	A19, R20, PAR16 75W Max PAR20 50W Max

Features

- LyteSpan Attachment Fitting:** Die-cast zinc alloy.
- Housing:** .40" aluminum.
- Step Baffle:** Compression-molded high heat phenolic with stepped conical surface for low brightness. Integral black finish.
- Lever:** Locks attachment fitting electrically and mechanically anywhere along the track.
- Moveable Brass Contact:** Extends for connection to 2nd circuit in Advent Lytespan Track.
- Swivel:** Die-cast zinc alloy. 350° horizontal adjustment.
- Pivot Mounting:** Tensioned with built-in stop, provides 90° vertical adjustment.

Electrical

Porcelain socket, medium base, nickel plated screw shell. No. 18 braided SF-1 leads.

Finish

All painted finishes are baked enamel.

Labels

UL, I.B.E.W.

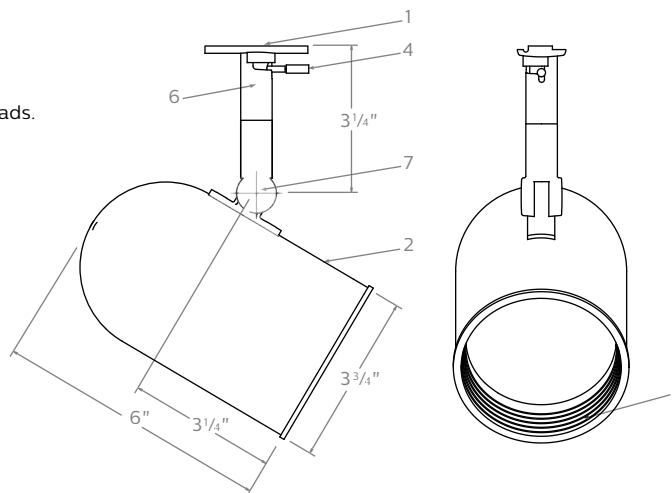

© 2014 Koninklijke Philips N.V. All rights reserved.
Philips reserves the right to make changes in specifications and/or to discontinue any product at any time without notice or obligation and will not be liable for any consequences resulting from the use of this publication.
philips.com/luminaires



Philips Lighting, North America Corporation
200 Franklin Square Drive, Somerset, NJ 08873
Tel. 855-486-2216

Imported by: Philips Lighting,
A division of Philips Electronics Ltd.
281 Hillmount Rd, Markham, ON, Canada L6C 2S3
Tel. 800-668-9008