

Mounting instructions

City Swan Wall BWP 445 LED Rebel NW 4W

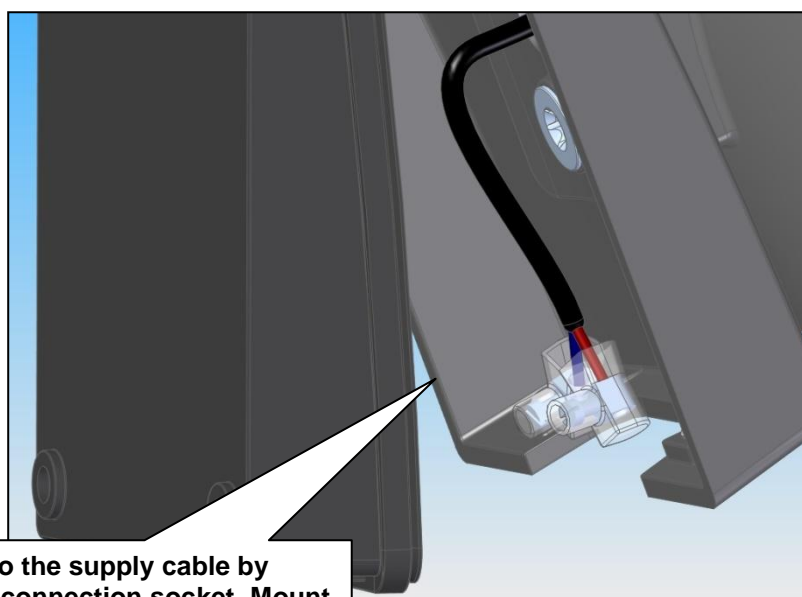
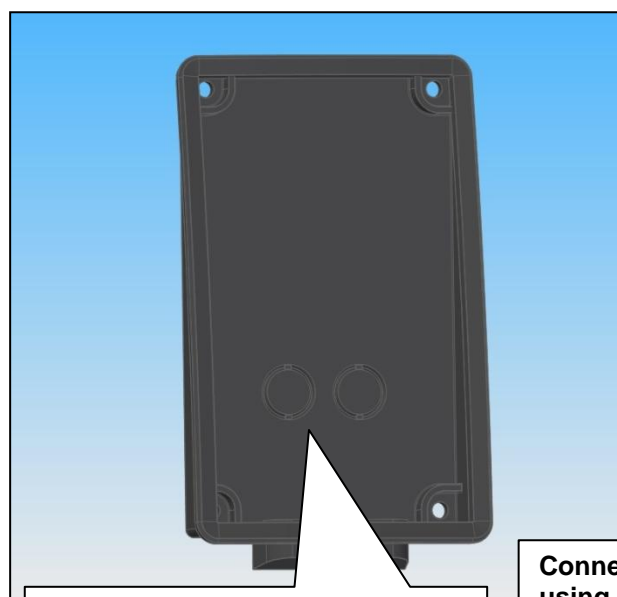
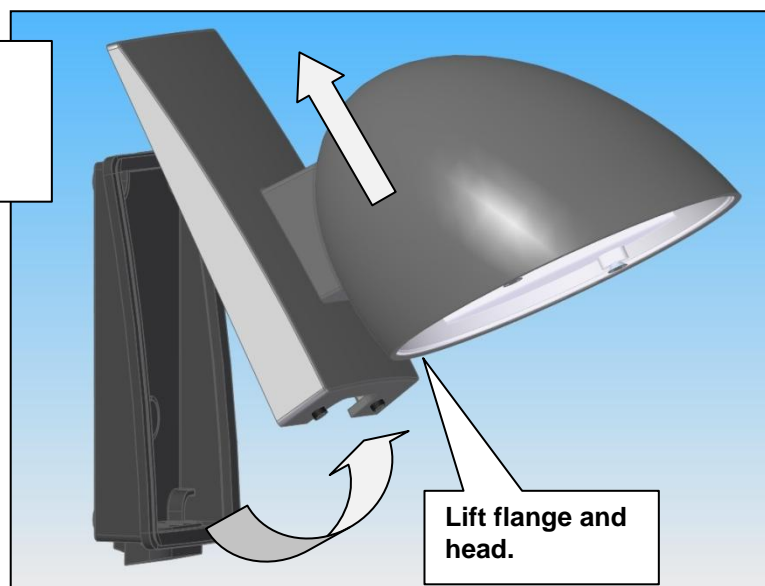
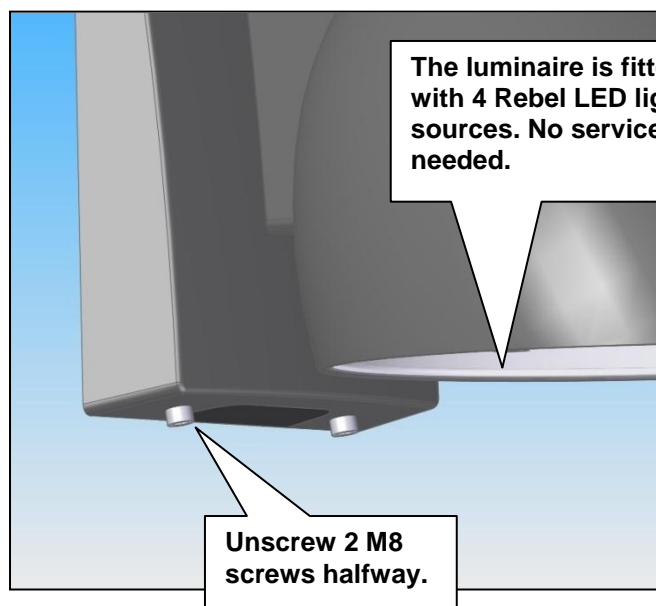

Philips Lighting A/S

Frederikskaj 6

2450 København SV

Danmark

Telefon: +45 33 29 33 33 Telefax: +45 33 29 39 31

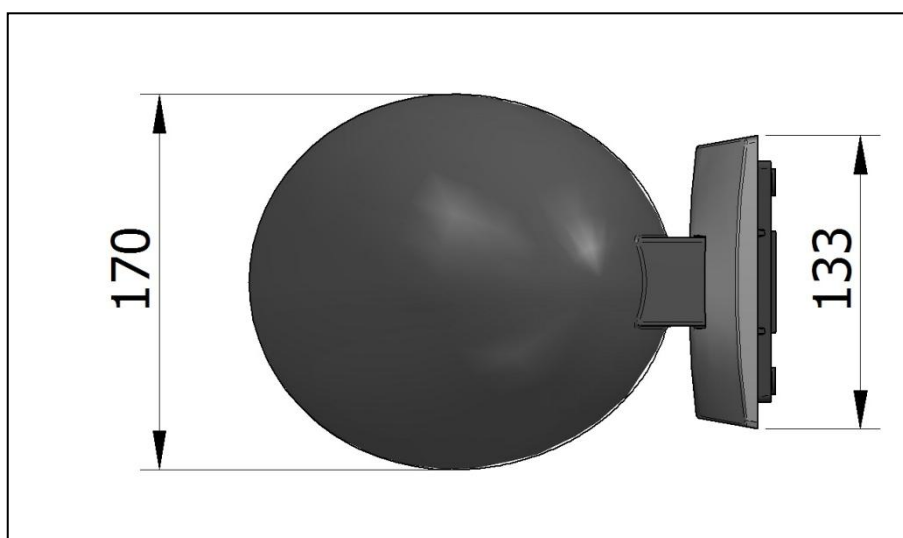
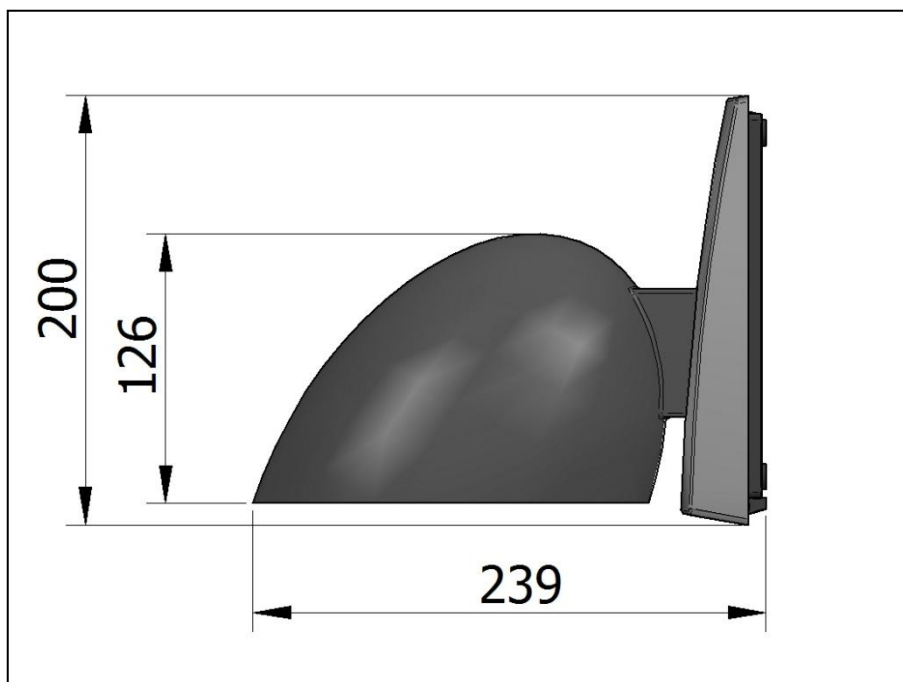

230V/50Hz
Class II
IP 44
2,5kg

Environmental protection is an integral part of industrial and product policy of Philips.

The product contains:

Listed by quantity
(Excl. packaging)

Aluminum, PA 6.6, stainless steel,
PC, lamp gear.



PHILIPS