

# PHILIPS ADVANCE

Metal  
Halide  
Lamp Ballast

Catalog Number 78E6590  
For 1000W M47  
60 Hz CWA  
Status: Active

### DIMENSIONS AND DATA

78E  
INDOOR  
ENCLOSED  
DIMENSIONS

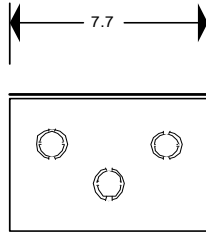

Top view  
3 double  
7/8" and 1 1/8"  
knockouts

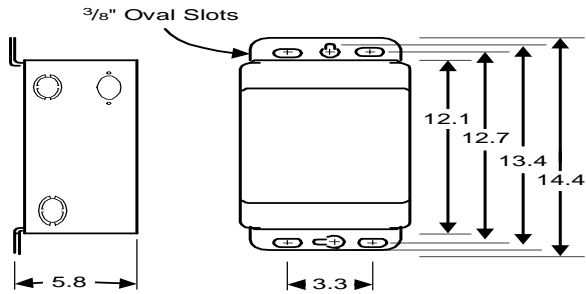

INPUT VOLTS	120	208	240	277	
CIRCUIT TYPE	CWA				
POWER FACTOR (min)	90%				
REGULATION					
Line Volts	±10%				
Lamp Watts	±10%				
LINE CURRENT (Amps)					
Operating.....	9.00	5.20	4.50	3.90	
Open Circuit.....	5.00	2.70	2.50	2.20	
Starting.....	7.00	4.00	3.50	3.00	
UL TEMPERATURE RATINGS					
Insulation Class	H(180°C)				
Coil Temperature Code	1029				
MIN. AMBIENT STARTING TEMP.	-20°F or -30°C				
NOM. OPEN CIRCUIT VOLTAGE	415				
INPUT VOLTAGE AT LAMP DROPOUT.....	60	104	120	138	
INPUT WATTS	1070				
RECOMMENDED FUSE (Amps).....	20	15	10	10	
CORE and COIL					
Dimension (A)					
Dimension (B)					
Weight (lbs.)	40				
Lead Lengths	12"				
CAPACITOR REQUIREMENT					
Microfarads					
Volts (min.)					
Fault Current Withstand (amps)					
60 Hz TEST PROCEDURES (Refer to Advance Test Procedure for HID Ballasts - Form 1270)					
High Potential Test (Volts)					
1 minute	2000				
2 seconds	2500				
Open Circuit Voltage Test (Volts)	370-460				
Short-Circuit Current Test (Amps)					
Secondary Current	4.90-6.10				
Input Current.....	5.30-8.00	3.10-4.70	2.70-4.00	2.30-3.50	-

Capacitor:

The capacitor is included as part of the potted assembly.

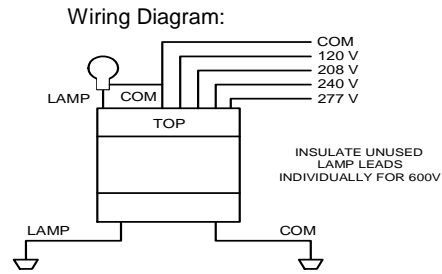

### Ordering Information

Order Suffix

Description

Ignitor:

NA

This ballast does not require the use of an ignitor.

Data is based upon tests performed by Philips Lighting Electronic N.A. in a controlled environment and representative of relative performance. Actual performance can vary depending on operating conditions. Specifications are subject to change without notice.

Philips Lighting Electronic N.A.

10275 West Higgins Road · Rosemont, IL 60018 · Tel:800-322-2086 Fax:888-432-1882  
Customer Support/ Technical Service:800-372-3331 · OEM Support: 866-915-5886

08/10/05