

PHILIPS ADVANCE

Metal
Halide
Lamp Ballast

Catalog Number 78E6091
For 400W M59
60 Hz CWA
Status: Active

DIMENSIONS AND DATA

78E
INDOOR
ENCLOSED
DIMENSIONS

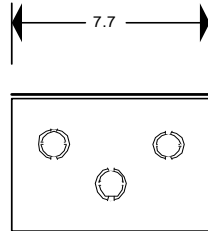

Top view
3 double
7/8" and 1 1/8"
knockouts

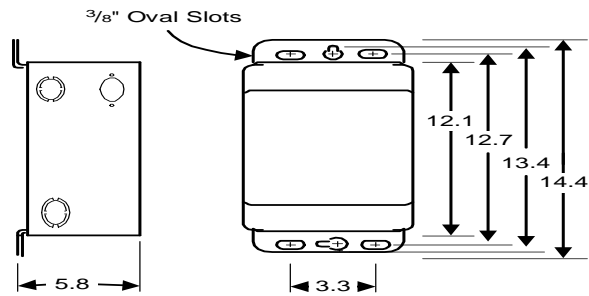

| | | | | | |
|--------------------------------------------------------------------------------------|----------------|-----------|-----------|-----------|---|
| INPUT VOLTS | 120 | 208 | 240 | 277 | |
| CIRCUIT TYPE | CWA | | | | |
| POWER FACTOR (min) | 90% | | | | |
| REGULATION | | | | | |
| Line Volts | ±10% | | | | |
| Lamp Watts | ±10% | | | | |
| LINE CURRENT (Amps) | | | | | |
| Operating..... | 4.00 | 2.30 | 2.00 | 1.75 | |
| Open Circuit..... | 3.00 | 1.75 | 1.50 | 1.30 | |
| Starting..... | 3.50 | 2.00 | 1.75 | 1.50 | |
| UL TEMPERATURE RATINGS | | | | | |
| Insulation Class | H(180°C) | | | | |
| Coil Temperature Code | 1029 | | | | |
| MIN. AMBIENT STARTING TEMP. | -20°F or -30°C | | | | |
| NOM. OPEN CIRCUIT VOLTAGE | 300 | | | | |
| INPUT VOLTAGE AT LAMP DROPOUT..... | 60 | 104 | 120 | 138 | |
| INPUT WATTS | 458 | | | | |
| RECOMMENDED FUSE (Amps)..... | 10 | 7 | 5 | 5 | |
| CORE and COIL | | | | | |
| Dimension (A) | | | | | |
| Dimension (B) | | | | | |
| Weight (lbs.) | 26 | | | | |
| Lead Lengths | 12" | | | | |
| CAPACITOR REQUIREMENT | | | | | |
| Microfarads | | | | | |
| Volts (min.) | | | | | |
| Fault Current Withstand (amps) | | | | | |
| 60 Hz TEST PROCEDURES (Refer to Advance Test Procedure for HID Ballasts - Form 1270) | | | | | |
| High Potential Test (Volts) | | | | | |
| 1 minute | 2000 | | | | |
| 2 seconds | 2500 | | | | |
| Open Circuit Voltage Test (Volts) | 270-330 | | | | |
| Short-Circuit Current Test (Amps) | | | | | |
| Secondary Current | 3.50-4.30 | | | | |
| Input Current..... | 2.70-4.20 | 1.55-2.40 | 1.35-2.10 | 1.10-1.80 | - |

Capacitor:

The capacitor is included as part of the potted assembly.

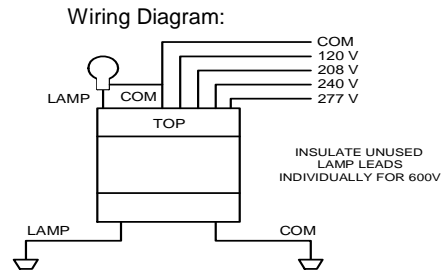

Ordering Information

| Order Suffix | Description |
|--------------|-------------|
| | |

Ignitor:

NA

This ballast does not require the use of an ignitor.

Data is based upon tests performed by Philips Lighting Electronic N.A. in a controlled environment and representative of relative performance. Actual performance can vary depending on operating conditions. Specifications are subject to change without notice.

Philips Lighting Electronic N.A.

10275 West Higgins Road · Rosemont, IL 60018 · Tel:800-322-2086 Fax:888-432-1882
Customer Support/ Technical Service:800-372-3331 · OEM Support: 866-915-5886

10/06/06