

HID-GreenVision – The electronic solution for growth light applications

HID-GreenVision GP-SON

Full electronic driver for GP-SON 600/1000W lamps

Benefits

- Flexible design-in (PCB in bracket, optimal heat dissipation)
- Low energy consumption
- High number of devices on a MCB (fuse)

Features

- High efficiency: >95%
- Inrush current limiter
- Long lifetime of 30,000 hours, with 90% survivors at Tcase life
- Accurate lamp power stabilization of +/-3% over wide mains voltage range

Application

- Luminaires for assimilation lighting (greenhouses/field pitch)

HID-GreenVision GP-SON

Versions

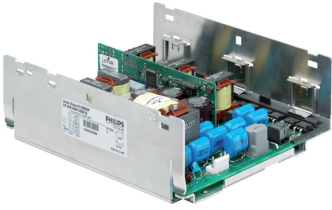

HID-GVIII 600W/P GP-SON 400V

Dimensional drawing

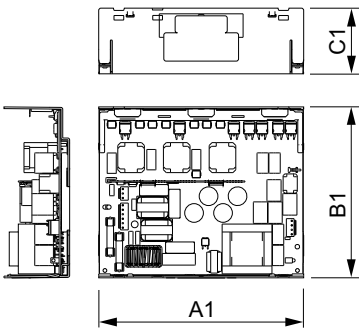

Product	C1	A1	B1
HID-GVIII 1000W/P GP-SON 400V	58 mm	181 mm	150 mm
HID-GVIII 600W/P GP-SON 400V	58 mm	181 mm	150 mm
HID-GVIII 750W/P GP-SON 400V NA	181 mm	151 mm	58 mm

Product details



GPPR1 IGV3GPSN 0002

Approval and Application

Energy Efficiency Index A2

Operating and Electrical

Input Frequency 50 to 60 Hz

Input Voltage 400 V

General Information

Number Of Lamps 1 piece/unit

Lamp Type GP-SON

Mechanical and Housing

Order Code	Full Product Name	Housing
913700660361	HID-GVIII 600W/P GP-SON 400V	L 181x150x58

HID-GreenVision GP-SON

Order Code	Full Product Name	Housing
913700660461	HID-GVIII 1000W/P GP-SON 400V	L 181x150x58
913712009361	HID-GVIII 750W/P GP-SON 400V NA	L 181x151x58

System characteristics

Order Code	Full Product Name	Rated Ballast-Lamp Power
913700660361	HID-GVIII 600W/P GP-SON 400V	600W/P
913700660461	HID-GVIII 1000W/P GP-SON 400V	1000W/P

Order Code	Full Product Name	Rated Ballast-Lamp Power
913712009361	HID-GVIII 750W/P GP-SON 400V NA	750W/P

