



Long-lasting, reliable solution

HID-HighPower for SON/MH/HPL/HPI

Encapsulated ballasts for use with SON (T) (Plus), HPL, HPI and MH lamps with rated wattages of 1000 W and above

Benefits

- Protected from overheating – outstanding product lifetime of 15 years average
- Minimal watt losses thanks to orthocyclic winding process
- Ideal for pole mounting

Features

- Excellent resistance to chemical impact, humid conditions and environmental stress crack
- Class I rated (i.e. with earthing facility)
- Equipped with screw terminal blocks as standard
- Separate earth terminal (HID 'Heavy Duty')
- Ballasts for alternative mains voltages/frequencies available upon request

Application

- Outdoor lighting (most popular application areas: sports and area lighting)

HID-HighPower for SON/MH/HPL/HPI

Dimensional drawing

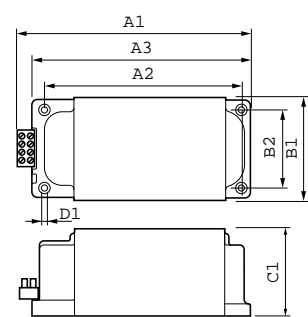

| Product | D1 | C1 | A1 | A2 | A3 | B1 | B2 |
|---------------|-----|-------|-------|-------|-------|-------|------|
| BHL 1000 L02- | 6.5 | 102.0 | 207.0 | 172.0 | 196.0 | 117.0 | 88.0 |
| A2 220V 50Hz | mm | mm | mm | mm | mm | mm | mm |
| HP-207 | | | | | | | |

