



Long-lasting, reliable solution

HID-HighPower for SON/MH/HPL/HPI

Encapsulated ballasts for use with SON (T) (Plus), HPL, HPI and MH lamps with rated wattages of 1000 W and above

Benefits

- Protected from overheating – outstanding product lifetime of 15 years average
- Minimal watt losses thanks to orthocyclic winding process
- Ideal for pole mounting

Features

- Excellent resistance to chemical impact, humid conditions and environmental stress crack
- Class I rated (i.e. with earthing facility)
- Equipped with screw terminal blocks as standard
- Separate earth terminal (HID 'Heavy Duty')
- Ballasts for alternative mains voltages/frequencies available upon request

Application

- Outdoor lighting (most popular application areas: sports and area lighting)

HID-HighPower for SON/MH/HPL/HPI

Versions



Dimensional drawing

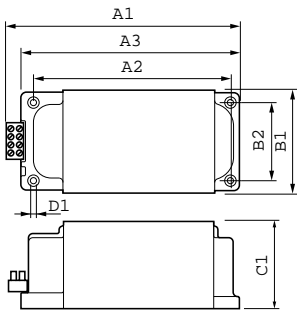

| Product | D1 | C1 | A1 | A2 | A3 | B1 | B2 |
|-------------------------------------|-----|-------|-------|-------|-------|-------|------|
| BHL 1000 L78-A2 230/240V 50Hz | 6.5 | 102.0 | 207.0 | 172.0 | 196.0 | 117.0 | 88.0 |
| HP-207 | | | | | | | |
| BHL 1000 L02-A2 220V 50Hz HP-207 | 6.5 | 102.0 | 207.0 | 172.0 | 196.0 | 117.0 | 88.0 |

| Operating and Electrical | |
|--------------------------|--------------|
| Input Frequency | 50 Hz |
| General Information | |
| Number Of Lamps | 1 piece/unit |
| Lamp Type | HPI |
| System characteristics | |
| Rated Ballast-Lamp Power | 1000 W |

Operating and Electrical

| Order Code | Full Product Name | Input Voltage | |
|--------------|-------------------------------|---------------|--------------------------|
| | | (Multi-Tab) | Input Voltage |
| 913700217303 | BHL 1000 L78-A2 230/240V 50Hz | 230/240 | 230 V (default) or 240 V |
| | HP-207 | | |

| Order Code | Full Product Name | Input Voltage | |
|--------------|---------------------------|---------------|---------------|
| | | (Multi-Tab) | Input Voltage |
| 913700218403 | BHL 1000 L02-A2 220V 50Hz | 220 | 220 V |
| | HP-207 | | |

