



Long-lasting, reliable solution

HID-HighPower for SON/MH/HPL/HPI

Encapsulated ballasts for use with SON (T) (Plus), HPL, HPI and MH lamps with rated wattages of 1000 W and above

Benefits

- Protected from overheating – outstanding product lifetime of 15 years average
- Minimal watt losses thanks to orthocyclic winding process
- Ideal for pole mounting

Features

- Excellent resistance to chemical impact, humid conditions and environmental stress crack
- Class I rated (i.e. with earthing facility)
- Equipped with screw terminal blocks as standard
- Separate earth terminal (HID 'Heavy Duty')
- Ballasts for alternative mains voltages/frequencies available upon request

Application

- Outdoor lighting (most popular application areas: sports and area lighting)

HID-HighPower for SON/MH/HPL/HPI

Versions



BHL 1000 L78-A2 230/240V 50Hz
HP-207



BSN 1000 L78-A2 230/240V 50Hz
HP-257



BHD 2000 L76-A2 380/400/415V
50Hz HP-317

Dimensional drawing

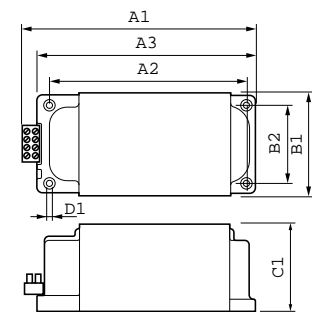
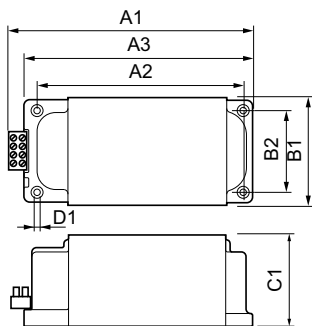

Product	D1	C1	A1	A2	A3	B1	B2
BHD 2000 L76-A2 380/400/415V 50Hz HP-317	6.5 mm	102.0 mm	317.0 mm	282.0 mm	306.0 mm	117.0 mm	88.0 mm

Product	D1	C1	A1	A2	A3	B1	B2
BHL 1000 L02-A2 220V 50Hz HP-207	6.5 mm	102.0 mm	207.0 mm	172.0 mm	196.0 mm	117.0 mm	88.0 mm
BHL 2000 L76-A2 380/400/415V 50Hz HP-317	6.5 mm	102.0 mm	317.0 mm	282.0 mm	306.0 mm	117.0 mm	88.0 mm
BHL 1000 L78-A2 230/240V 50Hz HP-207	6.5 mm	102.0 mm	207.0 mm	172.0 mm	196.0 mm	117.0 mm	88.0 mm

HID-HighPower for SON/MH/HPL/HPI

Dimensional drawing

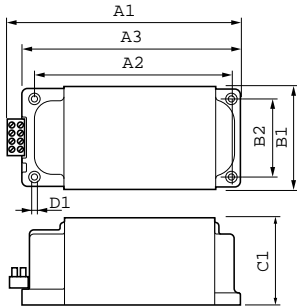

Product	D1	C1	A1	A2	A3	B1	B2
BSN 1000 L78-A2 230/240V 50Hz HP-257	6.5 mm	102.0 mm	257.0 mm	222.0 mm	246.0 mm	117.0 mm	88.0 mm

Operating and Electrical

Input Frequency 50 Hz

General Information

Number Of Lamps 1 piece/unit

Operating and Electrical

Order Code	Full Product Name	Input Voltage	
		(Multi-Tab)	Input Voltage
913700217303	BHL 1000 L78-A2 230/240V 50Hz HP-207	230/240	230 V (default) or 240 V
913700217903	BHL 2000 L76-A2 380/400/415V 50Hz HP-317	380/400/415	380 to 415 V
913700218403	BHL 1000 L02-A2 220V 50Hz HP-207	220	220 V

Order Code	Full Product Name	Input Voltage	
		(Multi-Tab)	Input Voltage
913700217503	BSN 1000 L78-A2 230/240V 50Hz HP-257	230/240	230 V (default) or 240 V
913700232103	BHD 2000 L76-A2 380/400/415V 50Hz HP-317	380/400/415	380 to 415 V

General Information

Order Code	Full Product Name	Lamp Type
913700217303	BHL 1000 L78-A2 230/240V 50Hz HP-207	HPI
913700217903	BHL 2000 L76-A2 380/400/415V 50Hz HP-317	HPI
913700218403	BHL 1000 L02-A2 220V 50Hz HP-207	HPI

Order Code	Full Product Name	Lamp Type
913700217503	BSN 1000 L78-A2 230/240V 50Hz HP-257	SON
913700232103	BHD 2000 L76-A2 380/400/415V 50Hz HP-317	MH

System characteristics

Order Code	Full Product Name	Rated Ballast-Lamp Power
913700217303	BHL 1000 L78-A2 230/240V 50Hz HP-207	1000 W
913700217903	BHL 2000 L76-A2 380/400/415V 50Hz HP-317	2000 W
913700218403	BHL 1000 L02-A2 220V 50Hz HP-207	1000 W

Order Code	Full Product Name	Rated Ballast-Lamp Power
913700217503	BSN 1000 L78-A2 230/240V 50Hz HP-257	1000 W
913700232103	BHD 2000 L76-A2 380/400/415V 50Hz HP-317	2000 W

HID-HighPower for SON/MH/HPL/HPI

