



PrimaVision SDW-TG (50W & 100W) for SDW-TG - High quality and robust performance

PrimaVision for SDW-TG

Robust, lightweight and one-piece HID electronic gear for SDW-TG lamps (mini White SON) Lightweight, one-piece electronic gear for 50 and 100 W SDW-TG lamps (mini White SON)

Benefits

- Optimal lamp performance thanks to minimal lamp power tolerance
- Reduces colour differences between lamps and initial lumen spread
- Performance is independent of mains voltage

Features

- Available as Standard (/S) version for use in a luminaire, or with separate strain relief for independent use on a (false) ceiling
- Minimal lamp power spread
- Lamp end-of-life detection
- High Tambient and Tcase temperatures
- Long lifetime of 40,000 hours

Application

- Shop lighting, for a cozy atmosphere (e.g. in furniture shops) and excellent display of fresh goods (e.g. in butcher's shops, bakeries, florists)
- Suitable for indoor use only

PrimaVision for SDW-TG

Versions



Dimensional drawing

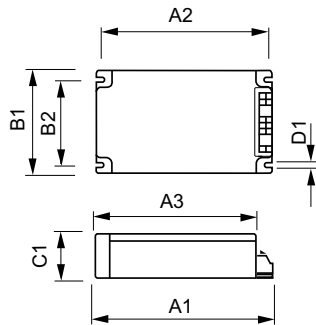

Product	D1	C1	A1	A2	B1	B2
HID-PV 100 /S SDW-TG 220-240V 50/60Hz	4.5 mm	37.0 mm	150.0 mm	133.6 mm	90.0 mm	70.0 mm

