



Product Description

EB-Certalume for PLT/C lamps

Affordable, reliable, high frequency electronic ballast for 4-pin PL-T and PL-C fluorescent lamps, ideal alternative for electromagnetic (EM) ballasts. The ballast is primarily designed for Indoor application. For outdoor application, the luminaire should be minimum Classland need to be sufficiently protected against water & dust. The installation should also be guard against any lightening surge or any other necessary electrical protection as deemed in such typical installation & application.

Benefits

- Energy efficient, saving 25% energy compared to electromagnetic “C-type” ballasts
- The EB-C TL5 range has a robust design and meets safety, EMC and Immunity tests including safety approbation via an external test-house covering IEC/EN 61347.
- Ideal alternative for electromagnetic ballast, no ignitor needed Pre wired, Lamp/ mains wires and lamp holders are included for easy installation.
- Same size as electromagnetic ballast so ideal for replacements

Features

- Energy efficient CELMA A3
- Complying to CCC certificate including safety acc IEC 61347
- Robust design for 20.000 hour lifetime and 3.000 on/off switches on one lamp.
- Rapid, flicker-free lamp start (< 1.6 s)
- High power factor 0.95 with THD <25%
- EMC compliant to EN 55015 2006 + A1 2007
- Wide voltage range for ignition and operation (165V-253V)
- 45 degree connector for easy connection with push button release

EB-Certalume for PLT/C lamps

Application

- Designed for applications where lamps burn for a long period of time and switching cycle (on/off) is infrequent. Typical areas of application include:
- Professional indoor applications (e.g. offices and hotels)
- Department stores, shops, supermarkets, convenient stores and public area's
- Indoor lighting boxes
- Homes

Versions



Dimensional drawing

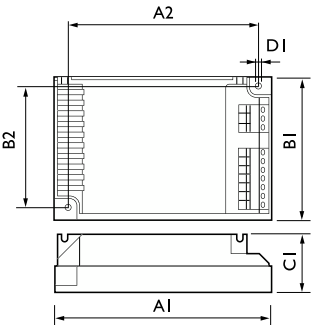

Product	D1	C1	A1	A2	B1
EB-C 113 PL-T/C 220-240V 50/60Hz	4.2 mm	31.0 mm	94.0 mm	86.0 mm	72.0 mm

