



# Certaline - An extremely compact electronic transformer for 12V halogen lamps

## Certaline Halogen Transformers

Philips Certaline is an electronic halogen transformer for low-voltage halogen lamps. It is available in 60/105/150 W versions.

### Benefits

- Suitable for independent operation thanks to robust strain-relief
- VDE, SELV, CE and EMC-compliant

### Features

- Extremely compact dimensions for the 60 W model
- Three levels of protection: over-voltage, over-temperature and short circuit
- Long lifetime: 20,000 hours
- Dimming possible with Philips-approved Trailing Edge dimmers
- Possible to connect two lamps for 105 W, and three lamps for 150 W

### Application

- Indoor residential use including living rooms and decorative and accent lighting
- Professional applications including retail, offices, conference rooms and exhibitions

# Certaline Halogen Transformers

## Versions



ET-C 60

## Dimensional drawing

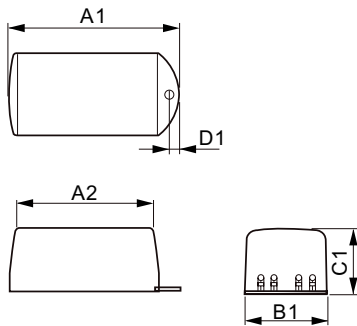

| Product | C1      | A1      | B1      |
|---------|---------|---------|---------|
| ET-C 60 | 31.0 mm | 76.0 mm | 38.0 mm |

