



Product Description

Aluline 111

Low-voltage halogen reflector lamp with high-purity aluminium reflector of 111 mm

Benefits

- Glare free, well defined accent lighting with minimum amount of direct glare from the lamp

Features

- Metal cap to shield filament to reduce glare and improve beam shape
- G53 socket and screw or tab terminals allowing for direct wire connection with imating eyelet or receptacle
- UV-block quartz glass

Application

- Excellent light source for general lighting and especially creative accent lighting in shops, restaurants, hotels, galleries, exhibitions and museums

Versions



Aluline 111

Dimensional drawing

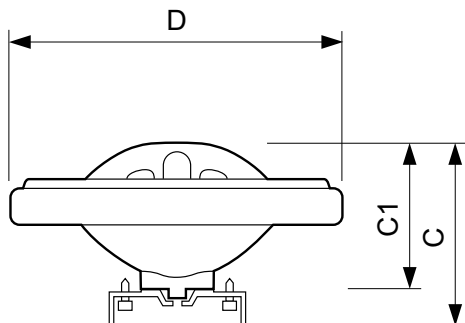

| Product | D (max) | C (max) | C1 (max) |
|-----------------------------------|---------|---------|----------|
| Aluline 111 50W G53 12V 24D 1CT/6 | 111 mm | 67 mm | 51 mm |

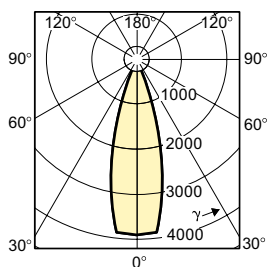

Accent Diagrams

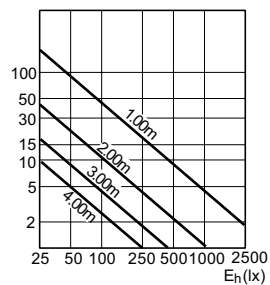

LDAC_HALUACN_50W_24D-Accent diagram

Beam Diagrams

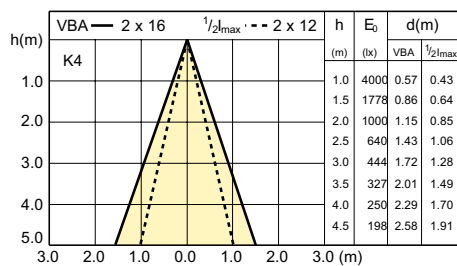

LD BE_HALUACN_50W_24D-Beam diagram

