



# HDK900 Phoenix

## Phoenix HDK900

A sturdy long lasting quality electrical gear housing of compact and elegant design, suitable to give together with a range of reflector types and attachments, the right solution for low and high bay lighting requirement.

### Features

- It is designed to incorporate low and medium wattage HID lamps
- The gear housing can be combined with standard Philips aluminium reflector and a range of acrylic reflectors.
- For use with any of the following HID lamps: 250W or 400W – HPL-N, SON or HPI-BU (S) lamps.
- The wattage range between 150 – 400 watt for HID lamps. 1000W HID on request
- Coloured gear housings are possible upon request
- The aluminium material is of heat, corrosion and UV resistant type
- The luminaire is delivered standard in unpainted version. Painted versions are available upon request
- IP65 ingress protection rating in the gear housing is secured through the use of a neoprene gasket between the housing.
- The gear box uses Philips standard ballasts and is using silicone cable to improve resistance against the heat inside the housing.
- The luminaire is suitable for indoor and semi-outdoor use at an ambient temperature of max 45°C.
- Luminaires in combination with narrow beam reflectors are ideal for lighting in very highhalls, or halls with high obstacles and or high machines.
- Luminaires in combination with wide beam reflectors are suited for relatively low halls and areas where vertical illuminance is required.
- Luminaires in combination with acrylic refractors are ideal when uplighting is required.
- Each reflector can be fitted with a glass-dust cover for applications industry and humid areas.
- Emergency lighting halogen lamp can be installed for emergency lighting, only available on request.

# Phoenix HDK900

## Application

- Industrial areas
- Sports halls
- Commercial areas or other large halls requiring luminaires, suitable for high mounting ceiling.

## Versions



Phoenix HDK/MDK/SDK900 highbay luminaire

## Dimensional drawing

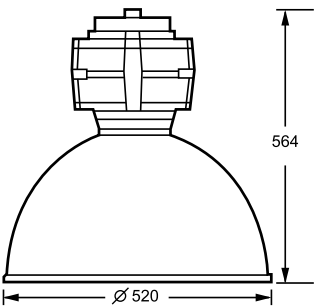

Phoenix HDK/MDK/SDK900

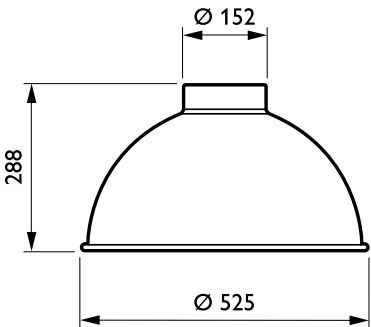
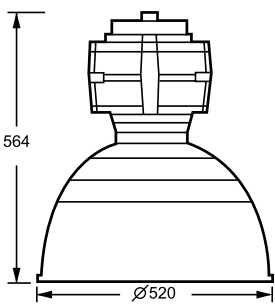

Phoenix acc. GPK900

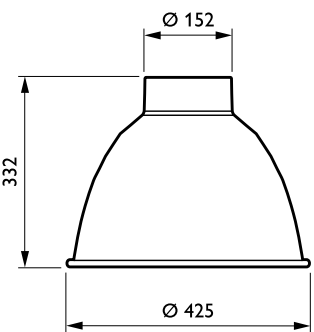

Phoenix acc. GPK900

# Phoenix HDK900

## Accessories



Ordercode 910225102480

### Approval and Application

Ingress protection code	IP54
-------------------------	------

### Operating and Electrical

Input Voltage	220
---------------	-----

### General Information

Compensation circuit	Inductive parallel compensated
----------------------	--------------------------------

Country version	CN
-----------------	----

Gear	CONV
------	------

Lamp family code	HPI-P
------------------	-------

Number of light sources	1
-------------------------	---

Optic type	No
------------	----

### General Information

order code	Lamp power	Product Family Code	Lamp system description
910401240480	400	-	Base-Up/internal Starter (BUS)
910401240780	250	MDK900	Base-Up (BU)

