



Essentially smart and reliable

HF-Essential for TL5/TL-D

HF-Essential is the most cost-effective, slim and affordable ballast to reliably operate a fluorescent lamp. It is also the ideal entry-level product for EM system users who want to enjoy the benefits offered by electronic ballasts. The cost-saving and reliable HF-Essential has an energy efficiency class A2, and its robust design meets all relevant international safety and performance standards. HF-Essential is intended for use with indoor lighting fixtures such as recessed luminaires, which are largely used in office, industrial, hotel, restaurant and other applications.

Benefits

- Automatic restart (after voltage dip or lamp replacement) ensures easy operation and hassle-free re-lamping.
- DC emergency operation and EMC compliant to EN 55015 2006 + A1 2007
- Suitable for luminaires in protection class I and, after testing, class II

Features

- Complies with CE and Kema
- Robust design for 45,000 hours lifetime at $T_a=50\text{ }^{\circ}\text{C}$ and over 6,000 on/off switching operations on one lamp
- Energy efficiency class: A2
- Failure rate of 0.3% per 1,000 hours at $T_c \text{ max} = 75\text{ }^{\circ}\text{C}$
- Igniter and capacitor not required; flicker-free and noiseless

Application

- Ideal for applications where there is a need to reduce the wattage per square meter or to reduce operating costs
- Indoor applications such as office buildings, hospitals, supermarkets, department stores, homes and schools

HF-Essential for TL5/TL-D

Versions



Dimensional drawing

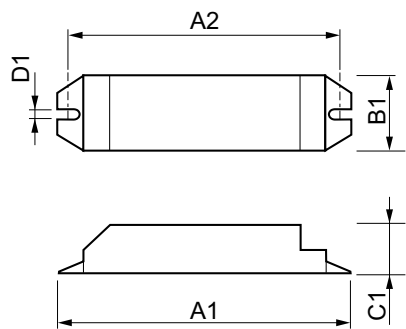

| Product | D1 | C1 | A1 | A2 | B1 |
|------------------------------|--------|---------|----------|----------|---------|
| HF-E 128 TL5 220-240 50/60Hz | 4.2 mm | 21.3 mm | 275.0 mm | 263.0 mm | 19.6 mm |

