

Xtreme drivers for long life and reliable performance

HF-Performer II Xtreme for TL5/TL-D lamps

HF-Performer Xtreme is a unique X-technology from Philips that guarantees the highest lifetime reliability for lamps and enables an extra-long and reliable HF system life with an energy efficiency index (CELMA EEI) of A2.

Benefits

- HF-P XT has double the lifetime of standard HF gear due to the special cooler "Xtreme" long-life low-failure product design.
- Suitable for use in outdoor and industrial environments because the units are protected against transients; also suitable for class I and class II luminaires
- Extreme thermal robustness with average lifetime of 50,000 hours at $T_{case} = 85\text{ }^{\circ}\text{C}$; also extreme reliability and reduced failure rate of 0.1%/1,000 hours
- HF-P Xtreme gear is optimized for the unique dosing of the emitter, resulting in an optimized lamp life

Features

- Protects against transient voltage peaks of up to 4 kV and excessive mains voltage and incorrect connections of up to 400 V
- Programmed, flicker-free, pre-heated start (< 2.0 s) which allows the lamp to be switched on and off without reducing useful lamp life
- Active power factor correction to ensure constant light, irrespective of mains-voltage fluctuations
- Suitable for emergency lighting luminaires in accordance with IEC/EN 60598-2-22

HF-Performer II Xtreme for TL5/TL-D lamps

Application

- Ideal for applications with high maintenance costs or where lamp failure is unacceptable
- Used with movement-detection control systems like Philips OccuPlus
- Applications where gear replacement can cause unsafe situations, hassle or high costs, such as installations with high ceilings or in geographically remote areas, tunnels, airports or underground railway stations
- Industrial premises such as food processing and petrochemical plants

Versions



Dimensional drawing

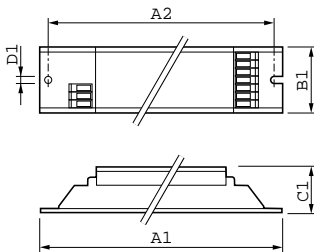

| Product | D1 | C1 | A1 | A2 | B1 |
|--|--------|---------|----------|----------|---------|
| HF-P Xt 258 TL-D EII 220-240V 50/60Hz | 4.2 mm | 28.0 mm | 360.0 mm | 350.0 mm | 30.0 mm |

