



HF-Regulator II for PL-L lamps – Dimming: a next step in energy saving

HF-Regulator II for PL-L lamps

High-frequency electronic dimming ballast, using the analog protocol (1-10 V) for PL-L lamps. The ballast is primarily designed for Indoor application. For outdoor application, the luminaire should be minimum Class II and need to be sufficiently protected against water & dust. The installation should also be guard against any lightening surge or any other necessary electrical protection as deemed in such typical installation & application.

Benefits

- The lamp power can be dimmed from 1 to 100% via the Analog control input (in accordance with the 1-10 V industry standard)
- Compliant with European and Asian norms and suitable for emergency lighting systems
- HF operation improves light quality, lamp lifetime
- Combined with controls, additional energy savings can be achieved

Features

- Programmed start: flicker-free ignition < 0.5 seconds and striation-free operation, no stroboscopic effects. Preheating the lamp electrodes enables the lamps to be switched on and off without reducing life
- Smart power ensures constant light, independent of mains fluctuations
- Up to 60% reduction in energy consumption by using automatic lighting control systems
- Stop circuit is activated within 5 seconds in the event of lamp failure (safety stop), and ballast resets automatically after lamp replacement

HF-Regulator II for PL-L lamps

Application

- Indoor, general and task lighting applications in combination with lighting control systems (personal control, daylight linking and/or movement detection)

Versions



HF-R Analog 180 TL5/PLL
220-240V 50/60Hz

Dimensional drawing

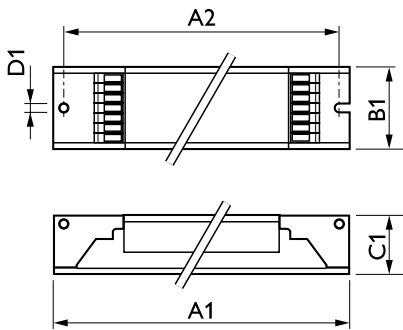

| Product | D1 | C1 | A1 | A2 | B1 |
|--|--------|-------|--------|--------|-------|
| HF-R 280 TL5/PL-L EII 220-240V 50/60Hz | 4.2 mm | 22 mm | 425 mm | 415 mm | 30 mm |
| HF-R 180 TL5/PL-L EII 220-240V 50/60Hz | 4.2 mm | 22 mm | 360 mm | 350 mm | 30 mm |

Approval and application

| | |
|-------------------------|--------|
| Energy Efficiency Index | A1 BAT |
|-------------------------|--------|

Operating and electrical

| | |
|-----------------|--------------|
| Input Frequency | 50 to 60 Hz |
| Input Voltage | 220 to 240 V |

General information

| | |
|-----------|----------|
| Lamp Type | TL5/PL-L |
|-----------|----------|

System characteristics

| | |
|--------------------------|------|
| Rated Ballast-Lamp Power | 80 W |
|--------------------------|------|

General information

| Order Code | Full Product Name | Number Of Products On MCB (16A Type B) (Nom) | Number Of Lamps |
|--------------|--|--|-----------------|
| 913700609066 | HF-R 180 TL5/PL-L EII 220-240V 50/60Hz | 12 | 1 piece/unit |

| Order Code | Full Product Name | Number Of Products On MCB (16A Type B) (Nom) | Number Of Lamps |
|--------------|--|--|-----------------|
| 913700609166 | HF-R 280 TL5/PL-L EII 220-240V 50/60Hz | 9 | 2 piece/unit |

Mechanical and housing

HF-Regulator II for PL-L lamps

| Order Code | Full Product Name | Housing |
|--------------|--|-------------|
| 913700609066 | HF-R 180 TL5/PL-L EII 220-240V 50/60Hz | L 360x30x21 |

| Order Code | Full Product Name | Housing |
|--------------|--|-------------|
| 913700609166 | HF-R 280 TL5/PL-L EII 220-240V 50/60Hz | L 425x30x21 |

