



Affordable, robust solution

HF-Selectalume II for PL-T/C Strain Relief

HF-Selectalume II independent version is the most cost-effective, reliable, slim and affordable fluorescent solution, with highly disruptive technology for energy saving, system flexibility and unsurpassed performance. The cost-saving HF-Selectalume II PLTC SR has a robust design which meets all relevant international safety and performance standards. The HF-S II strain relief is optimized mainly for PL-T/C lamps. HF-Selectalume II is intended for use with indoor lighting fixtures such as spotlights, downlights and recessed luminaires, which are largely used in office, retail, industry, hotel, restaurant and other applications. The ballast is primarily designed for Indoor application. For outdoor application, the luminaire should be minimum Class II need to be sufficiently protected against water & dust. The installation should also be guard against any lightening surge or any other necessary electrical protection as deemed in such typical installation & application.

Benefits

- The HF-SII 2x18/26W PL-T/C/T5c range has a robust design and meets internal safety, EMC and temperature protection requirements
- Automatic restart (after voltage dip or lamp replacement) ensures easy operation and hassle-free re-lamping (only for 2-lamp ballasts)
- DC emergency operation in line with IEC/EN 60598-2-22 luminaire norms (only for 2-lamp ballasts)
- Integrated terminal cover and strain relief

Features

- Complies with CE and ENEC (only for 2-lamp ballasts)
- Robust design – over 70,000 hours lifetime at Ta=50 °C and over 50,000 on/off switching operations on one lamp (only for 2-lamp ballasts)
- Energy efficiency class: A2
- Active power factor correction to ensure constant light, irrespective of mains-voltage fluctuations (only for 2-lamp ballasts)

HF-Selectalume II for PL-T/C Strain Relief

Application

- Commercial indoor lighting applications such as retail stores, office buildings, supermarkets, hotels, convenience stores and industrial premises with long operating hours (e.g. in corridors)
- In luminaires of protection class I and II such as spotlights, downlights and recessed
- Suitable for operation with movement-detection control systems like Philips OccuSwitch or in applications with frequentswitching activity (on/off) (only for 2-lamp ballasts)

Versions



GPPR HFSIISR 0001

Dimensional drawing

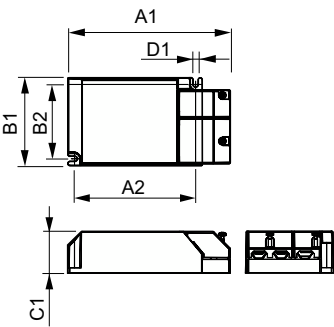

Product	D1	C1	A1	A2	B1	B2
HF-S 1/226 PL-T/C II SR 220-240V 50/60Hz	4.0 mm	32.0 mm	125.5 mm	93.5 mm	67.8 mm	57.5 mm

Product details

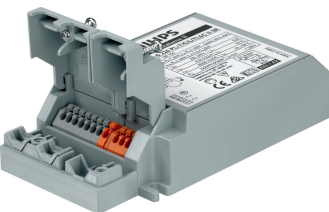

HF-S II SR

HF-Selectalume II for PL-T/C Strain Relief

