



TPS498 X-tend

X-tend TPS498 C

X-tend surface and suspended-mounted luminaires The Philips X-tend family of surface and suspended-mounted luminaires has the perfect combination of cutting-edge technology, functional brilliance and aesthetic appeal. The secret behind X-tend's superb lighting qualities lies in its optic - based on specially designed 3-dimensional curves that offer highly efficient light distribution. X-tend meets most ceiling void restrictions, allowing architects and engineers ultimate design flexibility. TPS498 These range of high-performance luminaires is suitable for TL-D or TL5 fluorescent lamps and a wide range of optics. Optics are supplied with the luminaire on request with a choice of direct, direct/indirect lighting. Optics for asymmetrical lighting can be used in combination with a top mirror for higher performance on request. Straight coupling pieces allow connection of luminaires in a line. There are two different top covers: cover-solid and PC-indirect (D/I version). The luminaire is developed with ease of installation in mind, it can be suspended without removing the optic and lamp during installation.

Features

- Wide selection of best-in-class optics, customized to meet your specific needs
- Choice of fluorescent lamps, TL5 or TL-D, efficiency optimized with TL5 version
- High-quality finishing for a high quality appearance
- Philips V-clip and light weight design, eases installation and maintenance
- Direct/indirect lighting, greater beam control
- Top mirror on request for higher performance
- Pre-fitted optics for quick installation
- Accessories offer flexibility in application

Application

- Office spaces
- Public buildings
- Schools
- Hospitals

X-tend TPS498 C

Versions



Dimensional drawing

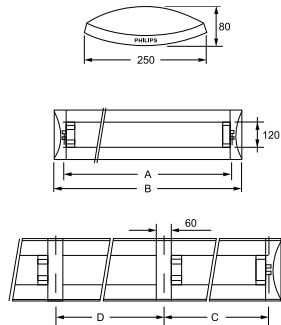

TPS498 C

Product	A	B	C	D
TPS498 C 1xTL5-28W/840 HFP D/I M6 FU	1188 mm	1286 mm	1208 mm	1228 mm
TPS498 C 2xTL-D36W HFE D/I C6	1240 mm	1388 mm	1260 mm	1280 mm
TPS498 C 2xTL-D58W HFP D D6 FTB	1540 mm	1638 mm	1560 mm	1580 mm
TPS498 1xTL5-35W/840 HFP D6 FU	1488 mm	1620 mm	1508 mm	1528 mm
TPS498 C 2xTL5-35W HFP D/I D6 FTB	1488 mm	1620 mm	1508 mm	1528 mm
TPS498 C 2xTL-D36W HFE D/I D6	1240 mm	1388 mm	1260 mm	1280 mm
TPS498 C 2xTL-D58W HFP D/I M2 FTB	1540 mm	1638 mm	1560 mm	1580 mm
TPS498 C 2xTL5-35W HFE D M6	1488 mm	1620 mm	1508 mm	1528 mm
TPS498 C 2xTL-D58W HFP D/I D6 FTB	1540 mm	1638 mm	1560 mm	1580 mm
TPS498 C 1xTL5-35W/840 HFP D/I D6 FU	1488 mm	1620 mm	1508 mm	1528 mm
TPS498 C 2xTL5-28W HFE D M2	1188 mm	1286 mm	1208 mm	1228 mm
TPS498 C 2xTL5-28W/840 HFP D/I D6 FU	1188 mm	1286 mm	1208 mm	1228 mm
TPS498 C 2xTL5-28W HFE D M6	1188 mm	1286 mm	1208 mm	1228 mm
TPS498 C 2xTL5-35W/840 HFP M6 FU	1488 mm	1620 mm	1508 mm	1528 mm
TPS498 C 1xTL5-28W/840 HFP D/I D6 FU	1188 mm	1286 mm	1208 mm	1228 mm
TPS498 C 2xTL5-35W/840 HFP D/I D6 FU	1488 mm	1620 mm	1508 mm	1528 mm
TPS498 C 2xTL-D36W HFP D D6 FTB	1240 mm	1388 mm	1260 mm	1280 mm
TPS498 C 2xTL5-28W HFP D M6 FTB	1188 mm	1286 mm	1208 mm	1228 mm
TPS498 C 2xTL-D36W HFP D/I C6	1240 mm	1388 mm	1260 mm	1280 mm
TPS498 C 2xTL-D58W HFP D M2 FTB	1540 mm	1638 mm	1560 mm	1580 mm
TPS498 C 2xTL-D36W HFP D/I M6 FTB	1240 mm	1388 mm	1260 mm	1280 mm
TPS498 C 2xTL5-28W HFP D/I M6	1188 mm	1286 mm	1208 mm	1228 mm
TPS498 C 2xTL-D36W HFP D M6 FTB	1240 mm	1388 mm	1260 mm	1280 mm
TPS498 C 2xTL5-28W HFP D/I M2 FTB	1188 mm	1286 mm	1208 mm	1228 mm
TPS498 C 2xTL5-28W HFE D/I M6 FTB	1188 mm	1286 mm	1208 mm	1228 mm
TPS498 C 2xTL5-28W HFE D C6	1188 mm	1286 mm	1208 mm	1228 mm
TPS498 C 1xTL5-35W/840 HFP D/I M6 FU	1488 mm	1620 mm	1508 mm	1528 mm
TPS498 C 2xTL5-28W HFE D/I D6 FTB	1188 mm	1286 mm	1208 mm	1228 mm
TPS498 C 2xTL-D58W HFP D/I M6 FTB	1540 mm	1638 mm	1560 mm	1580 mm
TPS498 C 2xTL5-35W/840 HFP D/I M6 FU	1488 mm	1620 mm	1508 mm	1528 mm
TPS498 C 2xTL-D36W HFP D/I D6 FTB	1240 mm	1388 mm	1260 mm	1280 mm
TPS498 C 2xTL5-28W HFP D/I D6	1188 mm	1286 mm	1208 mm	1228 mm
TPS498 C 1xTL5-28W/840 HFP M6 FU	1188 mm	1286 mm	1208 mm	1228 mm
TPS498 C 2xTL5-28W HFE D D6	1188 mm	1286 mm	1208 mm	1228 mm
TPS498 C 2xTL5-28W HFA D/I M6	1188 mm	1286 mm	1208 mm	1228 mm
TPS498 C 2xTL5-35W/840 HFP D6 FU	1488 mm	1620 mm	1508 mm	1528 mm
TPS498 C 2xTL-D58W HFP D M6 FTB	1540 mm	1638 mm	1560 mm	1580 mm
TPS498 C 2xTL5-28W/840 HFP M6 FU	1188 mm	1286 mm	1208 mm	1228 mm
TPS498 C 2xTL5-28W HFE D/I M2 FTB	1188 mm	1286 mm	1208 mm	1228 mm
TPS498 C 1xTL5-28W/840 HFP D6 FU	1188 mm	1286 mm	1208 mm	1228 mm
TPS498 C 1xTL5-35W/840 HFP M6 FU	1488 mm	1620 mm	1508 mm	1528 mm
TPS498 C 2xTL-D36W HFE D/I M6	1240 mm	1388 mm	1260 mm	1280 mm
TPS498 C 2xTL5-28W HFE D/I M-D FTB	1188 mm	1286 mm	1208 mm	1228 mm
TPS498 C 2xTL5-28W HFE D/I C6 FTB	1188 mm	1286 mm	1208 mm	1228 mm
TPS498 C 2xTL5-28W/840 HFP D6 FU	1188 mm	1286 mm	1208 mm	1228 mm
WRONG CODE!	1488 mm	1620 mm	1508 mm	1528 mm
TPS498 C 2xTL5-28W/840 HFP D/I M6 FU	1188 mm	1286 mm	1208 mm	1228 mm

X-tend TPS498 C

Approval and Application

Ingress protection code IP20

General Information

Kombipack -
Number of light sources 2
Top reflector No

General Information

order code	Gear	Lamp family code	Lamp power	Optic type	Product Family Code	order code	Gear	Lamp family code	Lamp power	Optic type	Product Family Code
910403302280	HFA	TL5	28	M6	TPS498	911400630780	HFE	TL5	28	M6	TPS498
911400628580	HFE	TL-D	36	M6	-	911400630880	HFE	TL5	28	D6	TPS498
911400628680	HFE	TL-D	36	C6	TPS498	911400631080	HFE	TL5	28	M2	TPS498
911400630380	EBP	TL5	28	M6	TPS498	911400636480	EBP	TL5	28	M6-A	TPS498
911400630580	EBP	TL5	28	D6	TPS498	911400636880	HFE	TL5	28	D6	TPS498

