



Maximum dimming versatility

Mark 7 0-10V

The Mark 7 0-10V series of dimmable electronic ballasts offer maximum versatility by incorporating separate control leads for use with a wide array of controllers, including occupancy sensors, daylight harvesting controls, and building management systems from more than 40 manufacturers. When paired with linear fluorescent and 4-pin compact fluorescent lamps, these ballasts optimize the benefits of such popular sustainable lighting techniques as daylight harvesting, occupancy sensing, and load shedding to satisfy the need for an affordable, flexible and versatile controllable lighting solution.

Benefits

- Compatible with controls from numerous manufacturers using standard 0-10VDC controls
- Ideal for frequent switching applications such as occupancy sensors and daylight harvesting - Programmed start operation

Features

- Available in linear fluorescent and 4-pin compact fluorescent models
- Full range continuous dimming (100% light output down to 5% - T5/HO to 1%)
- IntelliVolt technology (120 - 277V, 50/60Hz)

Application

- Conference rooms, private offices, auditoriums, architectural cove, auditoriums, educational facilities, hotels, restaurants, and department stores

Mark 7 0-10V

Versions

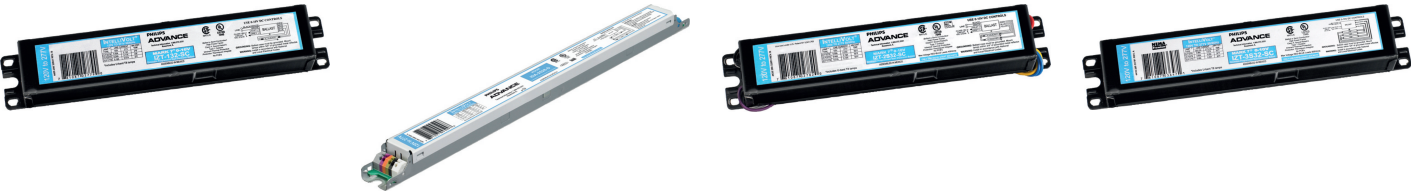

IZT132SC35M

IZT180D35M

GZT2S32SC35M

GZT3S32SC35M

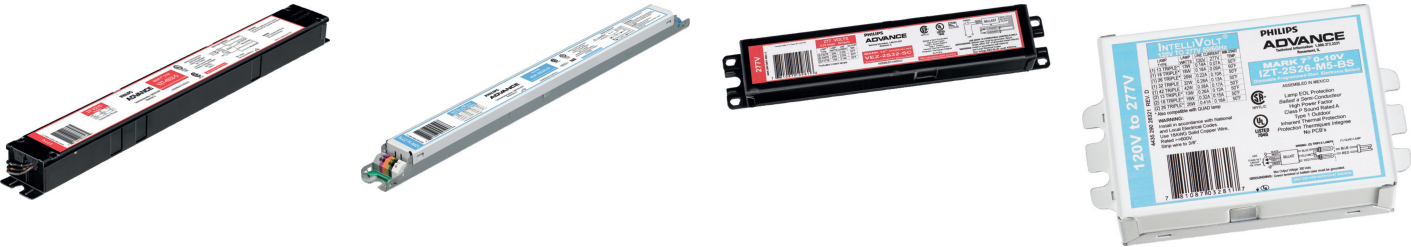

IZT4PSP32G35M

IZT2S54D35M

IZT154D35M

IZT2S26M5BS35M



IZT2S26M5LD35M

IZT4S3235M

VZT4S32HL01M

Dimensional drawing

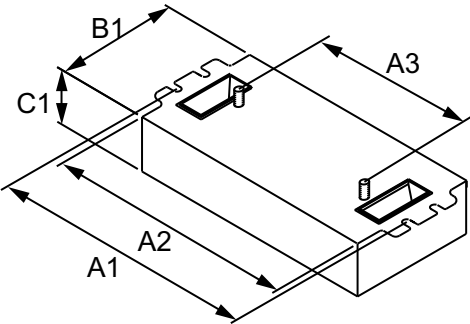

Product	A1	A2	A3	B1	C1
MARK 7 0-10V IZT2S26M5BS35M	4.55 in	4.20 in	2.00 in	3.00 in	1.29 in
MARK 7 0-10V IZT2T42M5BS35M	4.55 in	4.20 in	2.00 in	3.00 in	1.29 in

Mark 7 0-10V

Dimensional drawing

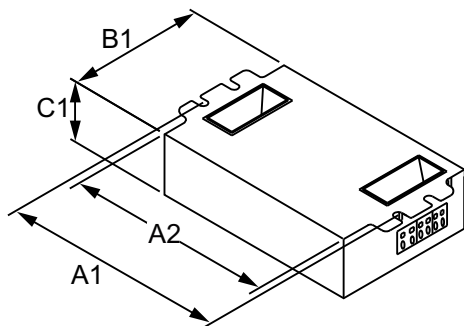
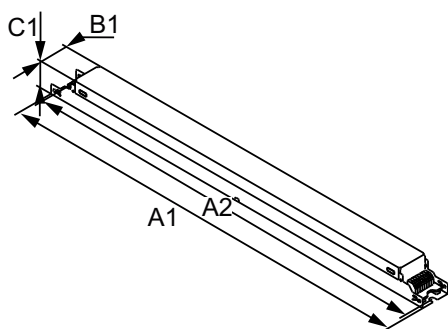
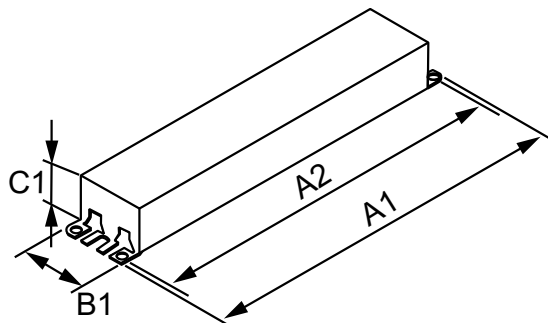

Product	A1	A2	B1	C1
MARK 7 0-10V IZT2PSP32SC35M	9.50 in	8.90 in	1.70 in	1.18 in
MARK 7 0-10V IZT4PSP32G35M	16.70 in	16.34 in	1.70 in	1.18 in
MARK 7 0-10V GZT3S32SC35M	9.5 in	8.90 in	1.7 in	1.18 in
MARK 7 0-10V GZT2S32SC35M	9.5 in	8.90 in	1.7 in	1.18 in
MARK 7 0-10V IZT132SC35M	9.5 in	8.90 in	1.7 in	1.18 in
MARK 7 0-10V IZT2TTS40SC35M	9.5 in	8.90 in	1.7 in	1.18 in
MARK 7 0-10V VZT4S32HL01M	16.70 in	16.34 in	1.18 in	1.00 in
MARK 7 0-10V IZT3PSP32SC35M	9.50 in	8.90 in	1.70 in	1.18 in

Product	A1	A2	B1	C1
MARK 7 0-10V IZT154D35M	16.70 in	16.34 in	1.18 in	1.00 in
MARK 7 0-10V IZT2S24D35M	16.70 in	16.34 in	1.18 in	1.00 in
MARK 7 0-10V IZT124D35M	16.70 in	16.34 in	1.18 in	1.00 in
MARK 7 0-10V IZT2S54D35M	16.70 in	16.34 in	1.18 in	1.00 in
MARK 7 0-10V IZT2S28D35M	16.70 in	16.34 in	1.18 in	1.00 in
MARK 7 0-10V IZT128D35M	16.70 in	16.34 in	1.18 in	1.00 in
MARK 7 0-10V VZT4S32HL01M	16.70 in	16.34 in	1.18 in	1.00 in
MARK 7 0-10V IZT4S3235M	16.70 in	16.34 in	1.18 in	1.00 in

Product	A1	A2	B1	C1
MARK 7 0-10V IZT2T42M5LD35M	4.55 in	4.20 in	3.00 in	1.29 in
MARK 7 0-10V IZT2S26M5LD35M	4.55 in	4.20 in	3.00 in	1.29 in

Operating and Electrical

Input Frequency	50 to 60 Hz
Total Harmonic Distortion USA	10 %

Operating and Electrical

Order Code	Full Product Name	Input Voltage
183749	MARK 7 0-10V ELE DIMMING BALLAST (1) F32T8 120-277V	120 to 277 V
108928	MARK 7 0-10V ELE DIMMING BALLAST (1) F28T5 120-277V	120 to 277 V
108936	MARK 7 0-10V ELE DIMMING BALLAST (2) F28T5 120-277V	120 to 277 V
109777	MARK 7 0-10V ELE DIMMING BALLAST (2) F32T8 347V	347 V
504548	MARK 7 0-10V ELE DIMMING BALLAST (2) F32T8 120-277V	120 to 277 V
504092	MARK 7 0-10V ELE DIMMING BALLAST(3)F32T8 120-277V	120 to 277 V
118794	MARK 7 0-10V ELE DIM BAL (2) 40W CFL (4-PIN) 120-277V	120 to 277 V
109785	MARK 7 0-10V ELE DIMMING BALLAST (3) F32T8 347V	347 V

Order Code	Full Product Name	Input Voltage
504522	MARK 7 0-10V ELE DIMMING BALLAST (4) F32T8 120-277V	120 to 277 V
258566	MARK 7 0-10V ELE DIMMING BALLAST (2) F54T5HO 120-277V	120 to 277 V
502336	MARK 7 0-10V ELE DIMMING BALLAST (1) F24T5HO 120-277V	120 to 277 V
502369	MARK 7 0-10V ELE DIMMING BALLAST (2) F24T5HO 120-277V	120 to 277 V

Mark 7 0-10V

Order Code	Full Product Name	Input Voltage
258558	MARK 7 0-10V ELE DIMMING BALLAST (1) F54T5HO 120-277V	120 to 277 V
114603	MARK 7 0-10V ELE DIM BAL (2) 26W CFL (4-PIN) 120-277V	120 to 277 V
120253	MARK 7 0-10V ELE DIM BAL (2) 42W CFL (4-PIN) 120-277V	120 to 277 V

General Information

Order Code	Full Product Name	Number Of Lamps	Lamp Type
183749	MARK 7 0-10V ELE DIMMING BALLAST (1) F32T8 120-277V	1 piece/unit	F32T8
108928	MARK 7 0-10V ELE DIMMING BALLAST (1) F28T5 120-277V	1 piece/unit	F28T5
108936	MARK 7 0-10V ELE DIMMING BALLAST (2) F28T5 120-277V	2 piece/unit	F28T5
109777	MARK 7 0-10V ELE DIMMING BALLAST (2) F32T8 347V	2 piece/unit	F32T8
504548	MARK 7 0-10V ELE DIMMING BALLAST (2) F32T8 120-277V	2 piece/unit	F32T8
504092	MARK 7 0-10V ELE DIMMING BALLAST(3)F32T8 120-277V	3 piece/unit	F32T8
118794	MARK 7 0-10V ELE DIM BAL (2) 40W CFL (4-PIN) 120-277V	2 piece/unit	FT40W/2G11
109785	MARK 7 0-10V ELE DIMMING BALLAST (3) F32T8 347V	3 piece/unit	F32T8
504522	MARK 7 0-10V ELE DIMMING BALLAST (4) F32T8 120-277V	4 piece/unit	F32T8
258566	MARK 7 0-10V ELE DIMMING BALLAST (2) F54T5HO 120-277V	2 piece/unit	F54T5HO

Mechanical and Housing

Order Code	Full Product Name	Housing
183749	MARK 7 0-10V ELE DIMMING BALLAST (1) F32T8 120-277V	SC
108928	MARK 7 0-10V ELE DIMMING BALLAST (1) F28T5 120-277V	D
108936	MARK 7 0-10V ELE DIMMING BALLAST (2) F28T5 120-277V	D
109777	MARK 7 0-10V ELE DIMMING BALLAST (2) F32T8 347V	SC
504548	MARK 7 0-10V ELE DIMMING BALLAST (2) F32T8 120-277V	SC
504092	MARK 7 0-10V ELE DIMMING BALLAST(3)F32T8 120-277V	SC
118794	MARK 7 0-10V ELE DIM BAL (2) 40W CFL (4-PIN) 120-277V	SC
109785	MARK 7 0-10V ELE DIMMING BALLAST (3) F32T8 347V	SC
504522	MARK 7 0-10V ELE DIMMING BALLAST (4) F32T8 120-277V	G
258566	MARK 7 0-10V ELE DIMMING BALLAST (2) F54T5HO 120-277V	D

Order Code	Full Product Name	Input Voltage
114611	MARK 7 0-10V ELE DIM BAL (2) 26W CFL (4-PIN) 120-277V	120 to 277 V
119891	MARK 7 0-10V ELE DIM BAL (2) 42W CFL (4-PIN) 120-277V	120 to 277 V
114637	MARK 7 0-10V ELE DIMMING BALLAST (4) F32T8 120-277V	120 to 277 V
199927	MARK 7 0-10V ELE DIMMING BALLAST (4) F32T8 277V	277 V

Order Code	Full Product Name	Number Of Lamps	Lamp Type
502336	MARK 7 0-10V ELE DIMMING BALLAST (1) F24T5HO 120-277V	1 piece/unit	F24T5/HO
502369	MARK 7 0-10V ELE DIMMING BALLAST (2) F24T5HO 120-277V	2 piece/unit	F24T5/HO
258558	MARK 7 0-10V ELE DIMMING BALLAST (1) F54T5HO 120-277V	1 piece/unit	F24T5/HO
114603	MARK 7 0-10V ELE DIM BAL (2) 26W CFL (4-PIN) 120-277V	1/2 piece/unit	CFQ26W/ G24Q
120253	MARK 7 0-10V ELE DIM BAL (2) 42W CFL (4-PIN) 120-277V	1/2 piece/unit	CFTR42W/ GX24Q
114611	MARK 7 0-10V ELE DIM BAL (2) 26W CFL (4-PIN) 120-277V	1/2 piece/unit	CFQ26W/ G24Q
119891	MARK 7 0-10V ELE DIM BAL (2) 42W CFL (4-PIN) 120-277V	1/2 piece/unit	CFTR42W/ GX24Q
114637	MARK 7 0-10V ELE DIMMING BALLAST (4) F32T8 120-277V	4 piece/unit	F32T8
199927	MARK 7 0-10V ELE DIMMING BALLAST (4) F32T8 277V	4 piece/unit	F32T8

Order Code	Full Product Name	Housing
502336	MARK 7 0-10V ELE DIMMING BALLAST (1) F24T5HO 120-277V	D
502369	MARK 7 0-10V ELE DIMMING BALLAST (2) F24T5HO 120-277V	D
258558	MARK 7 0-10V ELE DIMMING BALLAST (1) F54T5HO 120-277V	D
114603	MARK 7 0-10V ELE DIM BAL (2) 26W CFL (4-PIN) 120-277V	M5
120253	MARK 7 0-10V ELE DIM BAL (2) 42W CFL (4-PIN) 120-277V	M5
114611	MARK 7 0-10V ELE DIM BAL (2) 26W CFL (4-PIN) 120-277V	M5
119891	MARK 7 0-10V ELE DIM BAL (2) 42W CFL (4-PIN) 120-277V	M5
114637	MARK 7 0-10V ELE DIMMING BALLAST (4) F32T8 120-277V	D
199927	MARK 7 0-10V ELE DIMMING BALLAST (4) F32T8 277V	D

Mark 7 0-10V

