



Maximum dimming versatility

Mark 7 0-10V

The Mark 7 0-10V series of dimmable electronic ballasts offer maximum versatility by incorporating separate control leads for use with a wide array of controllers, including occupancy sensors, daylight harvesting controls, and building management systems from more than 40 manufacturers. When paired with linear fluorescent and 4-pin compact fluorescent lamps, these ballasts optimize the benefits of such popular sustainable lighting techniques as daylight harvesting, occupancy sensing, and load shedding to satisfy the need for an affordable, flexible and versatile controllable lighting solution.

Benefits

- Compatible with controls from numerous manufacturers using standard 0-10VDC controls
- Ideal for frequent switching applications such as occupancy sensors and daylight harvesting - Programmed start operation

Features

- Available in linear fluorescent and 4-pin compact fluorescent models
- Full range continuous dimming (100% light output down to 5% - T5/HO to 1%)
- IntelliVolt technology (120 - 277V, 50/60Hz)

Application

- Conference rooms, private offices, auditoriums, architectural cove, auditoriums, educational facilities, hotels, restaurants, and department stores

Mark 7 0-10V

Versions

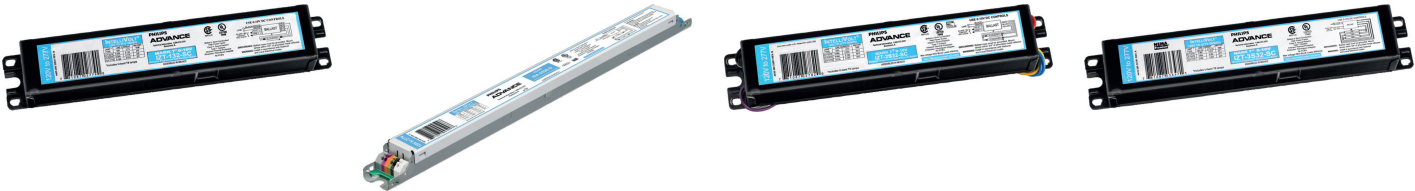

IZT132SC35M

IZT180D35M

GZT2S32SC35M

GZT3S32SC35M

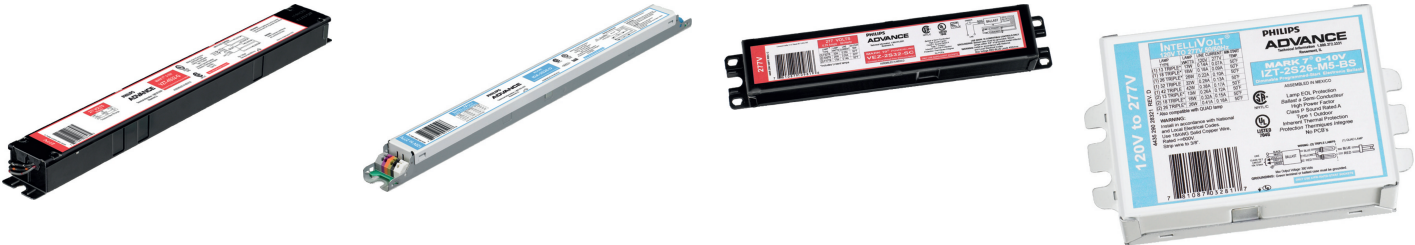

IZT4PSP32G35M

IZT2S54D35M

IZT154D35M

IZT2S26M5BS35M



IZT2S26M5LD35M

IZT4S3235M

VZT4S32HL01M

Mark 7 0-10V

Dimensional drawing

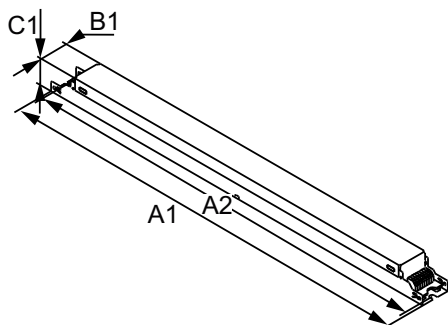
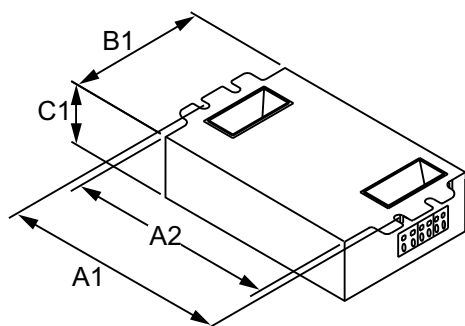
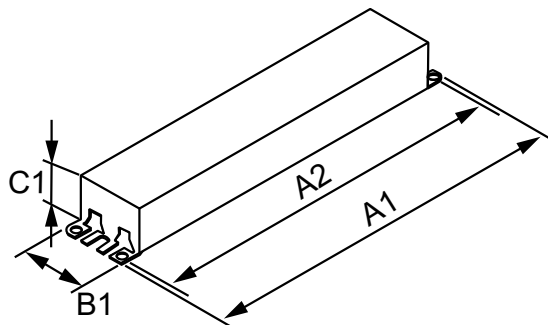

Product	A1	A2	B1	C1
MARK 7 0-10V ELE DIMMING BALLAST (1) F32T8 120-277V	9.5 in	8.90 in	1.7 in	1.18 in
MARK 7 0-10V ELE DIM BAL (2) 40W CFL (4-PIN) 120-277V	9.5 in	8.90 in	1.7 in	1.18 in
MARK 7 0-10V ELE DIMMING BALLAST (4) F32T8 277V	16.70 in	16.34 in	1.18 in	1.00 in
MARK 7 0-10V ELE DIMMING BALLAST (1) F32T8 120-277V	9.5 in	8.90 in	1.7 in	1.18 in
MARK 7 0-10V ELE DIMMING BALLAST(3)F32T8 120-277V	9.50 in	8.90 in	1.70 in	1.18 in
MARK 7 0-10V ELE DIMMING BALLAST(3)F32T8 120-277V	9.50 in	8.90 in	1.70 in	1.18 in
MARK 7 0-10V ELE DIMMING BALLAST (2) F32T8 120-277V	9.50 in	8.90 in	1.70 in	1.18 in
MARK 7 0-10V ELE DIMMING BALLAST (2) F32T8 120-277V	9.50 in	8.90 in	1.70 in	1.18 in
MARK 7 0-10V ELE DIMMING BALLAST (4) F32T8 120-277V	16.70 in	16.34 in	1.70 in	1.18 in
MARK 7 0-10V ELE DIMMING BALLAST (3) F32T8 347V	9.5 in	8.90 in	1.7 in	1.18 in
MARK 7 0-10V ELE DIMMING BALLAST (2) F32T8 347V	9.5 in	8.90 in	1.7 in	1.18 in

Product	A1	A2	B1	C1
MARK 7 0-10V ELE DIM BAL (2) 42W CFL (4-PIN) 120-277V	4.55 in	4.20 in	3.00 in	1.29 in
MARK 7 0-10V ELE DIM BAL (2) 26W CFL (4-PIN) 120-277V	4.55 in	4.20 in	3.00 in	1.29 in

Product	A1	A2	B1	C1
MARK 7 0-10V ELE DIMMING BALLAST (4) F32T8 277V	16.70 in	16.34 in	1.18 in	1.00 in
MARK 7 0-10V ELE DIMMING BALLAST (4) F32T8 120-277V	16.70 in	16.34 in	1.18 in	1.00 in
MARK 7 0-10V ELE DIMMING BALLAST (1) F54T5HO 120-277V	16.70 in	16.34 in	1.18 in	1.00 in
MARK 7 0-10V ELE DIMMING BALLAST (2) F24T5HO 120-277V	16.70 in	16.34 in	1.18 in	1.00 in
MARK 7 0-10V ELE DIMMING BALLAST (1) F24T5HO 120-277V	16.70 in	16.34 in	1.18 in	1.00 in
MARK 7 0-10V ELE DIMMING BALLAST (2) F54T5HO 120-277V	16.70 in	16.34 in	1.18 in	1.00 in

Mark 7 0-10V

Dimensional drawing

Product	A1	A2	B1	C1
MARK 7 0-10V ELE DIMMING BALLAST (2) F28T5 120-277V	16.70 in	16.34 in	1.18 in	1.00 in
MARK 7 0-10V ELE DIMMING BALLAST (1) F28T5 120-277V	16.70 in	16.34 in	1.18 in	1.00 in

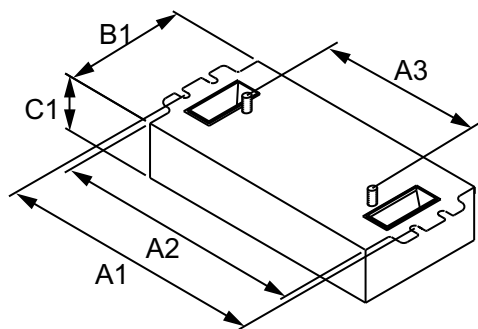

Operating and Electrical	
Input Frequency	50 to 60 Hz
Total Harmonic Distortion USA	10 %

Operating and Electrical

Order Code	Full Product Name	Input Voltage
IZT132SC35M	MARK 7 0-10V ELE DIMMING BALLAST (1) F32T8 120-277V	120 to 277 V
IZT132SC35I	MARK 7 0-10V ELE DIMMING BALLAST (1) F32T8 120-277V	120 to 277 V
IZT128D35M	MARK 7 0-10V ELE DIMMING BALLAST (1) F28T5 120-277V	120 to 277 V
IZT2S28D35M	MARK 7 0-10V ELE DIMMING BALLAST (2) F28T5 120-277V	120 to 277 V
GZT2S32SC35M	MARK 7 0-10V ELE DIMMING BALLAST (2) F32T8 347V	347 V
IZT2PSP32SC35I	MARK 7 0-10V ELE DIMMING BALLAST (2) F32T8 120-277V	120 to 277 V
IZT2PSP32SC35M	MARK 7 0-10V ELE DIMMING BALLAST (2) F32T8 120-277V	120 to 277 V
IZT3PSP32SC35I	MARK 7 0-10V ELE DIMMING BALLAST(3)F32T8 120-277V	120 to 277 V
IZT3PSP32SC35M	MARK 7 0-10V ELE DIMMING BALLAST(3)F32T8 120-277V	120 to 277 V
IZT2TTS40SC35M	MARK 7 0-10V ELE DIM BAL (2) 40W CFL (4-PIN) 120-277V	120 to 277 V
GZT3S32SC35M	MARK 7 0-10V ELE DIMMING BALLAST (3) F32T8 347V	347 V

General Information

Product	A1	A2	A3	B1	C1
MARK 7 0-10V ELE DIM BAL (2) 26W CFL (4-PIN) 120-277V	4.55 in	4.20 in	2.00 in	3.00 in	1.29 in
MARK 7 0-10V ELE DIM BAL (2) 42W CFL (4-PIN) 120-277V	4.55 in	4.20 in	2.00 in	3.00 in	1.29 in

Order Code	Full Product Name	Input Voltage
IZT4PSP32G35M	MARK 7 0-10V ELE DIMMING BALLAST (4) F32T8 120-277V	120 to 277 V
IZT2S54D35M	MARK 7 0-10V ELE DIMMING BALLAST (2) F54T5HO 120-277V	120 to 277 V
IZT124D35M	MARK 7 0-10V ELE DIMMING BALLAST (1) F24T5HO 120-277V	120 to 277 V
IZT2S24D35M	MARK 7 0-10V ELE DIMMING BALLAST (2) F24T5HO 120-277V	120 to 277 V
IZT154D35M	MARK 7 0-10V ELE DIMMING BALLAST (1) F54T5HO 120-277V	120 to 277 V
IZT2S26M5BS35M	MARK 7 0-10V ELE DIM BAL (2) 26W CFL (4-PIN) 120-277V	120 to 277 V
IZT2T42M5BS35M	MARK 7 0-10V ELE DIM BAL (2) 42W CFL (4-PIN) 120-277V	120 to 277 V
IZT2S26M5LD35M	MARK 7 0-10V ELE DIM BAL (2) 26W CFL (4-PIN) 120-277V	120 to 277 V
IZT2T42M5LD35M	MARK 7 0-10V ELE DIM BAL (2) 42W CFL (4-PIN) 120-277V	120 to 277 V
IZT4S3235M	MARK 7 0-10V ELE DIMMING BALLAST (4) F32T8 120-277V	120 to 277 V
VZT4S32HLO1M	MARK 7 0-10V ELE DIMMING BALLAST (4) F32T8 277V	277 V

Mark 7 0-10V

Order Code	Full Product Name	Number Of Lamps	Lamp Type
IZT132SC35M	MARK 7 0-10V ELE DIMMING BALLAST (1) F32T8 120-277V	1 piece/unit	F32T8
IZT132SC35I	MARK 7 0-10V ELE DIMMING BALLAST (1) F32T8 120-277V	1 piece/unit	F32T8
IZT128D35M	MARK 7 0-10V ELE DIMMING BALLAST (1) F28T5 120-277V	1 piece/unit	F28T5
IZT2S28D35M	MARK 7 0-10V ELE DIMMING BALLAST (2) F28T5 120-277V	2 piece/unit	F28T5
GZT2S32SC35M	MARK 7 0-10V ELE DIMMING BALLAST (2) F32T8 347V	2 piece/unit	F32T8
IZT2PSP32SC35I	MARK 7 0-10V ELE DIMMING BALLAST (2) F32T8 120-277V	2 piece/unit	F32T8
IZT2PSP32SC35M	MARK 7 0-10V ELE DIMMING BALLAST (2) F32T8 120-277V	2 piece/unit	F32T8
IZT3PSP32SC35I	MARK 7 0-10V ELE DIMMING BALLAST(3)F32T8 120-277V	3 piece/unit	F32T8
IZT3PSP32SC35M	MARK 7 0-10V ELE DIMMING BALLAST(3)F32T8 120-277V	3 piece/unit	F32T8
IZT2TTS40SC35M	MARK 7 0-10V ELE DIM BAL (2) 40W CFL (4-PIN) 120-277V	2 piece/unit	FT40W/2G11
GZT3S32SC35M	MARK 7 0-10V ELE DIMMING BALLAST (3) F32T8 347V	3 piece/unit	F32T8

Order Code	Full Product Name	Number Of Lamps	Lamp Type
IZT4PSP32G35M	MARK 7 0-10V ELE DIMMING BALLAST (4) F32T8 120-277V	4 piece/unit	F32T8
IZT2S54D35M	MARK 7 0-10V ELE DIMMING BALLAST (2) F54T5HO 120-277V	2 piece/unit	F54T5HO
IZT124D35M	MARK 7 0-10V ELE DIMMING BALLAST (1) F24T5HO 120-277V	1 piece/unit	F24T5/HO
IZT2S24D35M	MARK 7 0-10V ELE DIMMING BALLAST (2) F24T5HO 120-277V	2 piece/unit	F24T5/HO
IZT154D35M	MARK 7 0-10V ELE DIMMING BALLAST (1) F54T5HO 120-277V	1 piece/unit	F24T5/HO
IZT2S26M5BS35M	MARK 7 0-10V ELE DIM BAL (2) 26W CFL (4-PIN) 120-277V	1/2 piece/unit	CFQ26W/G24Q
IZT2T42M5BS35M	MARK 7 0-10V ELE DIM BAL (2) 42W CFL (4-PIN) 120-277V	1/2 piece/unit	CFTR42W/GX24Q
IZT2S26M5LD35M	MARK 7 0-10V ELE DIM BAL (2) 26W CFL (4-PIN) 120-277V	1/2 piece/unit	CFQ26W/G24Q
IZT2T42M5LD35M	MARK 7 0-10V ELE DIM BAL (2) 42W CFL (4-PIN) 120-277V	1/2 piece/unit	CFTR42W/GX24Q
IZT4S3235M	MARK 7 0-10V ELE DIMMING BALLAST (4) F32T8 120-277V	4 piece/unit	F32T8
VZT4S32HLO1M	MARK 7 0-10V ELE DIMMING BALLAST (4) F32T8 277V	4 piece/unit	F32T8

Mechanical and Housing

Order Code	Full Product Name	Housing
IZT132SC35M	MARK 7 0-10V ELE DIMMING BALLAST (1) F32T8 120-277V	SC
IZT132SC35I	MARK 7 0-10V ELE DIMMING BALLAST (1) F32T8 120-277V	SC
IZT128D35M	MARK 7 0-10V ELE DIMMING BALLAST (1) F28T5 120-277V	D
IZT2S28D35M	MARK 7 0-10V ELE DIMMING BALLAST (2) F28T5 120-277V	D
GZT2S32SC35M	MARK 7 0-10V ELE DIMMING BALLAST (2) F32T8 347V	SC
IZT2PSP32SC35I	MARK 7 0-10V ELE DIMMING BALLAST (2) F32T8 120-277V	SC
IZT2PSP32SC35M	MARK 7 0-10V ELE DIMMING BALLAST (2) F32T8 120-277V	SC
IZT3PSP32SC35I	MARK 7 0-10V ELE DIMMING BALLAST(3)F32T8 120-277V	SC
IZT3PSP32SC35M	MARK 7 0-10V ELE DIMMING BALLAST(3)F32T8 120-277V	SC
IZT2TTS40SC35M	MARK 7 0-10V ELE DIM BAL (2) 40W CFL (4-PIN) 120-277V	SC
GZT3S32SC35M	MARK 7 0-10V ELE DIMMING BALLAST (3) F32T8 347V	SC
IZT4PSP32G35M	MARK 7 0-10V ELE DIMMING BALLAST (4) F32T8 120-277V	G
IZT2S54D35M	MARK 7 0-10V ELE DIMMING BALLAST (2) F54T5HO 120-277V	D

Order Code	Full Product Name	Housing
IZT124D35M	MARK 7 0-10V ELE DIMMING BALLAST (1) F24T5HO 120-277V	D
IZT2S24D35M	MARK 7 0-10V ELE DIMMING BALLAST (2) F24T5HO 120-277V	D
IZT154D35M	MARK 7 0-10V ELE DIMMING BALLAST (1) F54T5HO 120-277V	D
IZT2S26M5BS35M	MARK 7 0-10V ELE DIM BAL (2) 26W CFL (4-PIN) 120-277V	M5
IZT2T42M5BS35M	MARK 7 0-10V ELE DIM BAL (2) 42W CFL (4-PIN) 120-277V	M5
IZT2S26M5LD35M	MARK 7 0-10V ELE DIM BAL (2) 26W CFL (4-PIN) 120-277V	M5
IZT2T42M5LD35M	MARK 7 0-10V ELE DIM BAL (2) 42W CFL (4-PIN) 120-277V	M5
IZT4S3235M	MARK 7 0-10V ELE DIMMING BALLAST (4) F32T8 120-277V	D
VZT4S32HLO1M	MARK 7 0-10V ELE DIMMING BALLAST (4) F32T8 277V	D

Mark 7 0-10V

