

Reliable performance

Core & Coil (71A) MH 175W - 450W

The basic ballast is the open core and coil which is most often used as a component within a lighting luminaire. The core and coil also forms the nucleus of Philips Advance's five other ballast configurations.

Benefits

- Vacuum-pressure impregnation is used to re-enforce the electrical insulation of the ballast, preclude moisture, inhibit noise, and dissipate heat
- Pre-insulated voltage leads reduce the risk of shock and shrink installation time

Features

- Vacuum-pressure impregnated with a silica-filled polyester varnish
- All core and coil ballasts below 600W utilize a UL Class H (180°C) insulation system
- C and C ballasts 600W and higher utilize a UL Class N (200°C) insulation system
- Pre-insulated voltage leads
- Ballast kits supplied with pre-wired ignitor

Application

- High bay retail, manufacturing, gymnasiums, warehouses, parking structures, outdoor

Core & Coil (71A) MH 175W - 450W

Versions



General Information

Dimensional drawing

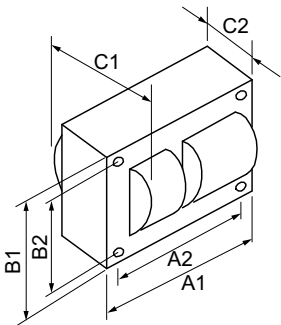

Product	C1	C2	A1	A2	B1	B2
CORE & COIL HID 71A60H1500DMLA	4.05 in	2.14 in	4.8 in	4.4 in	4.3 in	3.9 in
CORE & COIL HID 71A55H0500DML	3.87 in	2.4 in	3.9 in	3.5 in	2.8 in	2.4 in
CORE & COIL HID 71A6041001D	4 in	2.13 in	4.8 in	4.4 in	4.3 in	3.9 in
CORE & COIL HID 71A5771001D	4.2 in	3 in	3.9 in	3.5 in	2.8 in	2.4 in
CORE & COIL HID 71A6071001D	4 in	2.13 in	4.8 in	4.4 in	4.3 in	3.9 in
CORE & COIL HID 71A5741001D	4.2 in	3 in	3.9 in	3.5 in	2.8 in	2.4 in

Operating and Electrical	
Input Frequency	60 Hz
General Information	
Number Of Lamps	1 piece/unit

Operating and Electrical

Order Code	Full Product Name	Input Voltage
		480 V
		120/208/240/277 V

Order Code	Full Product Name	Input Voltage
		120/208/240/277 V
		480/120T V

