



# Reliable performance

## Core & Coil (71A) HPS 200W - 400W

The basic ballast is the open core and coil which is most often used as a component within a lighting luminaire. The core and coil also forms the nucleus of Philips Advance's five other ballast configurations.

### Benefits

- Vacuum-pressure impregnation is used to re-enforce the electrical insulation of the ballast, preclude moisture, inhibit noise, and dissipate heat
- Pre-insulated voltage leads reduce the risk of shock and shrink installation time

### Features

- Vacuum-pressure impregnated with a silica-filled polyester varnish
- All core and coil ballasts below 600W utilize a UL Class H (180°C) insulation system
- C and C ballasts 600W and higher utilize a UL Class N (200°C) insulation system
- Pre-insulated voltage leads
- Ballast kits supplied with pre-wired ignitor

### Application

- High bay retail, manufacturing, gymnasiums, warehouses, parking structures, outdoor

## Core & Coil (71A) HPS 200W - 400W

### Versions

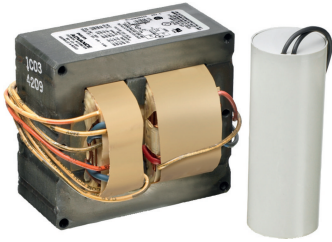

71A82N1500D

### Dimensional drawing

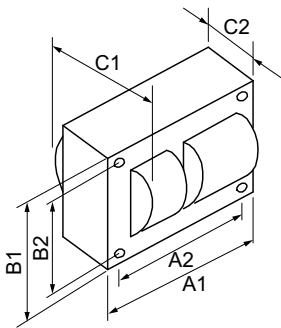

Product	C1	C2	A1	A2	B1	B2
CORE & COIL HID 71A84E6500D	4.40 in	2.65 in	4.8 in	4.4 in	4.3 in	3.9 in
CORE & COIL HID 71A82A1001D	3.60 in	1.94 in	4.8 in	4.4 in	4.3 in	3.9 in
CORE & COIL HID 71A84A3500D	4.10 in	2.30 in	4.8 in	4.4 in	4.3 in	3.9 in
CORE & COIL HID 71A8493500D	4 in	2.09 in	4.8 in	4.4 in	4.3 in	3.9 in
CORE & COIL HID 71A82A1500D	3.60 in	1.94 in	4.8 in	4.4 in	4.3 in	3.9 in
CORE & COIL HID 71A8493001DC	4.30 in	2.65 in	4.8 in	4.4 in	4.3 in	3.9 in
CORE & COIL HID 71A82N1500D	3.7 in	2.1 in	4.8 in	4.4 in	4.3 in	3.9 in
CORE & COIL HID 71A84N3500D	4.1 in	2.5 in	4.8 in	4.4 in	4.3 in	3.9 in
CORE & COIL HID 71A8443500DT	4 in	2.30 in	4.8 in	4.4 in	4.3 in	3.9 in
CORE & COIL HID 71A8291500DA	3.82 in	1.8 in	4.8 in	4.4 in	4.3 in	3.9 in
CORE & COIL HID 71A8493500DA	4.30 in	2.65 in	4.8 in	4.4 in	4.3 in	3.9 in
CORE & COIL HID 71A8453500D	4.84 in	2.65 in	4.8 in	4.4 in	4.3 in	3.9 in
CORE & COIL HID 71A8453001D	4.84 in	2.65 in	4.8 in	4.4 in	4.3 in	3.9 in
CORE & COIL HID 71A8251001D	3.6 in	2 in	4.8 in	4.4 in	4.3 in	3.9 in
CORE & COIL HID 71A8990500D	3 in	1.2 in	4.8 in	4.4 in	4.3 in	3.9 in
CORE & COIL HID 71A8443001D	4.3 in	2.8 in	4.8 in	4.4 in	4.3 in	3.9 in
CORE & COIL HID 71A8241001D	3.45 in	1.8 in	4.8 in	4.4 in	4.3 in	3.9 in
CORE & COIL HID 71A8473001D	4.30 in	2.65 in	4.8 in	4.4 in	4.3 in	3.9 in
CORE & COIL HID 71A8271001D	3.82 in	1.8 in	4.8 in	4.4 in	4.3 in	3.9 in
CORE & COIL HID 71A8970001D	3 in	1.2 in	4.8 in	4.4 in	4.3 in	3.9 in
CORE & COIL HID 71A84A3001D	4.10 in	2.30 in	4.8 in	4.4 in	4.3 in	3.9 in

#### General Information

Number Of Lamps 1 piece/unit

### Operating and Electrical

Order Code	Full Product Name	Input Frequency	Input Voltage
176180	CORE & COIL HID HPS BAL 250W S50 120/220-240V 50HZ C&C	50 Hz	120/230 V
175703	CORE & COIL HID HPS BAL 400W S51 QUAD KIT	60 Hz	120/208/240/277 V

Order Code	Full Product Name	Input Frequency	Input Voltage
180182	CORE & COIL HID HPS BAL 250W S50 120/277/347V C&C	60 Hz	120/277/347 V
180380	CORE & COIL HID HPS BAL 400W S51 480V/120T C&C	60 Hz	480/120T V

## Core & Coil (71A) HPS 200W - 400W

Order Code	Full Product Name	Input Frequency	Input Voltage
180430	CORE & COIL HID HPS BAL 400W S51 QUAD C&C	60 Hz	120/208/240/277 V
180455	CORE & COIL HID HPS BAL 400W S51 120/277/347V C&C	60 Hz	120/277/347 V
180547	CORE & COIL HID HPS BAL 400W S51 120/220-240V 50HZ C&C	50 Hz	120/230 V
192005	CORE & COIL HID HPS BAL 250W S50 120/277/347V KIT	60 Hz	120/277/347 V
192013	CORE & COIL HID HPS BAL 400W S51 120/277/347V KIT	60 Hz	120/277/347 V
193516	CORE & COIL HID HPS BAL 400W S51 120/208/240V C&C	60 Hz	120/208/240 V
193573	CORE & COIL HID HPS BAL 200W S66 QUAD KIT	60 Hz	120/208/240/277 V
190397	CORE & COIL HID HPS BAL 250W S50 QUAD KIT	60 Hz	120/208/240/277 V
190405	CORE & COIL HID HPS BAL 400W S51 QUAD KIT	60 Hz	120/208/240/277 V

Order Code	Full Product Name	Input Frequency	Input Voltage
190025	CORE & COIL HID HPS BAL 250W S50 480V/120T KIT	60 Hz	480 V
509497	CORE & COIL HID HPS BAL 400W S51 480V/120T KIT	60 Hz	480/120T V
505677	CORE & COIL HID HPS BAL 200W S66 QUAD C&C	60 Hz	120/208/240/277 V
490508	CORE & COIL HID HPS BAL 250W S50 5-TAP KIT	60 Hz	120/208/240/277/480 V
491704	CORE & COIL HID HPS BAL 400W S51 5-TAP KIT	60 Hz	120/208/240/277/480 V
491712	CORE & COIL HID HPS BAL 400W S51 5-TAP C&C	60 Hz	120/208/240/277/480 V
491902	CORE & COIL HID HPS BAL 400W S51 QUAD C&C	60 Hz	120/208/240/277 V
195446	CORE & COIL HID HPS BAL 250W S50 QUAD C&C	60 Hz	120/208/240/277 V

### General Information

Order Code	Full Product Name	Capacitor Value	Lamp Type
176180	CORE & COIL HID HPS BAL 250W S50 120/220-240V 50HZ C&C	40 MFD	250W HPS
175703	CORE & COIL HID HPS BAL 400W S51 QUAD KIT	55 MFD	400W HPS
180182	CORE & COIL HID HPS BAL 250W S50 120/277/347V C&C	35 MFD	250W HPS
180380	CORE & COIL HID HPS BAL 400W S51 480V/120T C&C	55 MFD	400W HPS
180430	CORE & COIL HID HPS BAL 400W S51 QUAD C&C	55 MFD	400W HPS
180455	CORE & COIL HID HPS BAL 400W S51 120/277/347V C&C	55 MFD	400W HPS
180547	CORE & COIL HID HPS BAL 400W S51 120/220-240V 50HZ C&C	64 MFD	400W HPS
192005	CORE & COIL HID HPS BAL 250W S50 120/277/347V KIT	35 MFD	250W HPS
192013	CORE & COIL HID HPS BAL 400W S51 120/277/347V KIT	55 MFD	400W HPS
193516	CORE & COIL HID HPS BAL 400W S51 120/208/240V C&C	48 MFD	400W HPS
193573	CORE & COIL HID HPS BAL 200W S66 QUAD KIT	28 MFD	200W HPS

Order Code	Full Product Name	Capacitor Value	Lamp Type
190397	CORE & COIL HID HPS BAL 250W S50 QUAD KIT	35 MFD	250W HPS
190405	CORE & COIL HID HPS BAL 400W S51 QUAD KIT	55 MFD	400W HPS
190025	CORE & COIL HID HPS BAL 250W S50 480V/120T KIT	35 MFD	250W HPS
509497	CORE & COIL HID HPS BAL 400W S51 480V/120T KIT	55 MFD	400W HPS
505677	CORE & COIL HID HPS BAL 200W S66 QUAD C&C	28 MFD	200W HPS
490508	CORE & COIL HID HPS BAL 250W S50 5-TAP KIT	35 MFD	250W HPS
491704	CORE & COIL HID HPS BAL 400W S51 5-TAP KIT	55 MFD	400W HPS
491712	CORE & COIL HID HPS BAL 400W S51 5-TAP C&C	55 MFD	400W HPS
491902	CORE & COIL HID HPS BAL 400W S51 QUAD C&C	55 MFD	400W HPS
195446	CORE & COIL HID HPS BAL 250W S50 QUAD C&C	35 MFD	250W HPS

## Core & Coil (71A) HPS 200W - 400W

