

# Reliable performance

## Core & Coil (71A) LPS

The basic ballast is the open core and coil which is most often used as a component within a lighting luminaire. The core and coil also forms the nucleus of Philips Advance's five other ballast configurations.

### Benefits

- Vacuum-pressure impregnation is used to re-enforce the electrical insulation of the ballast, preclude moisture, inhibit noise, and dissipate heat
- Pre-insulated voltage leads reduce the risk of shock and shrink installation time

### Features

- Vacuum-pressure impregnated with a silica-filled polyester varnish
- All core and coil ballasts below 600W utilize a UL Class H (180°C) insulation system
- C and C ballasts 600W and higher utilize a UL Class N (200°C) insulation system
- Pre-insulated voltage leads
- Ballast kits supplied with pre-wired ignitor

### Application

- High bay retail, manufacturing, gymnasiums, warehouses, parking structures, outdoor

# Core & Coil (71A) LPS

## Versions

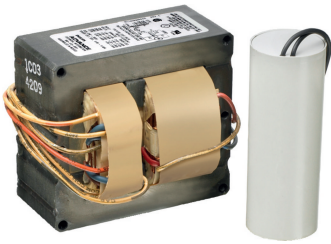

71A0490500D

## Dimensional drawing

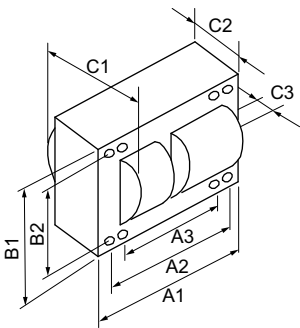
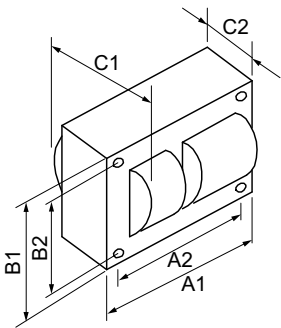

| Operating and Electrical |              |
|--------------------------|--------------|
| Input Frequency          | 60 Hz        |
| General Information      |              |
| Number Of Lamps          | 1 piece/unit |

## Operating and Electrical

| Order Code  | Full Product Name                              | Input Voltage     |
|-------------|--|-------------------|
| 71A0490001D | CORE & COIL HID LPS BAL 35/55W L70/71 QUAD KIT | 120/208/240/277 V |

| Product  | C1      | C2      | A1     | A2     | B1     | B2     |
|--|---------|---------|--------|--------|--------|--------|
| CORE & COIL HID LPS BAL 90W L72 QUAD C&C       | 3.25 in | 2.25 in | 4.8 in | 4.4 in | 4.3 in | 3.9 in |
| CORE & COIL HID LPS BAL 35/55W L70/71 QUAD KIT | 3.5 in  | 2.25 in | 3.9 in | 3.5 in | 2.8 in | 2.4 in |
| CORE & COIL HID LPS BAL 35/55W L70/71 QUAD C&C | 3.5 in  | 2.25 in | 3.9 in | 3.5 in | 2.8 in | 2.4 in |

| Product  | C1   | C2      | A1     | A2     | A3     | B1     | B2     | C3     |
|--|------|---------|--------|--------|--------|--------|--------|--------|
| CORE & COIL HID LPS BAL 135/180W L73/74 QUAD C&C     | 4 in | 2.35 in | 5.8 in | 5.4 in | 4.4 in | 4.3 in | 3.9 in | 1.3 in |
| CORE & COIL HID LPS BAL 135/180W L73/74 347/480V C&C | 4 in | 2.35 in | 5.8 in | 5.4 in | 4.4 in | 4.3 in | 3.9 in | 1.3 in |

## Core & Coil (71A) LPS

| Order Code  | Full Product Name                                       | Input Voltage     |
|-------------|---|-------------------|
| 71A07F0500D | CORE & COIL HID LPS BAL 135/180W L73/74<br>347/480V C&C | 347/480 V         |
| 71A0490510D | CORE & COIL HID LPS BAL 35/55W L70/71 QUAD<br>C&C       | 120/208/240/277 V |

| Order Code  | Full Product Name                                   | Input Voltage     |
|-------------|---|-------------------|
| 71A0790510D | CORE & COIL HID LPS BAL 135/180W L73/74 QUAD<br>C&C | 120/208/240/277 V |

### General Information

| Order Code  | Full Product Name                                       | Capacitor Value | Lamp Type |
|-------------|---|-----------------|-----------|
| 71A0490001D | CORE & COIL HID LPS BAL 35/55W<br>L70/71 QUAD KIT       | 14 MFD          | 55W LPS   |
| 71A0590500D | CORE & COIL HID LPS BAL 90W L72<br>QUAD C&C             | 17.5 MFD        | 90W LPS   |
| 71A07F0500D | CORE & COIL HID LPS BAL 135/180W<br>L73/74 347/480V C&C | 16 MFD          | 180W LPS  |

| Order Code  | Full Product Name                                   | Capacitor Value | Lamp Type |
|-------------|---|-----------------|-----------|
| 71A0490510D | CORE & COIL HID LPS BAL 35/55W<br>L70/71 QUAD C&C   | 14 MFD          | 55W LPS   |
| 71A0790510D | CORE & COIL HID LPS BAL 135/180W<br>L73/74 QUAD C&C | 16 MFD          | 180W LPS  |

