



CoreLine Waterproof – the clear choice for LED

CoreLine Waterproof

Whether for a new building or renovation of an existing space, customers want lighting solutions that provide quality of light and substantial energy and maintenance savings. The new CoreLine Waterproof range of LED products can be used to replace traditional waterproof luminaires with fluorescent lamps. The process of selecting, installing and maintaining is so easy – it's a simple switch.

Benefits

- Up to 50% energy savings compared with TL-D
- Reliable LED technology – maintenance-free
- Direct replacement for conventional waterproof luminaires in terms of light performance, installation flexibility and length

Features

- Reliable integrated LED technology, ensuring maintenance-free installation and a long lifetime
- Can be used to replace traditional waterproof luminaires ranging from 18 to 58 W TL-D
- Wide-beam light distribution
- Diffuser with optical element ensures visual comfort
- Ceiling-mounted bracket and suspension hooks included; installation can be made vandal-proof by additional screw fixation of mounting brackets

Application

- Parking garages
- Warehouses
- General lighting

CoreLine Waterproof

Warnings and Safety

- UV radiation will damage the material over time, resulting in loss of waterproof sealing and IP66 rating.
- Do not install the luminaire in locations where it will be exposed to direct sunlight.

Specifications

Ambient Temperature	0 to +25 °C
Dimming	No, yes
Driver	Power supply unit with DALI interface (PSD) Power supply unit (PSU)
Initial correlated colour temperature	4000 K

Initial input power	34 W, 35 W
Initial luminous flux	4000 lm
Material	Bracket:
Material	Housing: polycarbonate

Versions



CoreLine Waterproof WT120C G2
PCU-7DPP



CoreLine Waterproof WT120C G2
PCU-3DPP



CoreLine Waterproof WT120C G2
PCU-10DPP



CoreLine Waterproof WT120C G2
PCU-9DPP



CoreLine Waterproof

Product details



CoreLine Waterproof WT120C G2
PCU-12DPP

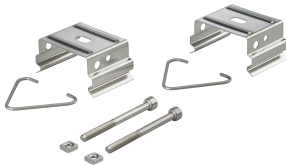

CoreLine Waterproof WT120C G2
PCU-2DPP

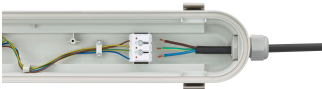

CoreLine Waterproof WT120C G2
PCU-13DPP



CoreLine Waterproof WT120C G2
PCU-8DPP



CoreLine Waterproof WT120C G2
PCU-11DPP



CoreLine waterproof G2 (WT120C
G2),Emergency lighting, TrustSight

CoreLine Waterproof

Application conditions	
Ambient temperature range	0 to +25 °C
Suitable for random switching	Not applicable
Approval and application	
Mech. impact protection code	IK08
Ingress protection code	IP65
Operating and electrical	
Input Voltage	220 to 240 V
General information	
CE mark	CE mark
Protection class IEC	Safety class I (I)
Driver included	Yes
Emergency lighting	EL3
ENEC mark	ENEC mark
Flammability mark	D
Glow-wire test	850/30
Lamp family code	LED40S
Light source replaceable	No
Number of gear units	1 unit
Optic type	WB
Product family code	WT130C
Initial performance (IEC compliant)	
Initial chromaticity	(0.38,0.38)SDCM<=3
Init. Corr. Colour Temperature	4000 K
Init. Colour rendering index	>80
Initial luminous flux	4000 lm
Luminous flux tolerance	+/-10%
Light technical	
Flickering	1
Stroboscopic effect	1.6
Mechanical and housing	
Colour	Grey
Over time performance (IEC compliant)	
Driver failure rate at 5,000 hours	0.13 %

Application conditions

Order Code	Full Product Name	Maximum dimming level
910505100054	WT120C G2 LED40S/840 PSU ELB3 L1200	Not applicable
910505100057	WT120C G2 LED40S/840 PSD ELB3 L1200	1%

Controls and dimming

Order Code	Full Product Name	Dimmable
910505100054	WT120C G2 LED40S/840 PSU ELB3 L1200	No

Order Code	Full Product Name	Dimmable
910505100057	WT120C G2 LED40S/840 PSD ELB3 L1200	Yes

Initial performance (IEC compliant)

Order Code	Full Product Name	Initial LED luminaire efficacy	Initial input power
910505100054	WT120C G2 LED40S/840 PSU ELB3 L1200	118 lm/W	34 W

CoreLine Waterproof

Order Code	Full Product Name	Initial LED luminaire efficacy	Initial input power
910505100057	WT120C G2 LED40S/840 PSD ELB3 L1200	114 lm/W	35 W

