



# MSD Platinum – The power to light your creativity

## MSD Platinum (Touring/Stage)

The MSD Platinum lamps open up new levels of creative freedom in entertainment lighting, with powerful, compact and brilliantly intense light. Their compact, lightweight design provides the freedom to create smaller, lighter luminaires – for use at any location on stage. And their short arc, high color temperature and innovative reflector produce a sparkling, high beam intensity for outstanding color reproduction. They also offer long and reliable lifetime, high efficacy and fast replacement times. It all adds up to an intensely exciting creative experience.

### Vorteile

- High beam intensity
- Freedom to create smaller and lighter fixtures
- High perceived brightness
- A long and reliable performance

### Merkmale

- Very short arc
- Compact system
- High correlated color temperature
- Philips Platinum technology

### Anwendung

- Events
- Shows/Theater
- Tourneen/Bühne

# MSD Platinum (Touring/Stage)

## Versions



## Abmessungsskizzen

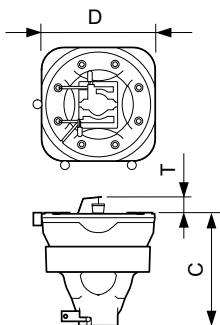
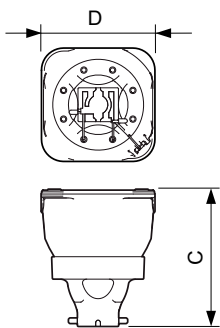

Product	D (max)	O	C (max)
MSD Platinum 25 R 1CT/8	54 mm	1.4 mm	60 mm
MSD Platinum 21 R 1CT/8	54 mm	1.2 mm	60 mm

Product	D (max)	T (max)	O	C (max)
MSD Platinum 11 R 1CT/8	51.5 mm	10 mm	0.95 mm	53 mm

# MSD Platinum (Touring/Stage)

## Abmessungsskizzen

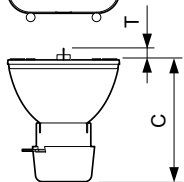
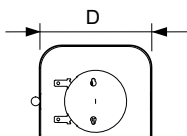
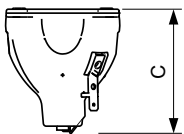
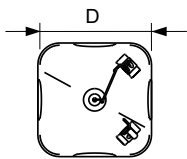
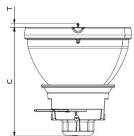
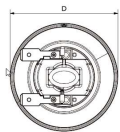

Product	D (max)	O	C (max)	T
MSD Platinum 200 Flex 1CT/8	56.5 mm	0.8 mm	60 mm	7 mm

Product	D (max)	O	C (max)
MSD Platinum 16 R 1CT/8	58.5 mm	1.3 mm	66.4 mm
MSD Platinum 15 R 1CT/8	58.5 mm	1.3 mm	66.4 mm

Product	D (max)	T (max)	O	C (max)
MSD Platinum 5 R 1CT/8	51.4 mm	6.8 mm	1.0 mm	57.1 mm

Dimmen	
Dimmbar	Ja
Allgemeine Eigenschaften	
Betriebsstellung	UNIVERSAL
Lichttechnische Daten	
Farbcode	2

## Elektrische Kenndaten

Order Code	Full Product Name	Spannung (max.)	Spannung (min.)	Nennleistung (nom.)
93070200	MSD Platinum 5 R 1CT/8	-	-	189 W

Order Code	Full Product Name	Spannung (max.)	Spannung (min.)	Nennleistung (nom.)
13535700	MSD Platinum 15 R 1CT/8	-	-	300 W

## MSD Platinum (Touring/Stage)

Order Code	Full Product Name	Spannung (max.)	Spannung (min.)	Nennleistung (nom.)
70438600	MSD Platinum 16 R 1CT/8	-	-	330 W
53976700	MSD Platinum 11 R 1CT/8	80 V	55 V	250 W
67826800	MSD Platinum 21 R 1CT/8	-	-	470 W

Order Code	Full Product Name	Spannung (max.)	Spannung (min.)	Nennleistung (nom.)
80813900	MSD Platinum 200 Flex 1CT/8	-	55 V	240 W
61403400	MSD Platinum 25 R 1CT/8	115 V	85 V	550 W

### Allgemeine Eigenschaften

Order Code	Full Product Name	Sockel	Lebensdauer			Hauptanwendungsgebiet	Systembeschreibung	Order Code	Full Product Name	Sockel	Lebensdauer				
			bis 50 % Ausfall (nom.)								bis 50 % Ausfall (nom.)				
93070200	MSD Platinum 5 R 1CT/8	-	3000 h			Stage/Touring	Reflector-E20.6	11 R 1CT/8							
13535700	MSD Platinum 15 R 1CT/8	-	2000 h			Stage/Touring	na	67826800	MSD Platinum 21 R 1CT/8	-	1500 h			Stage/Touring	-
70438600	MSD Platinum 16 R 1CT/8	-	1500 h			Stage/Touring	Reflector E21.9 TCM	80813900	MSD Platinum 200 Flex 1CT/8	-	2000 h			-	-
53976700	MSD Platinum	-	2000 h			Stage/Touring	Reflector-E20.9	61403400	MSD Platinum 25 R 1CT/8	-	1500 h			Stage/Touring	-

### Lichttechnische Daten

Order Code	Full Product Name	Ähnlichste Farbtemperatur (nom.)	Farbwiedergabeindex (nom.)	Lichtstrom	
				(min.)	(nom.)
93070200	MSD Platinum 5 R 1CT/8	8000 K	-	7100 lm	7950 lm
13535700	MSD Platinum 15 R 1CT/8	8000 K	-	11000 lm	13500 lm
70438600	MSD Platinum 16 R 1CT/8	8000 K	-	14300 lm	16000 lm
53976700	MSD Platinum	7800 K	-	-	12000 lm

Order Code	Full Product Name	Ähnlichste Farbtemperatur (nom.)	Farbwiedergabeindex (nom.)	Lichtstrom	
				(min.)	(nom.)
	11 R 1CT/8				
67826800	MSD Platinum 21 R 1CT/8	8000 K	-	14100 lm	15600 lm
80813900	MSD Platinum 200 Flex 1CT/8	7800 K	-	-	12000 lm
61403400	MSD Platinum 25 R 1CT/8	8000 K	-	22100 lm	24500 lm

## MSD Platinum (Touring/Stage)

