

Simple, robust magnetic ballast

HID-Basic ballasts for HPL and HPI(PLUS) lamps

The HID-Basic ballast is an impregnated (HID standard) electromagnetic ballast for HID lamps, for use in combination with an external ignitor.

Benefits

- Limited volume of ballast coil; also lightweight
- Simple installation and cabling

Features

- Orthocyclic winding process
- Ballasts equipped with screw terminal blocks as standard
- Earthing-while-mounting facility (HID Standard ballasts)
- Low wattage losses

Application

- For built-in applications for road and public lighting with HPL, HPI and HPI (Plus) lamps
- HID-Basic ballasts should be restricted to built-in situations where relative humidity is limited.

HID-Basic ballasts for HPL and HPI(PLUS) lamps

Versions



Dimensional drawing

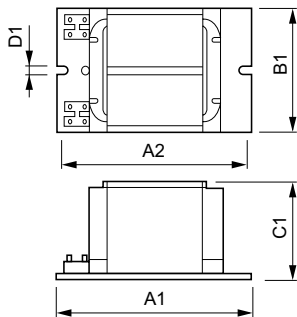

Product	D1	C1	A1	A2	B1
BHLE 400L 202	6.2 mm	64.5 mm	165.0 mm	144.0 mm	75.5 mm
BHLE 250L 202	6.2 mm	64.5 mm	132.5 mm	119.0 mm	75.5 mm
BHL 400L 202	6.3 mm	64.5 mm	150.0 mm	134.0 mm	75.5 mm
BHL 250L 202	6.3 mm	64.5 mm	125.0 mm	104.0 mm	72.5 mm

Operating and Electrical

Input Frequency	50 Hz
Input Voltage	230 V

System characteristics

Order Code	Full Product Name	Rated Ballast-Lamp Power
03125530	BHL 250L 202	250 W
03127930	BHL 400 L202	400 W

Order Code	Full Product Name	Rated Ballast-Lamp Power
84179400	BHL E 250 L202	250 W
84180000	BHL E 400 L202	400 W

