

Simple, robust magnetic ballast

HID-Basic Semi-Parallel ballasts for MHN/CDM lamps

The HID Basic Semi-Parallel ballast is an impregnated (HID standard) electromagnetic copper/iron ballast for use with an external ignitor for metal-halide and CDM lamps.

Benefits

- Limited volume of ballast coil; also lightweight
- Simple installation and cabling

Features

- Orthocyclic winding process
- Ballasts equipped with screw terminal blocks as standard
- Earthing-while-mounting facility (HID Standard ballasts)
- Low watt losses

Application

- For use with MHN/CDM lamps in retail, lobby and city beautification applications
- HID-Basic ballasts should be restricted to built-in situations where relative humidity is limited.

HID-Basic Semi-Parallel ballasts for MHN/CDM lamps

Versions

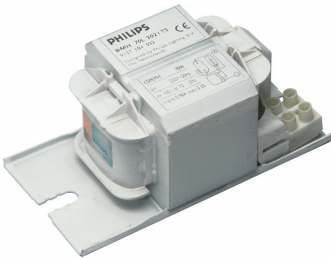

GPFR BCMH

Dimensional drawing

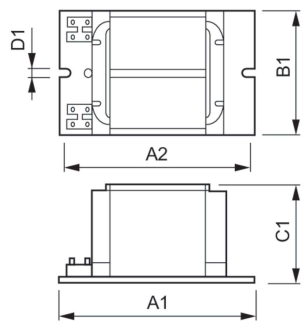

Product	D1	C1	A1	A2	B1
BMH 70L 300I TS	6.2 mm	51.5 mm	117.0 mm	102.0 mm	57.1 mm

