



Energy saving without compromise

GreenPerform Troffer

GreenPerform troffer improves the compact design of the last generation with performance improvement and more variants for different markets. Integrating with all available system: POE, InterAct office wireless, InterAct Office Pro, ActiLume controller, GreenPerform troffer offers additional energy saving and connected features.

Benefits

- Upgrade to smart office with more options
- Energy saving
- Slim housing
- Comfortable light
- Good light quality
- Office compliant
- Reliable performance

Features

- Compatible with all available Philips systems
- Efficacy up to 125lm/W
- Slim design with height less than 46mm
- Improved optical design without zebra effect
- CRI > 80, SDCM<4, Flicker free
- UGR 19 available
- Lifetime L70 50,000 hours

Application

- Open Office
- Public Area
- Meeting Room
- Training Room

Specifications

Ceiling type	T-bar ceiling
Mains Voltage	220-240V / 50-60Hz
Dimming	PSU: non-dimmable
	PSD: Dimmable via Dali-broadcasting
	WIA: Wireless control, compatible with Interact
	SIA: Wireless control, compatible with Interact and with SNS210 sensor
Control system input	Dali

Lumen maintenance at median useful life	L70B50
50.000h	
Correlated color temperature - CCT	840
865	
UGR	19 is available through certain types
Installation	Recessed

Versions



GreenPerform Troffer RC100B 30x120

Dimensional drawing

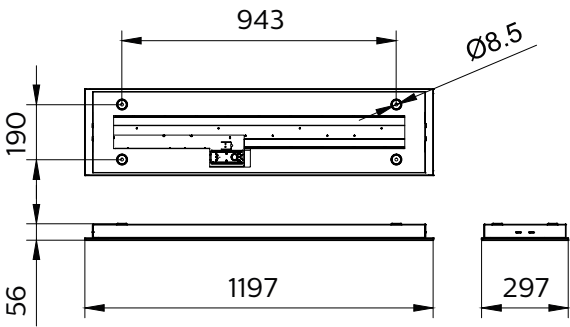

General Information

CE mark	CE mark
Driver included	Yes
Flammability mark	For mounting on normally flammable surfaces
Glow-wire test	Temperature 600 °C, duration 30 s
Light source replaceable	No
Number of gear units	1 unit

Light Technical

Correlated Color Temperature (Nom)	4000 K
Optical cover type	Variable linear-lens array in polycarbonate cover
Color rendering index (CRI)	80
Luminous Efficacy (rated) (Nom)	116 lm/W
Luminous Flux	3,700 lm

Operating and Electrical

Input Voltage	220 to 240 V
Line Frequency	50 to 60 Hz
Power Consumption	32 W

Temperature

Ambient temperature range	-20 to +40 °C
---------------------------	---------------

Mechanical and Housing

Housing Color	White
---------------	-------

Approval and Application

Protection class IEC	Safety class I
Mech. impact protection code	IK03
Ingress protection code	IP20

Initial Performance (IEC Compliant)

Initial chromaticity	SDCM<4
Luminous flux tolerance	+/-10%

Application Conditions

Suitable for random switching	No
-------------------------------	----

Controls and Dimming

Order Code	Full Product Name	Dimmable
911401519451	SM100C LED37S 840 W30L120 PSU G3	No
911401519551	SM100C LED37S 840 W30L120 PSD G3	Yes

