

**READ AND UNDERSTAND THESE INSTRUCTIONS  
BEFORE INSTALLING LUMINAIRE.**

This luminaire is intended for installation in accordance with the National Electrical Code and local regulations. To assure full compliance with local codes and regulations, check with your local electrical inspector before installation. To prevent electric shock, turn off electricity at main power supply before proceeding.

**Retain these instructions for maintenance reference.**

**INSTRUCTION SHEET NO.**

**IS:1101FR**

**Page 1 of 1**

**INSTALLATION PROCEDURE FOR:**

**Lytecaster® 1101FR and 1001FR Series Remodeler Frame-In Kits**

**CAUTION: (RISK OF FIRE) THIS IS A NON-IC RATED FRAME-IN KIT.**

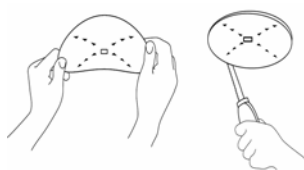
**DO NOT INSTALL INSULATION ABOVE OR WITHIN 3 INCHES (76mm) OF ANY PART OF LUMINAIRE.**

**CAUTION: USE ONLY WITH REFLECTOR TRIMS PROVIDED BY LIGHTOLIER. USE OF OTHER MANUFACTURER'S TRIMS MAY VOID THE UNDERWRITERS LABORATORIES LISTING AND COULD CONSTITUTE A FIRE HAZARD.**

**CAUTION: BEFORE INSTALLING FRAME-IN KIT AND REFLECTOR TRIM, READ ALL MARKINGS ON FRAME-IN KIT AND REFLECTOR TO DETERMINE LAMP WATTAGE AND TYPE APPLICABLE FOR YOUR INSTALLATION.**

**INSTALLATION INSTRUCTIONS**

- 1 PREPARATION:** Cut appropriately sized hole in ceiling at the position desired using the aperture sticker provided as a template. Cut to the outside edge of the sticker (Figure A).



**Figure A**

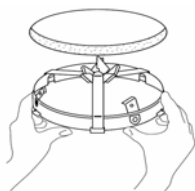
APERTURE HOLE SIZE	
<b>1101FR SERIES</b>	<b>7-1/8" (181mm) DIA.</b>
<b>1001FR SERIES</b>	<b>5-1/2" (140mm) DIA.</b>

- 2 WIRE-IN:** Wire-in and push J-Box through ceiling opening before attaching Mounting Ring (see note below). Open appropriately sized and positioned knock out in the J-Box based on your supply wire style and feed direction. Secure feed wire to J-Box in accordance with local and national codes. Wire luminaire to supply leads using wire nuts (local hardware item). Place all electrical connections in the J-Box and close the J-Box cover.

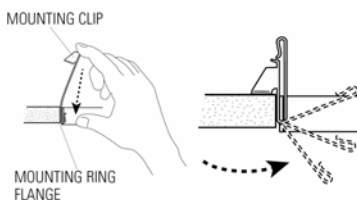
- White Luminaire Lead to Neutral Supply Lead
- Black Luminaire Lead to Hot (120v or 277v) Supply Lead
- Bare Luminaire Lead to Ground Supply Lead

NOTE: When installing 1101FR Series Remodeler Kits it is possible to attach the Mounting Ring (see below) first, then hang the J-Box temporarily from the ring to assist wire-in.

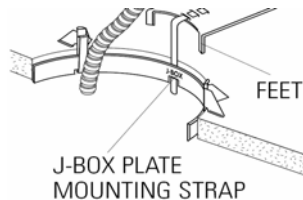
- 3 ATTACH MOUNTING RING:** Push Mounting Ring into opening until flange sits against ceiling (Figure B) making sure "J-Box" Slot is in a position that will ensure enough space above ceiling for the "J-Box" to sit flat against ceiling (see step 4). Slide mounting straps down to trap ceiling thickness, then bend up to secure (Figure C).
- 4 ATTACH J-BOX:** Insert J-Box Mounting Strap between the ceiling material and the Mounting Ring and through the "J-Box" Slot identified on the Mounting Ring. Pull the Strap until the J-Box Plate sits flat on the ceiling with the feet over the edge of the ceiling thickness (Figure D). Bend the J-Box Mounting Strap upwards to secure. Make sure the J-Box Plate is securely attached to the ceiling and the J-Box is in the position shown (Figure E).



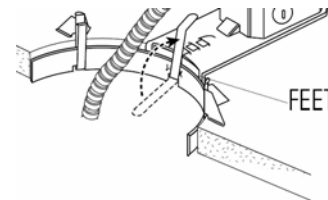
**Figure B**



**Figure C**

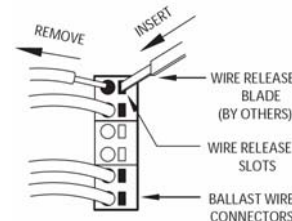


**Figure D**



**Figure E**

- \* BALLAST REPLACEMENT:** Ballast replacement must be performed by a "qualified electrician". **TURN OFF POWER.** Remove reflector trim from luminaire. Remove the J-Box from the Mounting Ring by reversing step 4 above. Pass the J-Box through the aperture. Remove J-Box cover to which the ballast is mounted by lifting the spring. Disconnect all input wiring to the ballast. Release all wires from ballast wire connectors by inserting small blade tool, with insulated handle, into wire release slots (Figure F). Remove ballast from j-box door and replace with new ballast. Rewire and reassemble.



**Figure F**

- \* REFLECTOR TRIM INSTALLATION:** See separate Trim Instruction Sheet for installation procedure.

**PHILIPS  
LIGHTOLIER**

Philips Lighting North America Corporation  
200 Franklin Square Drive  
Somerset, NJ 08873, USA  
Phone: 855-486-2216

Philips Lighting Canada Ltd.  
281 Hillmount Road  
Markham ON, Canada L6C 2S3  
Phone: 800-668-9008