

# PHILIPS LIGHTOLIER

## Downlighting

### LyteCaster

5" Round downlight,  
DimTone,  
700 lumens



Project: \_\_\_\_\_  
Location: \_\_\_\_\_  
Cat.No: \_\_\_\_\_  
Type: \_\_\_\_\_  
Lamps: \_\_\_\_\_ Qty: \_\_\_\_\_  
Notes: \_\_\_\_\_

Philips Lightolier LyteCaster LED Downlights with DimTone, a warm dimming effect from 2700K-2200K, provide an alternative to a BR30 65W incandescent luminaire. The 3.5" luminaire height conserves plenum space without compromising the 70° physical and reflected cutoff.

**Complete product = Frame-in kit + Light engine + Trim** Order each separately

#### Ordering guide: Frame-In kit

Example: L5RAEWG1

Series	Lumens	Frame type	Dimming	Input voltage
<b>L5R</b>			<b>EWG</b>	<b>1</b>
L5R LyteCaster 5" Round	blank 700	A AirSeal IC, New Construction, Screw AN AirSeal IC, New Construction, Nail	EWG ELV/Triac DimTone	1 120V
	07 700	R AirSeal IC, Remodeler		

#### Ordering guide: Light engine

Example: L5R078WG

Series	Lumens	CRI	CCT
<b>L5R</b>	<b>07</b>	<b>8</b>	<b>WG</b>
L5R LyteCaster 5" Round	07 700	8 80	WG 2700-2200K

#### Ordering guide: Trim

Example: L5RDW

Series	Luminaire type	Finish
<b>L5R</b>		
L5R LyteCaster 5" Round	D Open Downlight	D Clear diffuse (with white flange) W White (with white flange)
	B Baffle Downlight	W White (with white flange)

# L5R LyteCaster 5" Round with DimTone

General purpose downlight, 700 lumens

## New construction frame-in kit

Bottom view

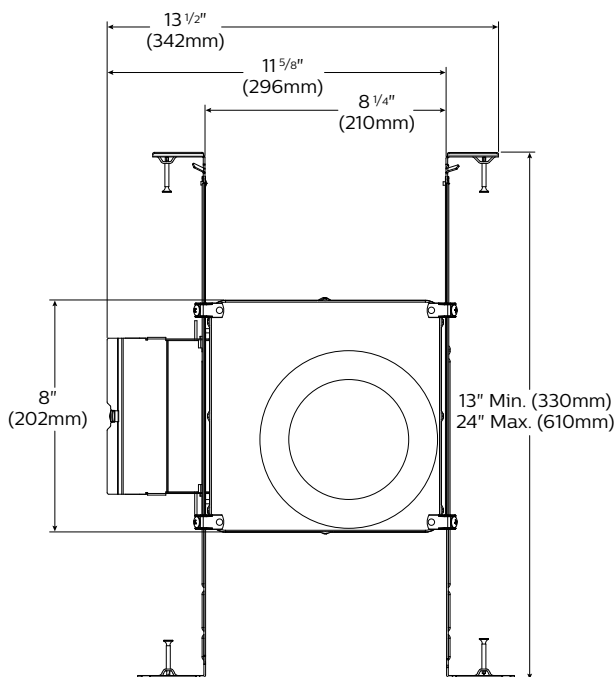

Side view

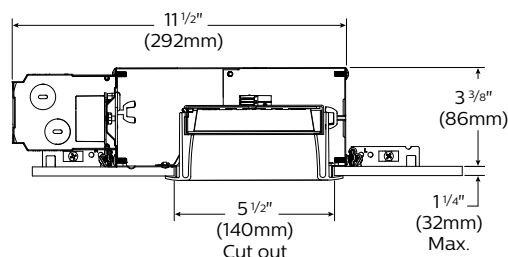

Downlight trim

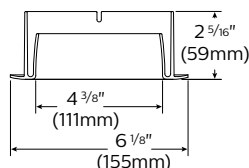

Light engine

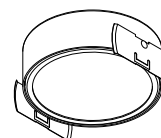

## Features

- Housing:** .026" galvanized steel. UL listed for direct contact with thermal insulation. Airseal® housing minimizes air leakage to less than 2 CFM at 1.57PSF (or 75PA), which complies with Title 24, the International Energy Conservation Code, and Washington State Energy Code (Section 502.4). This reduces heat loss and condensation in ceiling. Access door for inspection of junction box.
- Lower frame and top cover:** .026" galvanized steel. Accommodates ceilings up to 1 1/4" (32mm) thick. 3/8" (9.5mm) deep integral lip with four notches at 90° apart to simplify alignment. Locks into position along length of mounting bars with locking screws.
- Junction Box:** 2.5" X 5 3/8" X 2" (27 cu. in) .032" galvanized steel. UL listed 90° supply conductors. Rated for branch circuit wiring supplying connected luminaires (daisy chaining).
- Retaining clips:** Permit easy and fast installation of light engine/trim.
- Mounting bars:** .059" galvanized steel. Bars pivot for easy attachment and wire-in below ceiling line. Bars extend to accommodate 16" (406mm) to 24" (610mm) O.C. joist spacing. Bars can accommodate 12" (305mm) O.C. joist spacing after a slight field modification (see Instruction sheet). Features integral self tapping phillips/square drive screws for secure attachment to wood or metal construction. Also available with integral nails. Attaches to T-bar ceilings without the need of accessories. Bars installed on shortest dimension of frame, but can be easily repositioned 90 degrees from original position.

- Driver:** ELV / Triac: 120V, 50/60Hz. RoHS compliant, Class 2 power supply. Complies with FCC rules per Title 47 Part 15 (Class B) for EMI / RFI (conducted & radiated). Class A sound rating.
- Ceiling cutout:** 5 1/2" (140mm).

## Options and Accessories

For fire rated box accessory, use Fireline:

16FR2X10	16" on center 2x10 construction
16FR2X6	16" on center 2x6 construction

See Fireline spec sheets for more information.

## Electrical

**Lifetime:** Expected lifetime 50,000 hours and backed by a 5-year warranty. (see Philips.com/warranties for details)

## Recommended dimmers

See LED-DIM Specification Sheet.

## Labels

cULus Listed Type I.C., frames are suitable for damp location. Trims are cULus suitable for wet location (no shower lens unit required). Complies with Air Leakage.

# L5R LyteCaster 5" Round with DimTone

General purpose downlight, 700 lumens

## Remodeler kit

### Bottom view

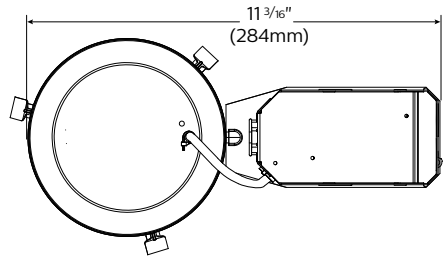

### Side view

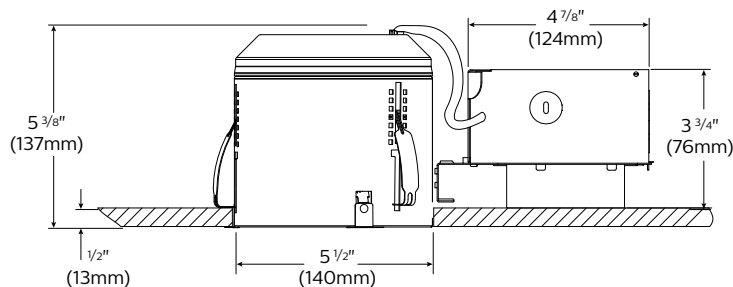

## Features

1. **Housing:** .032 Aluminum. UL listed for direct contact with thermal insulation. Integral retaining spring secures housing to ceilings up to 2" thick. Removable for access to junction box and ceiling plenum. 5 1/2" maximum for use in 2" x 6" joist construction and shallow plenum applications. Airseal® housing minimizes air leakage to less than 2 CFM at 1.57PSF (or 75PA), which complies with Title 24, the International Energy Conservation Code, and Washington State Energy Code (Section 502.4). This reduces heat loss and condensation in ceiling
2. **Junction Box:** 2 1/2" x 2 1/2" x 4 7/8" (29 cu in.) .031" galvanized steel. UL listed for 90°C supply conductors. Rated for branch circuit wiring supplying connected fixtures.
3. **Retaining clips:** Permit easy and fast installation of light engine/trim.
4. **Driver:** ELV /Triac: 120V, 50/60Hz. RoHS compliant, Class 2 power supply. Complies with FCC rules per Title 47 Part 15 (Class B) for EMI/RFI (conducted & radiated). Class A sound rating.
5. **Ceiling cutout:** 5 1/2" (140mm).

## Electrical

**Lifetime:** Expected lifetime 50,000 hours and backed by a 5-year warranty. (see Philips.com/warranties for details)

## Recommended dimmers

See LED-DIM Specification Sheet.

## Labels

cULus Listed Type I.C., frames are suitable for damp location. Trims are cULus suitable for wet location (no shower lens unit required). Complies with Air Leakage.

# L5R LyteCaster 5" Round with DimTone

General purpose downlight, 700 lumens

Reflector: Round downlight

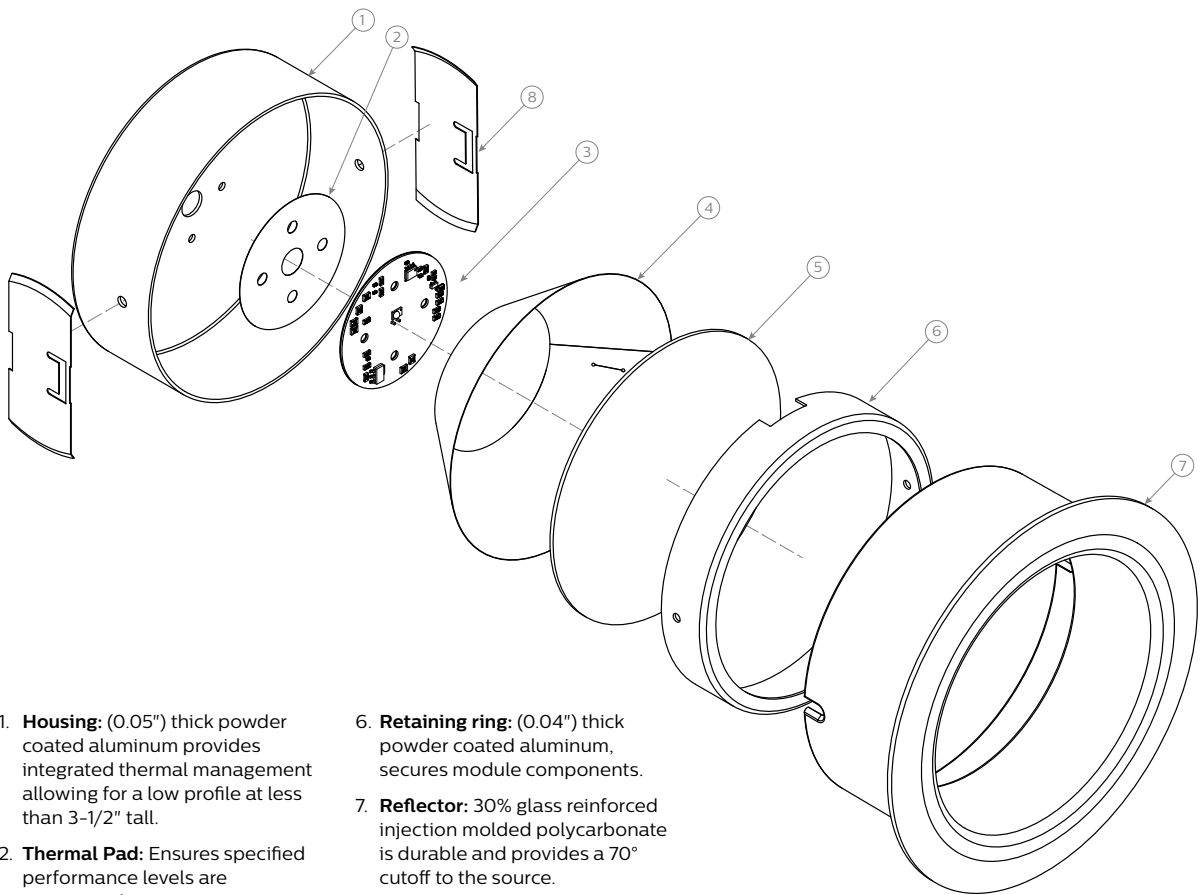

- 1. Housing:** (0.05") thick powder coated aluminum provides integrated thermal management allowing for a low profile at less than 3-1/2" tall.
- 2. Thermal Pad:** Ensures specified performance levels are maintained.
- 3. LED board:** Transitions from 2700K to 2200K at full dim level.
- 4. Mixing chamber:** 98% reflective, highly diffuse film.
- 5. Diffusion lens:** (0.06") thick acrylic frosted lens, balances light transmission and an even source of illumination.
- 6. Retaining ring:** (0.04") thick powder coated aluminum, secures module components.
- 7. Reflector:** 30% glass reinforced injection molded polycarbonate is durable and provides a 70° cutoff to the source.
- 8. Retaining clips:** 29 gauge Stainless Steel, allows tool-less installation of light engine to trim.

## Electrical

Screw / Nail Frame-in kit	Input volts	Input freq.	Input current	LED drive current	Input power	LED power	THD factor	Power factor
L5RAEWG1	120V	60Hz	0.11A	450mA	13W	10W	<20%	>0.9

# L5R LyteCaster 5" Round with DimTone

General purpose downlight, 700 lumens

80 CRI, 700 lumens

## Candela Curves

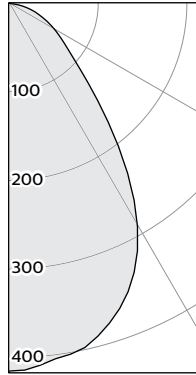

Frame: L5RAEWG1  
Light engine: L5R078WG  
Trim: L5RDW

Output lumens: 694.5lm  
Input Watts: 12.2W  
Spacing Criterion: 1.1

Angle	Mean CP	Lumens
0	414	
5	409	39
10	401	
15	388	109
20	366	
25	334	153
30	290	
35	234	145
40	174	
45	127	99
50	95	
55	75	68
60	61	
65	48	48
70	36	
75	26	27
80	16	
85	6	7
90	0	

## Single unit data

Height to Lighted Plane	Initial Center Beam Foot-Candles	Beam Dia. (ft)*
5'	17	5.5'
6'	12	6.6'
7'	8	7.7'
8'	6	8.8'
9'	5	9.9'

\* Beam diameter is where foot-candles drop to 50% of maximum.

## Multiple unit data - RCR 2

Spacing on center	Initial Center Beam Foot-Candles	Watts per Sq. Ft.
5'	29.5	0.54
6'	19.3	0.35
7'	13.8	0.25
8'	11.5	0.21
9'	9.2	0.17

38'x38'x10' Room, Workplane 2.5' above floor, 80/50/20% Reflectances

## Coefficients of utilization

Ceiling	80%				70%		50%		30%		0%
Wall	70	50	30	10	50	10	50	10	50	10	0
RCR	Zonal cavity method - Effective floor reflectance = 20%										
Room Cavity Ratio	0	119	119	119	116	116	111	111	106	106	100
1	111	107	103	100	105	98	100	95	97	93	88
2	103	96	90	85	94	84	90	82	87	81	77
3	95	86	79	74	85	73	82	72	79	71	68
4	88	78	71	65	77	64	75	64	72	63	60
5	82	71	63	58	70	57	68	57	66	56	54
6	77	65	57	52	64	52	63	51	61	51	49
7	72	60	52	47	59	47	58	47	57	46	44
8	68	56	48	43	55	43	54	42	53	42	40
9	64	52	44	39	51	39	50	39	49	39	37
10	60	48	41	36	48	36	47	36	46	36	34

## Zonal lumens & percentages

Zone	Lumens	%Luminaire
0-30	300	43.2%
0-40	445	64.1%
0-60	613	88.2%
0-90	695	100.0%

1. Wattage: controlled to within  $\pm 5\%$
2. Correlated Color Temperature: within specs as defined in ANSI\_NEMA\_ANSI C78.377-2008: Specifications for the Chromaticity of Solid State Lighting Products.
3. Tested using absolute photometry as specified in LM79: IESNA Approved Method for the Electrical and Photometric Measurements of Solid-State Lighting Products.

© 2016 Philips Lighting Holding B.V. All rights reserved.  
Philips reserves the right to make changes in specifications and/or to discontinue any product at any time without notice or obligation and will not be liable for any consequences resulting from the use of this publication.  
[philips.com/luminaires](http://philips.com/luminaires)



Philips Lighting North America Corporation  
200 Franklin Square Drive, Somerset, NJ 08873  
Tel. 855-486-2216

Philips Lighting Canada Ltd.  
281 Hillmount Rd, Markham, ON, Canada L6C 2S3  
Tel. 800-668-9008