

READ AND UNDERSTAND THESE INSTRUCTIONS BEFORE INSTALLING LUMINAIRE

This luminaire is intended for installation in accordance with the National Electrical Code and local regulations. To assure full compliance with local codes and regulations, check with your local electrical inspector before installation. To prevent electric shock, turn off electricity at fuse box before proceeding.

Retain these instructions for maintenance reference.

INSTRUCTION SHEET NO.

IS: 9276

A1200

INSTRUCTION SHEET NO.

IS: 9276

A1200 Page 1 of 3

READ AND UNDERSTAND THESE INSTRUCTIONS BEFORE INSTALLING LUMINAIRE

This luminaire is intended for installation in accordance with the National Electrical Code and local regulations. To assure full compliance with local codes and regulations, check with your local electrical inspector before installation. To prevent electric shock, turn off electricity at fuse box before proceeding.

Retain these instructions for maintenance reference.

INSTRUCTIONS FOR ATTACHING PowerWash™ T5 TO A LYTESPAN® TRACK SYSTEM
FOR USE WITH LYTESPAN TRACK SYSTEMS ONLY

NOTE: Not for use with ProSpec® Track.

INSTRUCTIONS FOR ATTACHING PowerWash T5 TO A SINGLE CIRCUIT LYTESPAN TRACK:

- 1. Turn off power to TRACK.
- 2. Align FULL GROOVE in ADAPTERS with BEAD on TRACK. See Fig. 1 & 2.
- 3. Position LEVERS as shown in Fig. 2.
- 4. Insert ADAPTERS into TRACK as shown in Fig. 2.
- 5. Rotate LEVERS 90° while pushing upward on ADAPTERS to make mechanical and electrical connection. See Fig. 3.

To Remove or change luminaire location on the TRACK, reverse procedure #5 above.

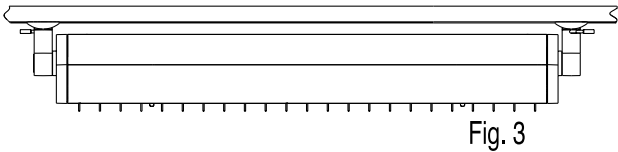
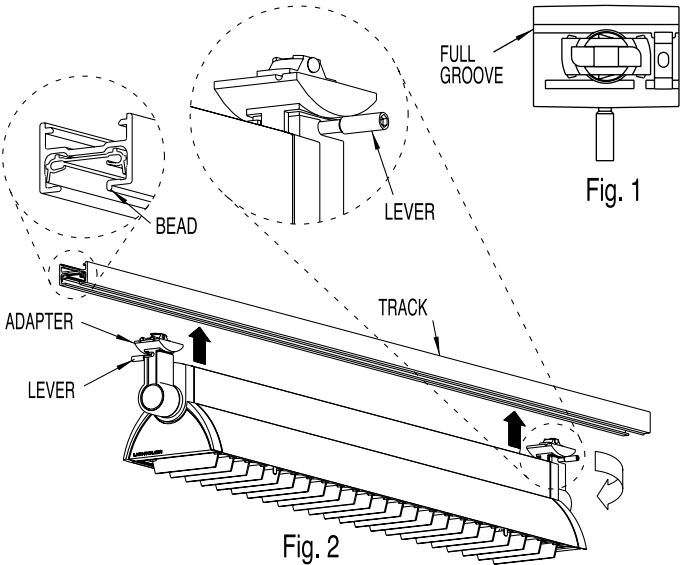

INSTRUCTIONS FOR CONVERTING PowerWash T5 ATTACHMENT FITTINGS TO OPERATE ON 2 CIRCUIT ADVENT LYTESPAN TRACK

NOTE: To insure proper operation of PowerWash T5 on Two Circuit Lytespan Track, the BLACK SPACER (provided) must be used at all times on both PLUG ASSEMBLIES. The BLACK SPACER is not used when operating PowerWash T5 on Single Circuit Track.

LOWER CIRCUIT, Fig. 4 & 7:
Illustrates BRASS CONTACT in low position with BLACK SPACER in place for lower circuit. BLACK SPACER should also be used on adapter without contacts for both LOWER CIRCUIT and UPPER CIRCUIT installations.

UPPER CIRCUIT, Fig. 5, 6, & 7:
To convert attachment fitting for upper circuit, raise BRASS CONTACT to high position by pulling CONTACT as high as stop permits and slipping on BLACK SPACER as shown in Fig. 5 & 6.

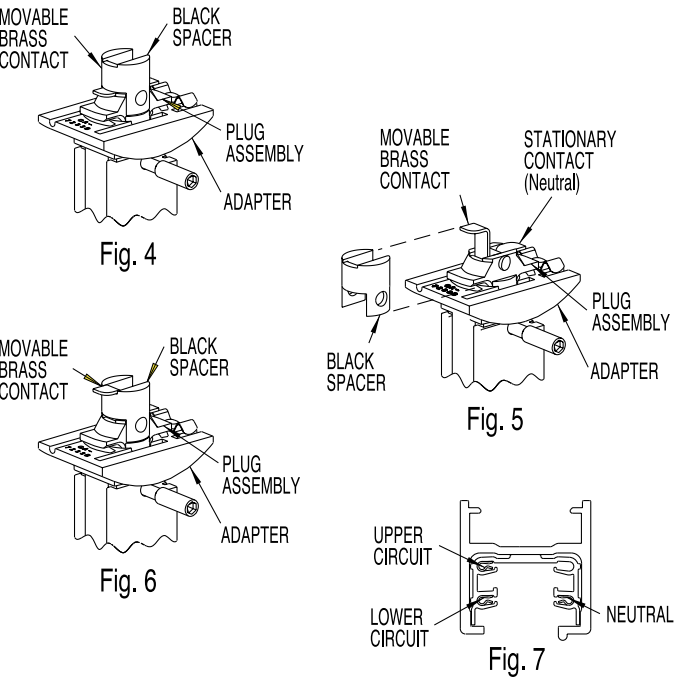

READ AND UNDERSTAND THESE INSTRUCTIONS BEFORE INSTALLING LUMINAIRE

This luminaire is intended for installation in accordance with the National Electrical Code and local regulations. To assure full compliance with local codes and regulations, check with your local electrical inspector before installation. To prevent electric shock, turn off electricity at fuse box before proceeding. Retain these instructions for maintenance reference.

INSTRUCTIONS FOR INSTALLING A PowerWash™ T5 LOUVER

INSTRUCTIONS FOR INSTALLING A PowerWash T5 LOUVER:

1. Turn off power to TRACK.
2. First insert BOTTOM SPRINGS on the LOUVER into the BOTTOM GROOVE in the luminaire (see Fig. 8 & 9).
3. While pushing down TOP SPRING TABS, rotate LOUVER toward the TOP GROOVE in the luminaire until it hits the FRONT STEP on the luminaire. Release the TOP SPRING TABS into the TOP GROOVE (see Fig. 8, 10, & 11).
4. To remove, push down the TOP SPRING TABS and rotate away from the luminaire (see Fig. 10).

NOTE: Ensure that all four LOUVER SPRINGS are fully engaged for safe operation (see Fig. 11).

NOTE: Luminaire may be used without LOUVER if desired.

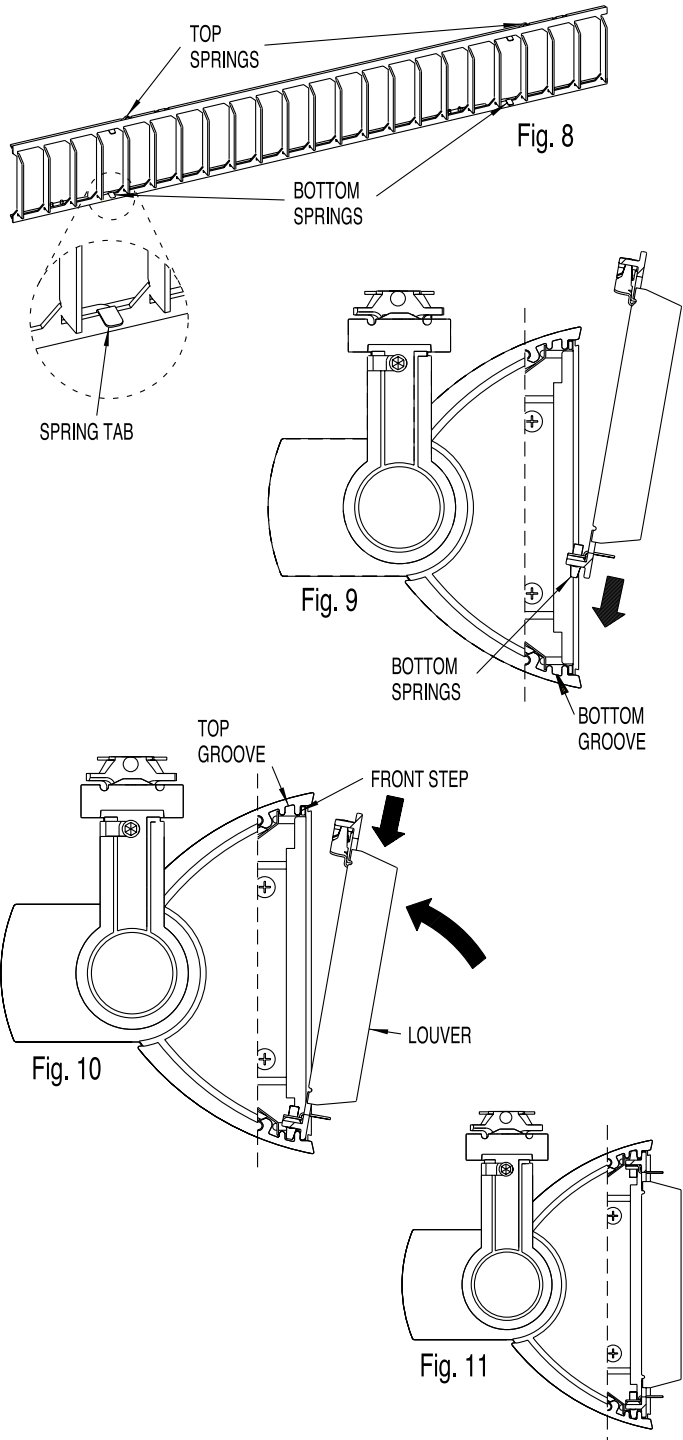

READ AND UNDERSTAND THESE INSTRUCTIONS BEFORE INSTALLING LUMINAIRE

This luminaire is intended for installation in accordance with the National Electrical Code and local regulations. To assure full compliance with local codes and regulations, check with your local electrical inspector before installation. To prevent electric shock, turn off electricity at fuse box before proceeding. Retain these instructions for maintenance reference.

INSTRUCTIONS FOR OPERATING AND LAMPING A PowerWash™ T5 LUMINAIRE

INSTRUCTIONS FOR LAMPING A PowerWash T5 LUMINAIRE:

WARNING: USE PROPER WATTAGE T5 HIGH OUTPUT LAMPS ONLY. SEE LABEL ON LUMINAIRE FOR PROPER WATTAGE.

1. Turn off power to TRACK.
2. Remove LOUVER (see Page 2).
3. Slide out both SOCKET BRACKETS (see Fig. 12). No tools required. Pull with hands.
4. Insert LAMP into SOCKET and rotate LAMP 90° locking it in place.
5. For two LAMP luminaire, repeat step 4 for the second LAMP.
6. Push SOCKET BRACKETS back into their original position (see Fig. 13).
7. To remove LAMP, repeat steps 1-3. Rotate LAMP(s) 90° and remove from SOCKET.

NOTE: A two lamp luminaire will not operate with only one lamp. Assure that both lamps are properly installed. Also, both lamps will extinguish when one fails.

AIMING INSTRUCTIONS (see Fig. 14):

CAUTION: ALLOW TIME FOR LUMINAIRE TO COOL BEFORE MAKING ANY ADJUSTMENTS!

Rotate HEAD of luminaire to desired position.

