

HADCO

by @signify

Landscape

Composite Inground

SL42 CFL/INC/MH/HPS
Inground



Project:

Location:

Cat.No:

Type:

Lamps:

Qty:

Notes:

Restricted Depth Applications

Interior Applications

Landscape Areas

Building Accent

Pedestrian Areas

Driveway Marker

Sign Lighting

SL-42

SL-42-PH

Specifications



IP65



IP67



Certifications

ETL and CETL listed for wet location, direct burial, concrete pour and is also listed for indoor usage. Certified to IP65 and IP67 to ensure protection against the harshest environments. IEC compliant versions available, consult factory.

Lamp/Ballast Housing

Compression molded Rhinolute™ composite material, structurally reinforced with glass fibers. Superior resistance to ultraviolet degradation and corrosion resistant in harsh environments. Trim Rng (TR) and Debris Cover (DC) supplied standard.

Splice Compartment

Supplied with two 3/4" NPT conduit entrances. Connection to ballast compartment by way of anti-wicking chamber. Sealed with gasketed die cast aluminum cover plate. Suitable for through wiring.

Lens

Standard 7/16" clear tempered flat borosilicate glass (F) or ADA anti-slip and walkover clear tempered flat borosilicate glass (ADA). Flat lenses will withstand loads up to 200 PSI. Sealed to housing with high temperature injection molded silicone gasket. Optional linear and radial spread lenses also available.

Lens Frame

Heavy duty die cast bronze lens frame is supplied as standard. Fastened to housing with eight captive 1/4-20 stainless steel allen cap screws.

Reflectors

Spun aluminum highly specular Alzak™ finish for either NEMA type 1, or 2 spot (SPT) or NEMA type 3 or 5 flood (FLD) distributions. Field adjustable up to 25° tilt and +/- 45° horizontal rotation.

Lamp Holder

Porcelain 4kv pulse rated for HID lamp sources.

Options

Cast aluminum Convex Rock Guard (CR), Directional Shield (DS), and Driveway Marker (DM). Internal Hex Cell Louver (HL), Glass Color Filter (GF), Grout Mask (GM), Debris Cover (DC), Die cast bronze Port Hole (PH).

SL42 Composite Inground

CFL/INC/MH/HPS Inground

Finish Housing Black (BK). Options can be painted in standard or custom colors. Powder Coat Standard.

Safety Caution: Care should be taken when specifying fixtures for use in pedestrian walkways to avoid problems that may be caused by high lens temperatures. Consult factory for more information.

Warning Caution: Care should be taken not to install in-ground fixtures in areas where water can stand for prolonged periods of time. Sufficient drainage must be provided to avoid problems. Consult factory for more information.

Product Order Guide

Series	Max Watts	Lamp Type	Voltage ⁸	Optics	Lens		Finish ⁹	Options	
SL-42	Fluorescent								
	26CFT	CFT	120	FL ¹	Fluorescent	F ¹	Clear Flat	BK ⁵ Black	DM ¹ Driveway Marker ^{4,7}
	32CFT ²	CFT	208	FL ¹	Fluorescent	ADA ¹	ADA Walkover	BZ ⁵ Bronze	CR ¹ Convex Rockguard ⁷
	42CFT ²	CFT	240	FL ¹	Fluorescent	LS ¹	Linear Spread	WH ⁵ White	DS ¹ Directional Shield ⁷
			277	SPT ¹	Spot	RS ¹	Radial Spread	GR ⁵ Green	PH ⁶ Porthole
	Metal Halide						NA ⁵ Natural Aluminum	HL Hex Cell Louver	
	39MH	T4	120	MFLD ¹	Flood			GY ⁵ Gray	GF Glass Color Filter
	39MH	T6	120/277	MFLD ¹	Flood			CC ⁵ Custom Color	LFSS Stainless Steel Lens
	20MH	BT5							Frame
	20MH	T4							GM Grout Mask
	20MH	HID-MR16 ¹⁰							IGS ^{1,11} Internal Glare Shield
	39MHmax	Par20 ¹⁰							HPBB Cool Lens
	39MHmax	R111 ¹⁰							
	THESE SELECTIONS PORTHOLE ONLY								
	39MH ³	Par20		PHSPT	Porthole Spot ³				
	70MH ³	T6		PHFLD	Porthole Flood ³				
	70MH ³	T4		PHFL	Porthole Fluorescent ³				
	70MH ³	Par30							
	70MH ³	R111							
	Incandescent								
	75max	MR16 ¹⁰							
	LED ¹²								
	1X5WLED	CUS	120	10,30,45			White (WW - 3050K, DW - 4700K)		

SL42 Composite Inground

CFL/INC/MH/HPS Inground

- ¹ These selections are not available with the PH Porthole option.
² 26 CFT max for Porthole. Comes with wall wash lens on non-Porthole versions.
³ Porthole Only.
⁴ The DM Driveway Marker is limited to MR16 and HID-MR16 flood lamps.
⁵ Powder coat paint standard.
⁶ The PH Porthole option is supplied as standard in sandblasted bronze.
⁷ These options are supplied in heavy wall cast aluminum.
⁸ Consult factory for other voltages.
⁹ Consult factory for other finishes.
¹⁰ Does not require internal optics.
¹¹ The IGS works with the T6, T4 and BT5 lamp types only.
¹² The CUS version uses a 5W Atlas from Lamina.

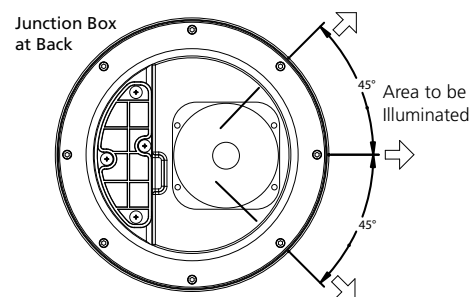

SL-42 Aiming Direction

Note: CFT = triple biax

Example: SL-42-39MH-T6-277-SPT-F-DS-BK

Luminaire Dimensions

Luminaire	A		B		C		D		Weight	
	Inch	mm	Inch	mm	Inch	mm	Inch	mm	lbs.	kg
SL-42-F	12.25	311	0.80	20	5.10	130	N/A	N/A	15	6.8
SL-42-PH	12.25	311	0.80	20	5.10	130	5.50	140	22	10.0
SL-42-DM	14.30	363	0.80	20	5.10	130	2.50	64	23	10.4
SL-42-CR	12.25	311	0.80	20	5.10	130	1.20	30	16	7.3
SL-42-DS	12.25	311	0.80	20	5.10	130	4.20	107	17	7.7

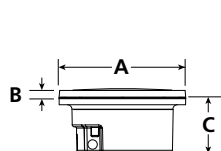

SL-42-F

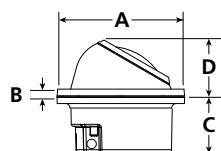

SL-42-PH

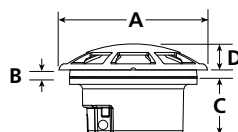

SL-42-DM

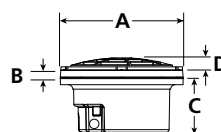

SL-42-CR

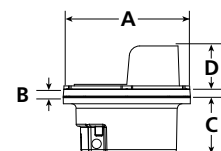

SL-42-DS

©2004-2011 Koninklijke Philips Electronics N.V. All rights reserved.
 ALLSCAPE is a registered trademark of Philips.

Page 21 | V 03-11

Due to a program of continuous improvement, ALLSCAPE reserves the right to make any variation in design or construction to the equipment described.

