



# GreenSpace Accent, elbow

## RS342B LED27S/830 PSU-E MB BK

GreenSpace Accent Elbow - LED Module, system flux 2700 lm - 830 warm white - Power supply unit external (PSU) - Medium beam - Safety class II - Black

Lighting is one of the key assets that can help retailers and building operators achieve their cost targets. Until now, many have been reluctant to switch from CDM to LED technology because the efficiency, initial investment, installation process, light level and/or quality of light of new LED solutions were not on par with their CDM existing solutions. This is no longer the case, thanks to GreenSpace Accent. Now, retailers and building operators can make the switch and enjoy the benefits of Philips PerfectAccent light quality as well as significant energy savings compared to their existing CDM installation – all for a reasonable initial investment. And GreenSpace Accent's regular cut-out makes retrofit installation quick and easy. For food and fashion retailers, GreenSpace Accent elbow is also available with special light recipes to further enhance the store ambiance and to show the produce and goods on offer in the very best light: Fresh Food Champagne is the perfect LED solution for displaying fruit, vegetables, cheese, bread and pastries in a warm lighting ambiance; Fresh Food Meat creates the best light setting for meat enhancement in a cool natural ambiance; CrispWhite is the clear choice for fashion retailers to make colors appear rich and intense while keeping whites bright.

### Product data

General information			
Number of light sources	1 [ 1 pc]	Light source colour	830 warm white
Lamp family code	LED27S [ LED Module, system flux 2700 lm]	Cap base	- [ -]
Beam angle of light source	120 °	Light source replaceable	No
		Number of gear units	1 unit

## GreenSpace Accent, elbow

Gear	-
Driver/power unit/transformer	PSU-E [ Power supply unit external (PSU)]
Driver included	Yes
Optic type	MB [ Medium beam]
Optical cover/lens type	ACC [ Acrylic bowl/cover clear]
Luminaire light beam spread	24°
Control interface	-
Connection	Push-in connector and pull relief
Cable	-
Protection class IEC	Safety class II
Glow-wire test	Temperature 650 °C, duration 30 s
Flammability mark	NO [ -]
CE mark	CE mark
ENEC mark	ENEC mark
UL mark	No
Warranty period	5 years
Remarks	*-Per Lighting Europe guidance paper "Evaluating performance of LED based luminaires - January 2018": statistically there is no relevant difference in lumen maintenance between B50 and for example B10. Therefore the median useful life (B50) value also represents the B10 value.
Constant light output	No
Number of products on MCB	34
RoHS mark	RoHS mark
Product Family Code	RS342B [ GreenSpace Accent Elbow]

### Operating and Electrical

Input voltage	220-240 V
Input frequency	50 to 60 Hz
Inrush current	18.6 A
Inrush time	0.24 ms
Power factor (min.)	0.9

### Controls and Dimming

Dimmable	No
----------	----

### Mechanical and Housing

Housing material	Aluminium
Reflector material	Polycarbonate aluminium coated
Optic material	Polymethyl methacrylate
Optical cover/lens material	Polymethyl methacrylate
Fixation material	Polyamide
Optical cover/lens finish	Clear

Overall length	228 mm
Overall width	193 mm
Overall height	156 mm
Overall diameter	193 mm
Colour	Black

### Approval and Application

Ingress protection code	IP20 [ Finger-protected]
Mech. impact protection code	IK02 [ 0.2 J standard]

### Initial Performance (IEC Compliant)

Initial luminous flux	2700 lm
Luminous flux tolerance	+/-10%
Initial LED luminaire efficacy	114.8936170212766 lm/W
Init. Corr. colour temperature	3000 K
Init. colour rendering index	≥80
Initial chromaticity	(0.43, 0.40) SDCM<3
Initial input power	23.5 W
Power consumption tolerance	+/-10%

### Over Time Performance (IEC Compliant)

Control gear failure rate at median useful life 50000 h	5 %
Lumen maintenance at median useful life* 50000 h	L80

### Application Conditions

Ambient temperature range	+10 to +40 °C
Performance ambient temperature Tq	25 °C
Maximum dimming level	Not applicable
Suitable for random switching	No

### Product Data

Full product code	871869625512400
Order product name	RS342B LED27S/830 PSU-E MB BK
EAN/UPC – product	8718696255124
Order code	25512400
Numerator – quantity per pack	1
Numerator – packs per outer box	1
Material no. (12NC)	910500456524
Net weight (piece)	1.600 kg

# GreenSpace Accent, elbow

## Dimensional drawing

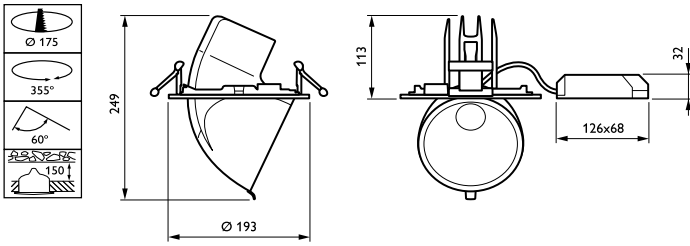

### GreenSpace Accent RS340B-RS343B

## Photometric data

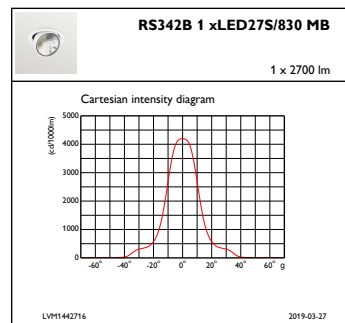
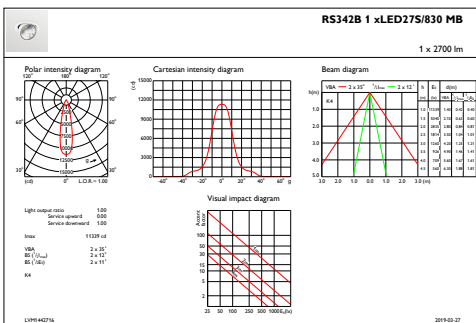

### IFAS1\_RS342B1xLED27S830MB

### IFCC1\_RS342B1xLED27S830MB

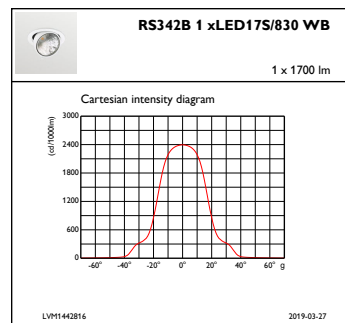
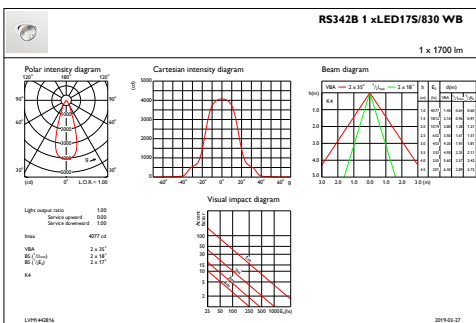

### IFAS1\_RS342B1xLED17S830WB

### IFCC1\_RS342B1xLED17S830WB

## Photometric data

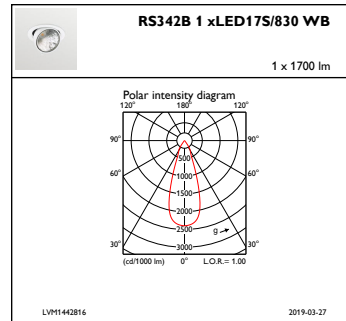
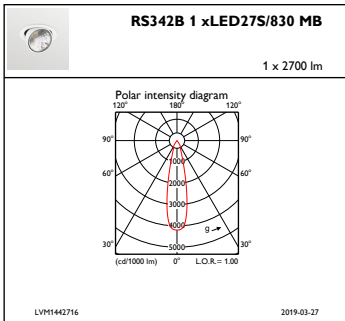

IFPC1\_RS342B1xLED275830MB

IFPC1\_RS342B1xLED175830WB

