



StyliD PremiumWhite

ST740T LED17S/PW930 PSU MB BK

STYLID COMPACT G3 TRACK, LED module, system flux 1700 lm, Premium white with CRI ≥ 90 , Power supply unit, DC compatible for central emergency lighting, Medium beam, Black

If you want a high quality of light and color rendering for your store, without having to compromise on energy savings, then StyliD PremiumWhite is exactly what you are looking for. This exciting solution delivers the same sparkling light effects as CDM conventional lighting. So now you can make the switch to LED with confidence!

Product data

General Information			
Lamp family code	LED17S [LED module, system flux 1700 lm]	ENEC mark	ENEC mark
Light source replaceable	No	Glow-wire test	Temperature 650 °C, duration 30 s
Number of gear units	1 unit	EU RoHS compliant	Yes
Driver included	Yes		
Remarks	*-Per Lighting Europe guidance paper "Evaluating performance of LED based luminaires - January 2018": statistically there is no relevant difference in lumen maintenance between B50 and for example B10. Therefore, the median useful life (B50) value also represents the B10 value.	Light Technical	
Service tag	Yes	Luminous Flux	1,700 lm
Product family code	ST740T [STYLID COMPACT G3 TRACK]	Correlated Color Temperature (Nom)	3000 K
Lighting Technology	LED	Luminous Efficacy (rated) (Nom)	102.40963855421685 lm/W
CE mark	Yes	Color rendering index (CRI)	≥ 90
Warranty period	5 years	Number of light sources	1
Flammability mark	For mounting on normally flammable surfaces	Beam angle of light source	120 degree(s)
		Light source color	Premium white with CRI ≥ 90
		Optic type	Medium beam
		Optical cover type	-
		Luminaire light beam spread	24°
		Operating and Electrical	
		Input Voltage	220 to 240 V

StyliD PremiumWhite

Line Frequency	50 to 60 Hz
Inrush current	14 A
Inrush time	0.25 ms
Power Consumption	16.6 W
Power Factor (Fraction)	0.9
Connection	Push-in connector and pull relief
Cable	-
Number of products on MCB of 16 A type B	24

Temperature

Ambient temperature range	+10 to +40 °C
---------------------------	---------------

Controls and Dimming

Dimmable	No
Driver/power unit/transformer	Power supply unit, DC compatible for central emergency lighting
Constant light output	No

Mechanical and Housing

Housing Material	Metal–Plastic
Reflector material	Polycarbonate aluminum coated
Optic material	Polycarbonate
Optical cover material	Polymethyl methacrylate
Fixation material	-
Housing Color	Black
Optical cover finish	Clear
Overall length	258 mm
Overall width	89 mm
Overall height	179 mm
Dimensions (Height x Width x Depth)	179 x 89 x 258 mm

Approval and Application

Ingress protection code	IP20 [Finger-protected]
Mech. impact protection code	IK02 [0.2 J standard]
Protection class IEC	Safety class II

Initial Performance (IEC Compliant)

Luminous flux tolerance	+/-10%
Initial chromaticity	(0.42, 0.38) SDCM <3
Power consumption tolerance	+/-10%

Over Time Performance (IEC Compliant)

Control gear failure rate at median useful life 50000 h	5 %
Lumen maintenance at median useful life* 50000 h	L80

Application Conditions

Performance ambient temperature Tq	25 °C
Suitable for random switching	Yes

Product Data

Order product name	ST740T LED17S/PW930 PSU MB BK
Full product name	ST740T LED17S/PW930 PSU MB BK
Full product code	871869688447800
Order code	910500458313
Material Nr. (12NC)	910500458313
Numerator - Quantity Per Pack	1
EAN/UPC - Product/Case	8718696884478
Numerator - Packs per outer box	1
EAN/UPC - Case	8718696884478

Dimensional drawing

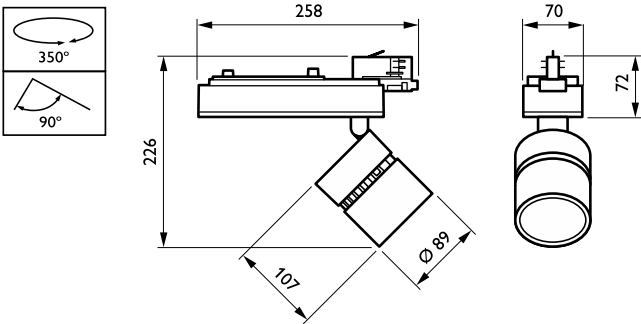

StyliD PremiumWhite

